

# ALISHA THER

---

Architectural Portfolio | Fall 2019 - Fall 2020

# SHOE CONTOUR

ARCH 1121: Architectural Design Communication | 1 week | Prof. Ostergaard | Fall 2019

## OBJECTIVE

The objective was to draw a shoe using contour lines in elevation and section.

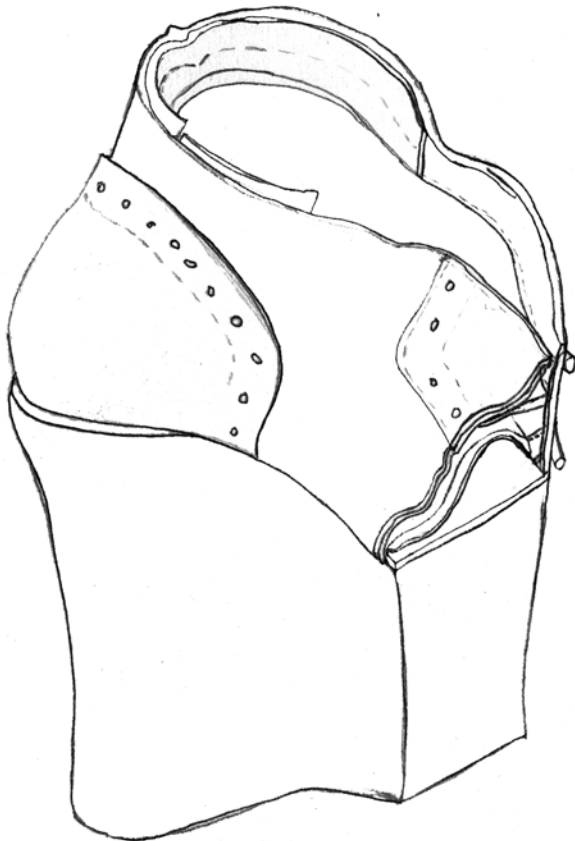

# STILL LIFE

ARCH 1121: Architectural Design Communication | 3 weeks | Prof. Ostergaard | Fall 2019

## OBJECTIVE

The objective was to create a set of shapes with a team of two other students. The team then created an arrangement of shapes as objects of individual drawings.

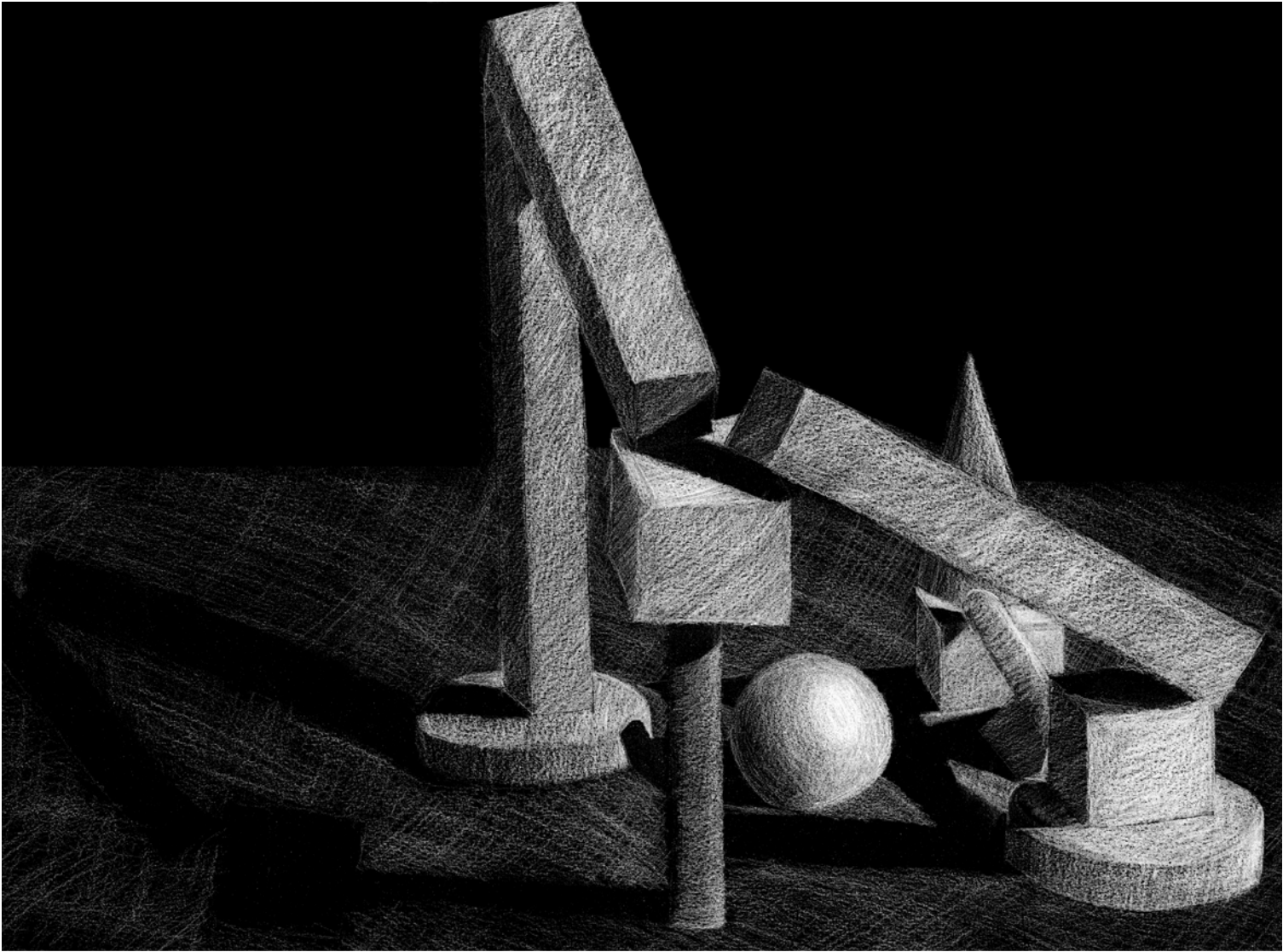
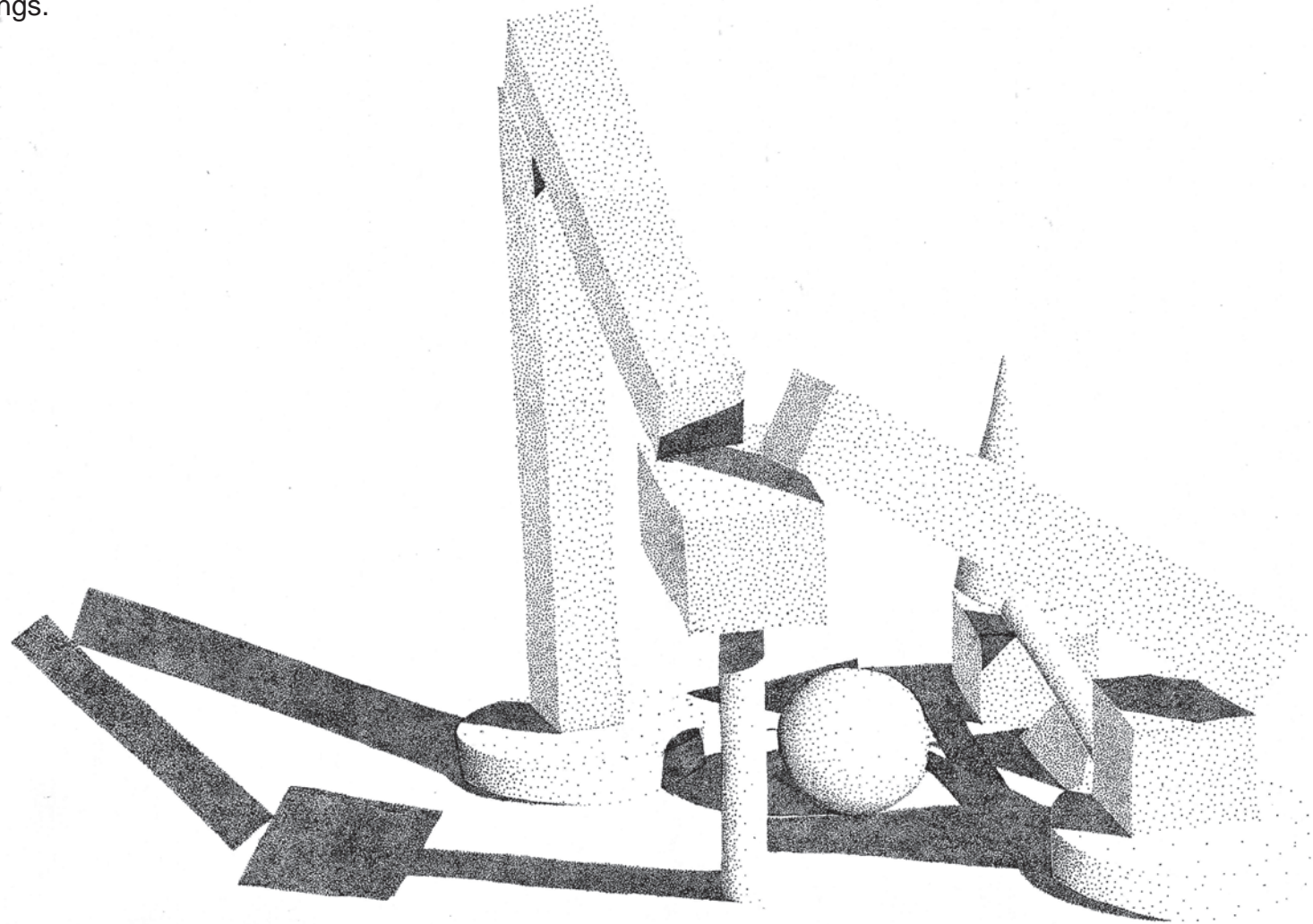



# TEXTURE DRAWING & COLLAGE

ARCH 1121: Architectural Design Communication | 1 week | Prof. Ostergaard | Fall 2019

## OBJECTIVE

The objective was to to create a collage out of available parts. This composition focuses on heirarchy and repetiton. The second step was drawings of the whole collage as well as samples of the materials.

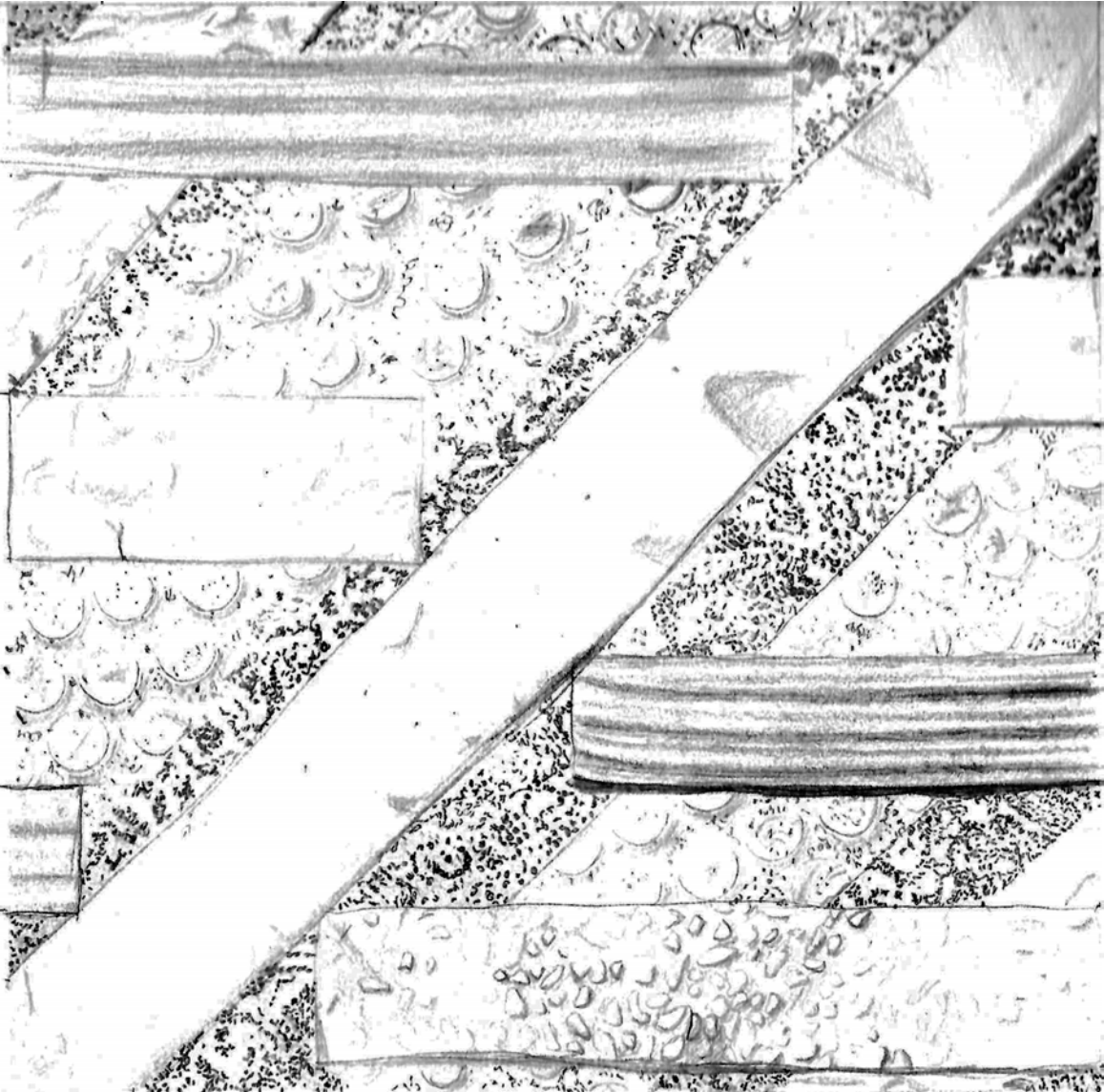
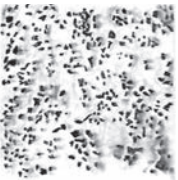
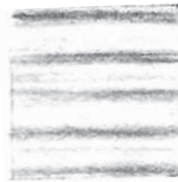
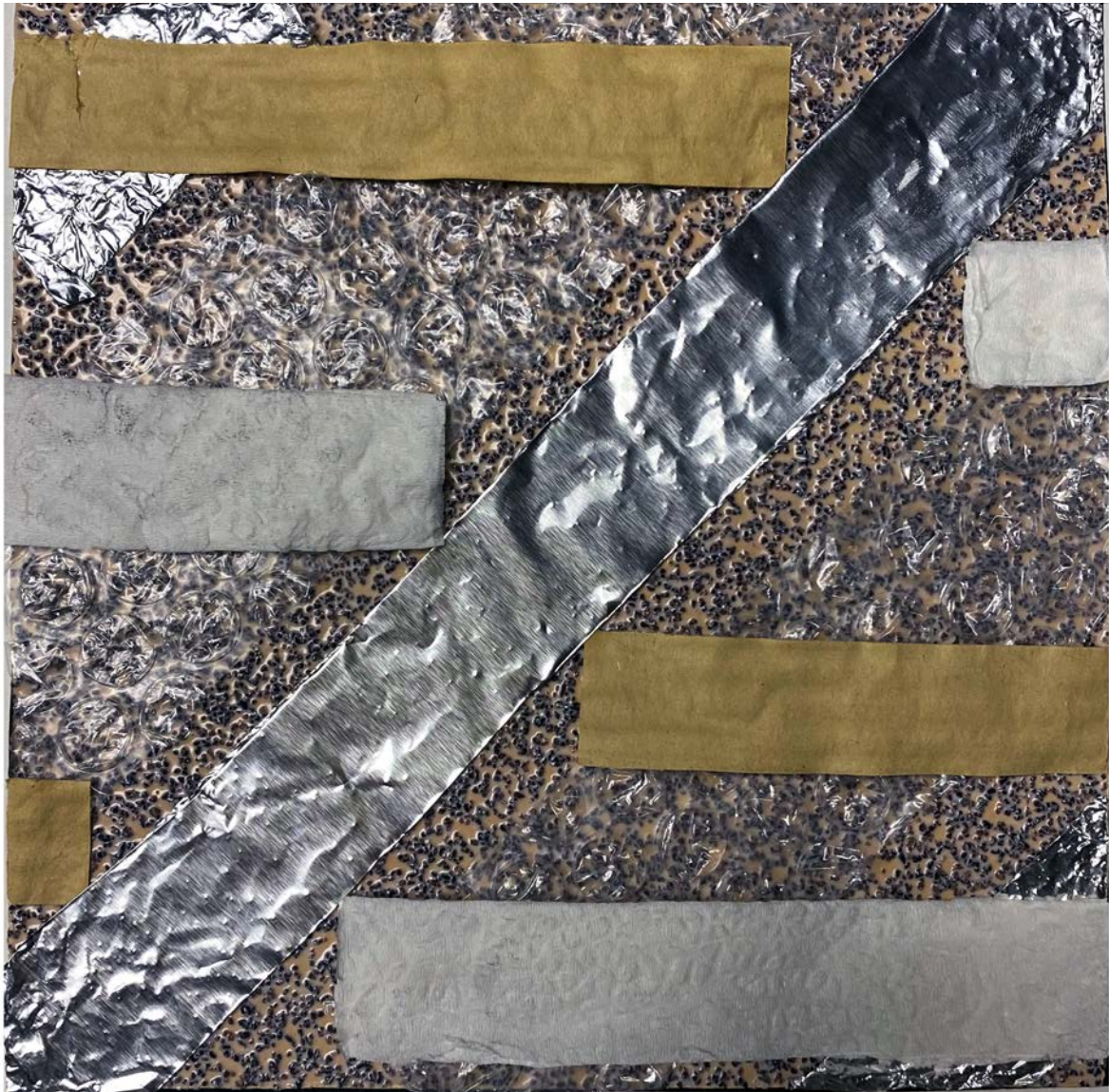



# COLOR THEORY

ARCH 1121: Architectural Design Communication | 1 week | Prof. Ostergaard | Fall 2019

## OBJECTIVE

The objective was to create compositions using different color harmonies with set sizing requirements. One of the compositions must be a collage, which needed to be representative of an emotion or sensation.

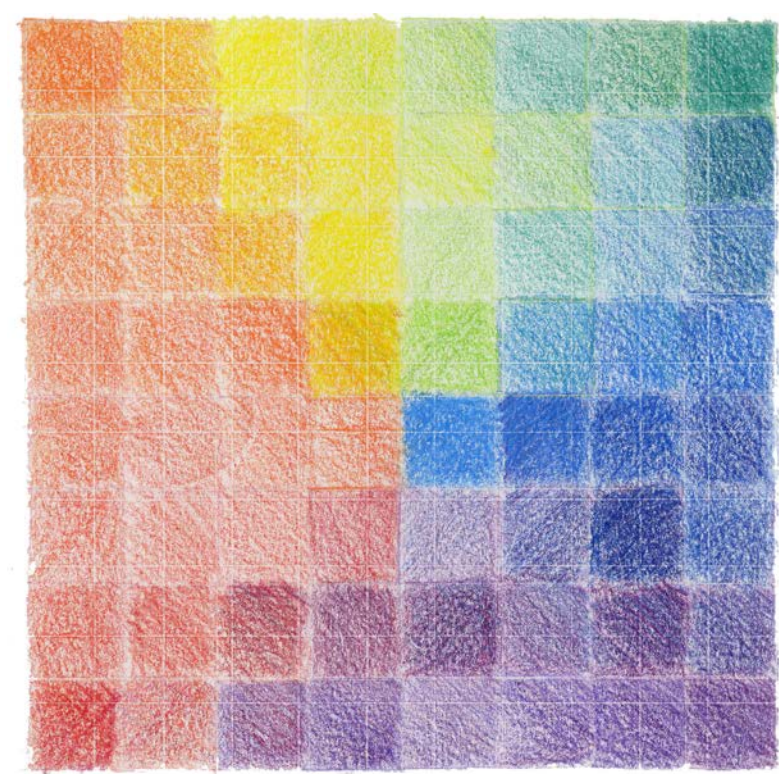

SPECTRUM

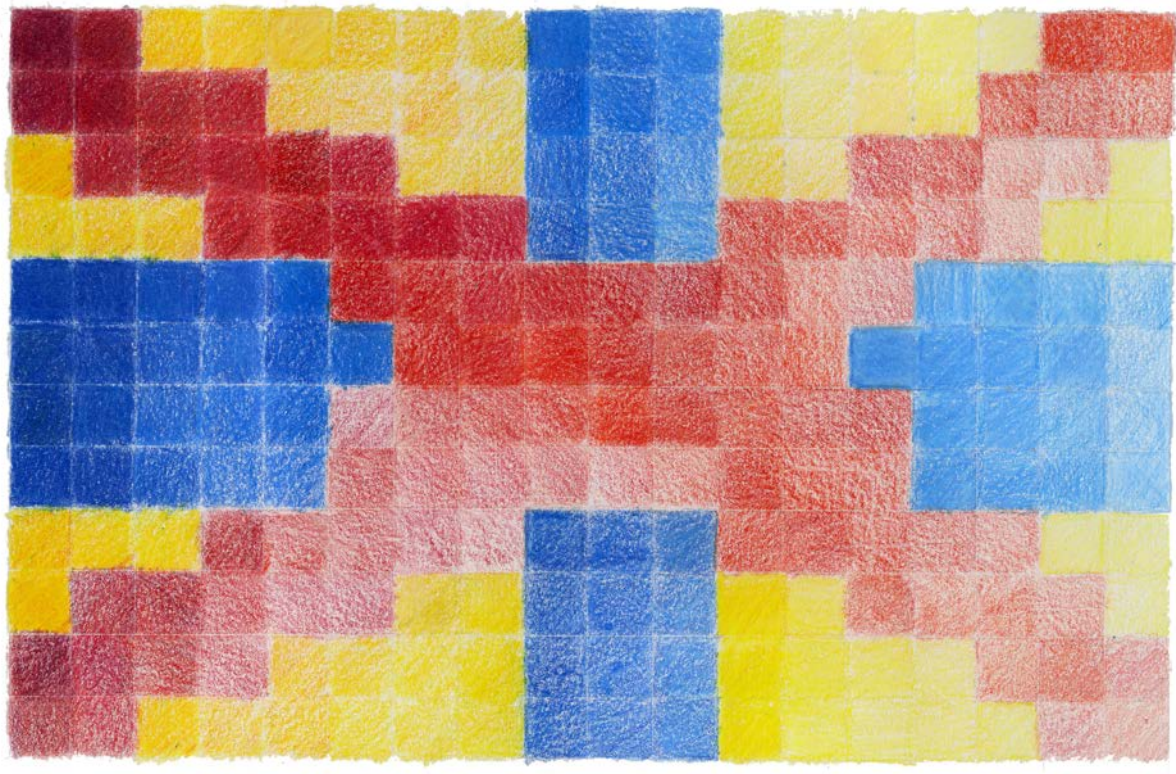

TRIAD



COMPLEMENTARY: “CURIOSITY”



MONOCHROMATIC



# BARCELONA PAVILLION

ARCH 1121: Architectural Design Communication | 4 weeks | Prof. Ostergaard | Fall 2019

## OBJECTIVE

The objective was to develop an understanding of the Barcelona Pavillion by Mies van der Rohe through generating different drawings and diagramming the space.

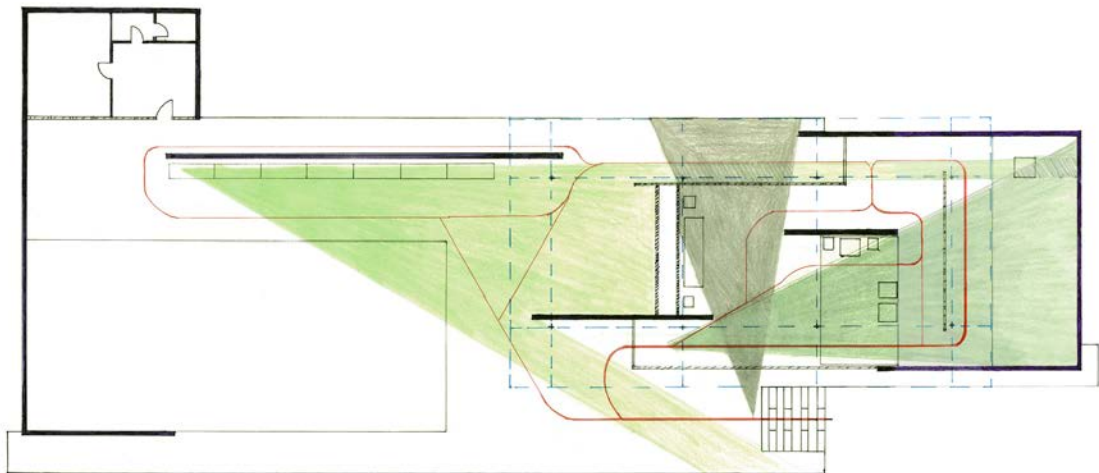

DIAGRAM

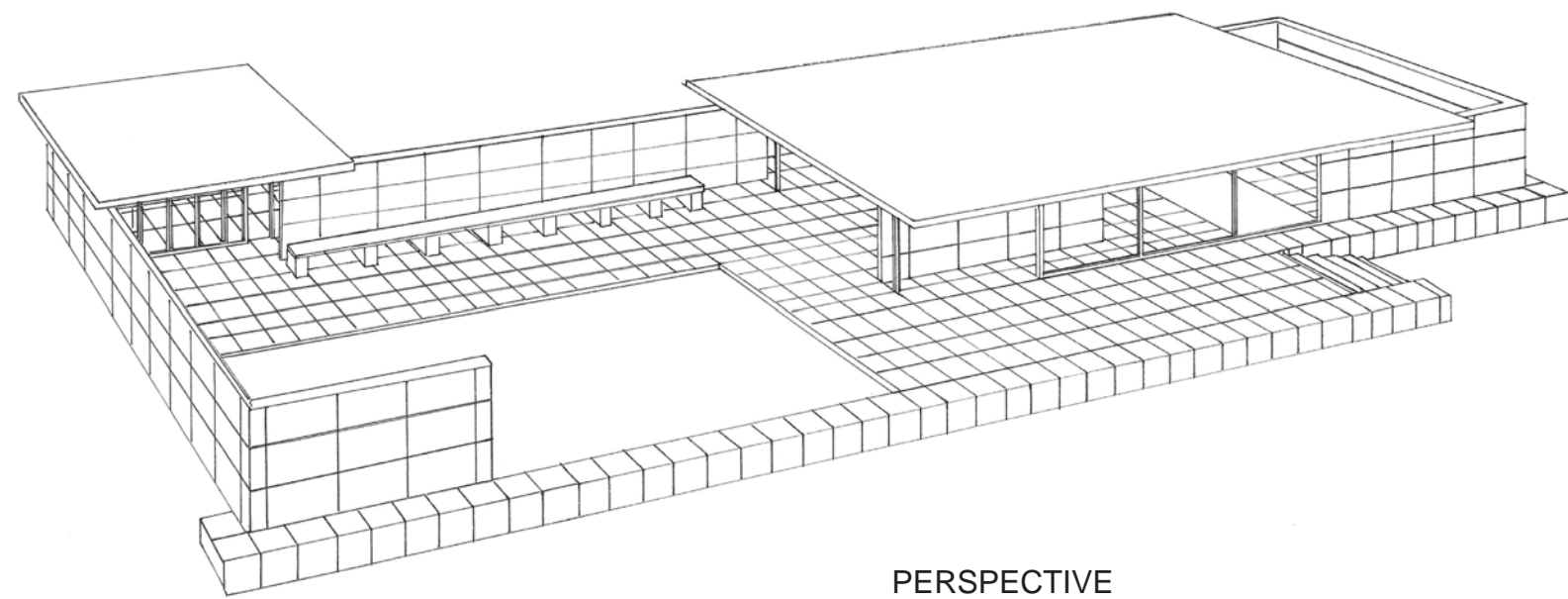

PERSPECTIVE

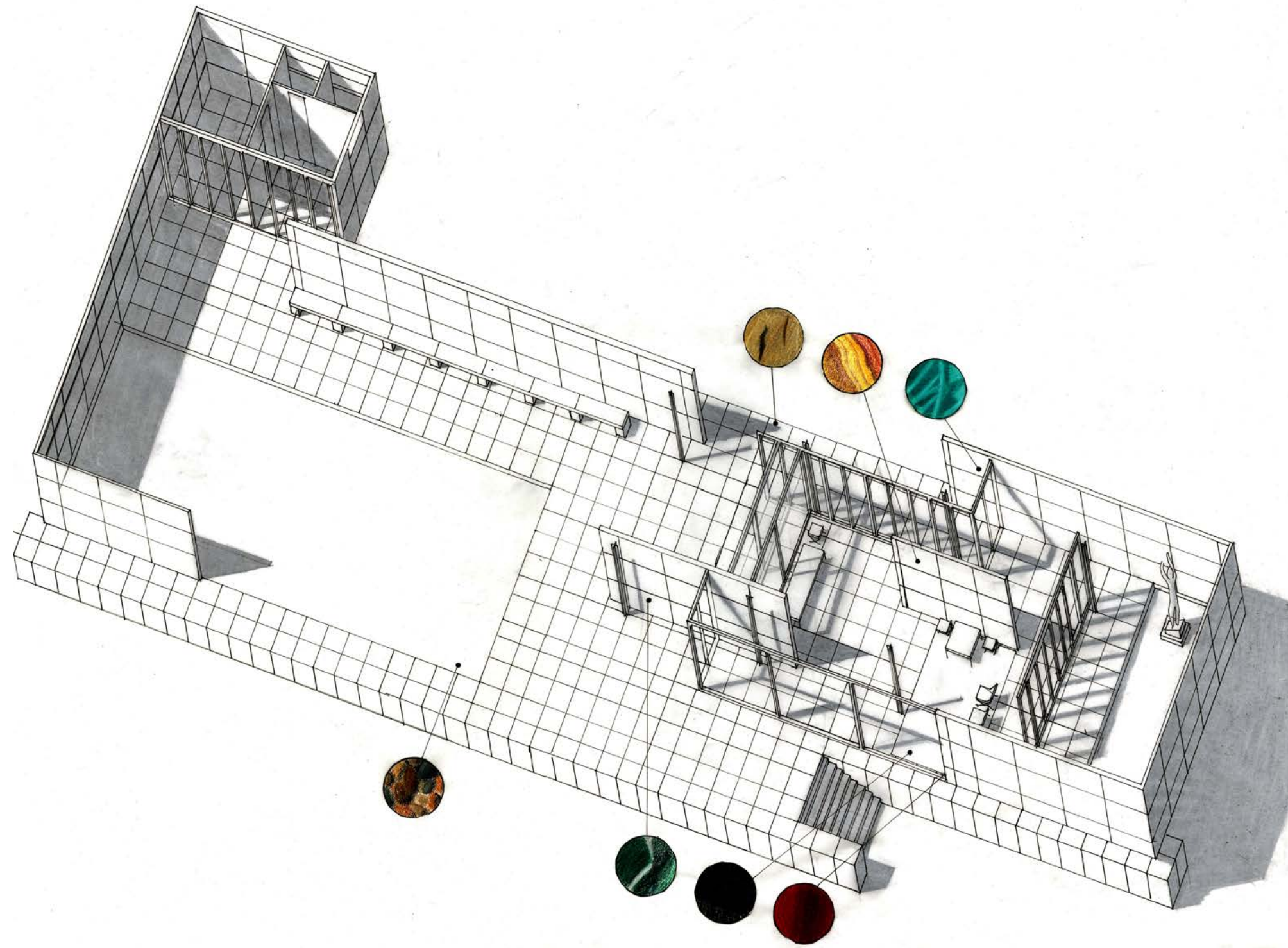

PLAN OBLIQUE WITH MATERIALS



# PERSPECTIVE JOURNEY

ARCH 1121: Architectural Design Communication | 3 weeks | Prof. Ostergaard | Fall 2019

## OBJECTIVE

The objective of the perspective journey was to design a series of architectural spaces using hand drafted one-point and two-point perspectives as the primary design tool.

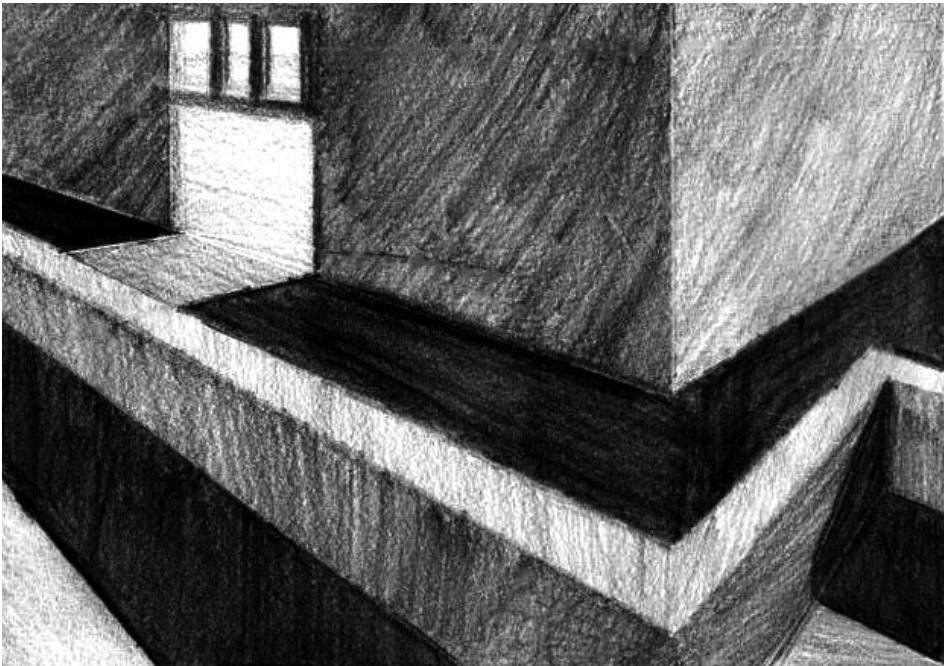
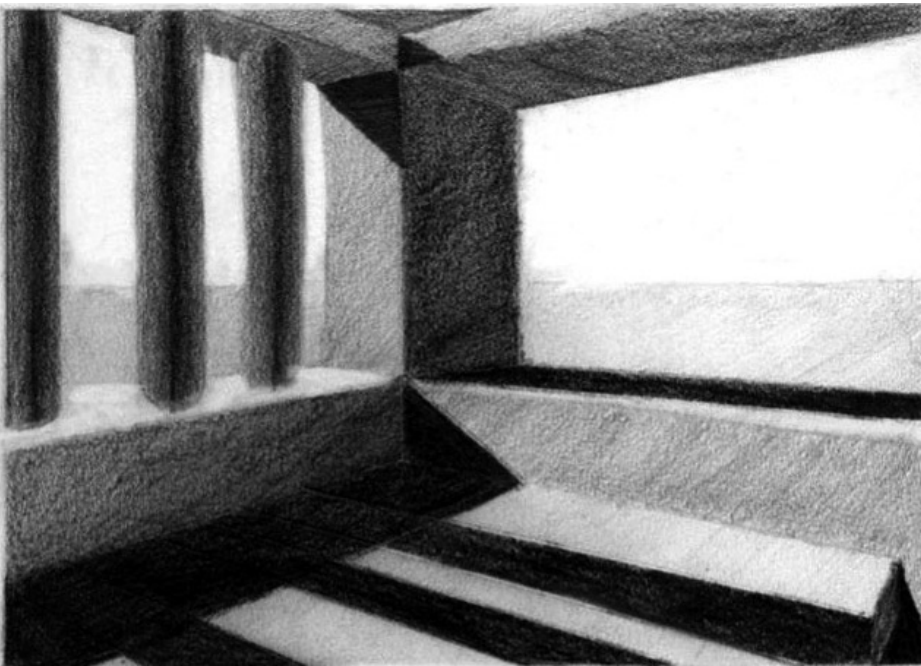
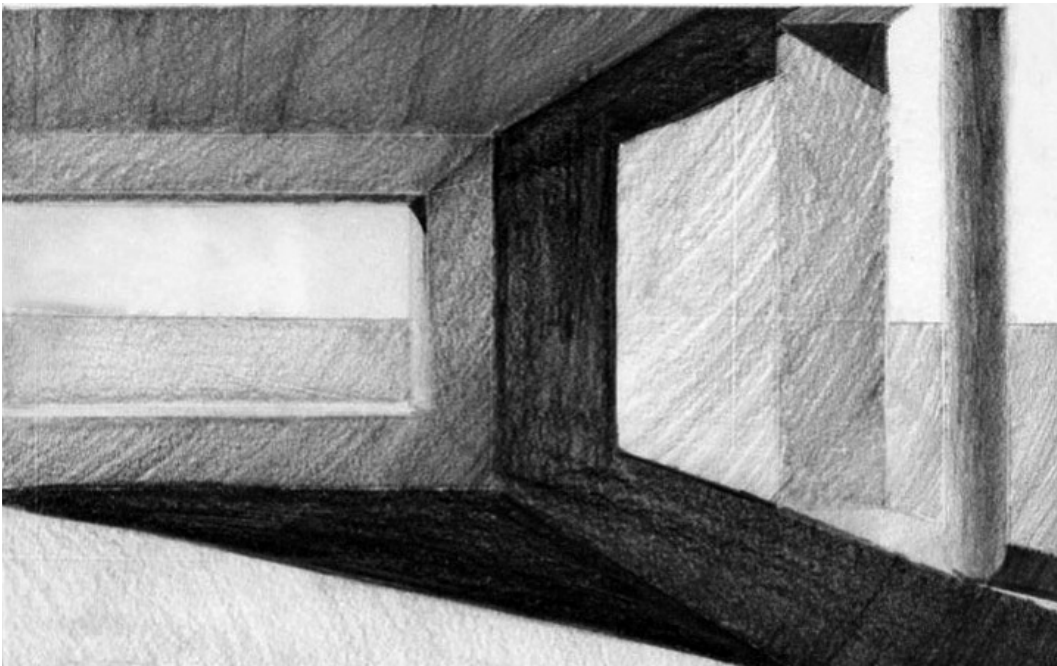
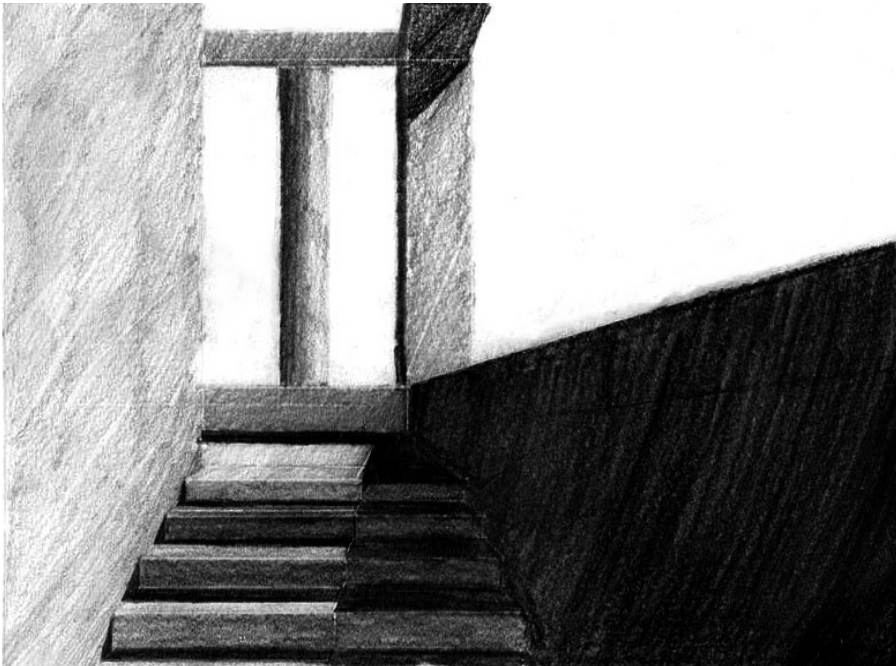
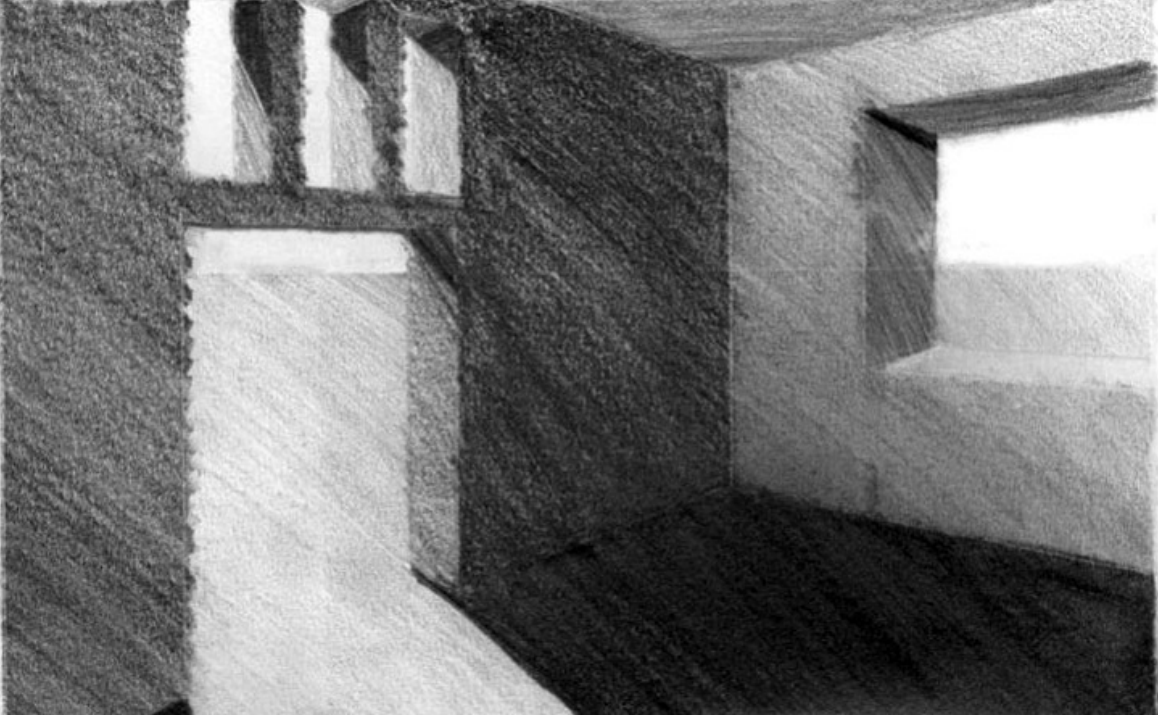
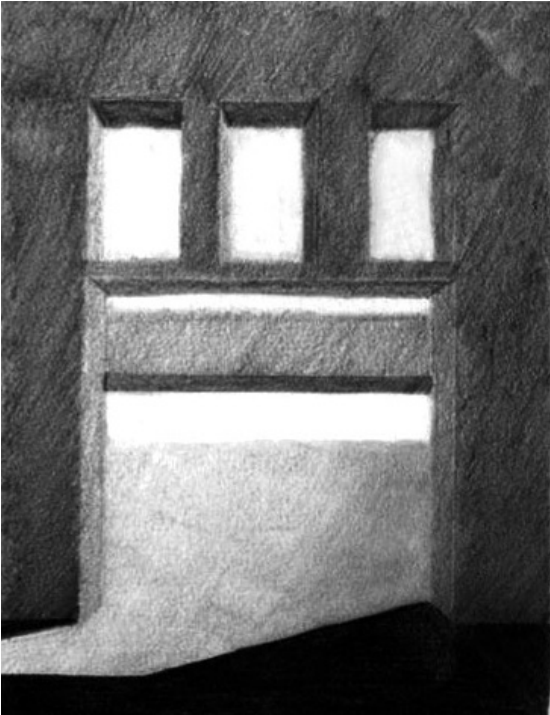



# BUILDING ANALYSIS

ARCH 1100: Introduction to Architecture | 6 weeks | Prof. Ostergaard | Fall 2019

## OBJECTIVE

The objective of the building analysis project was to research an architecturally significant building and to present the significant concepts of the building through a model and a verbal presentation. This project explored Santa Maria Del Fiore.

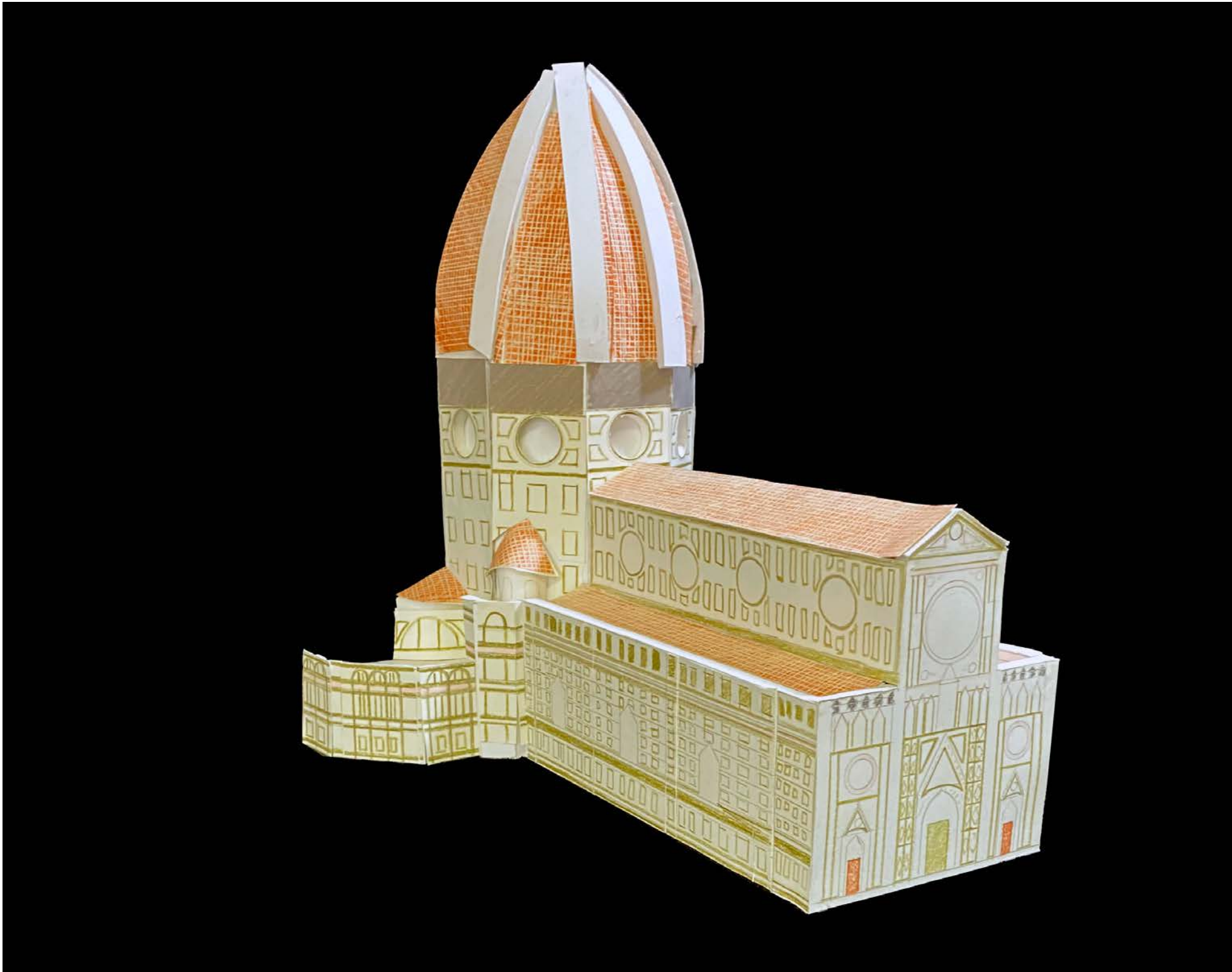
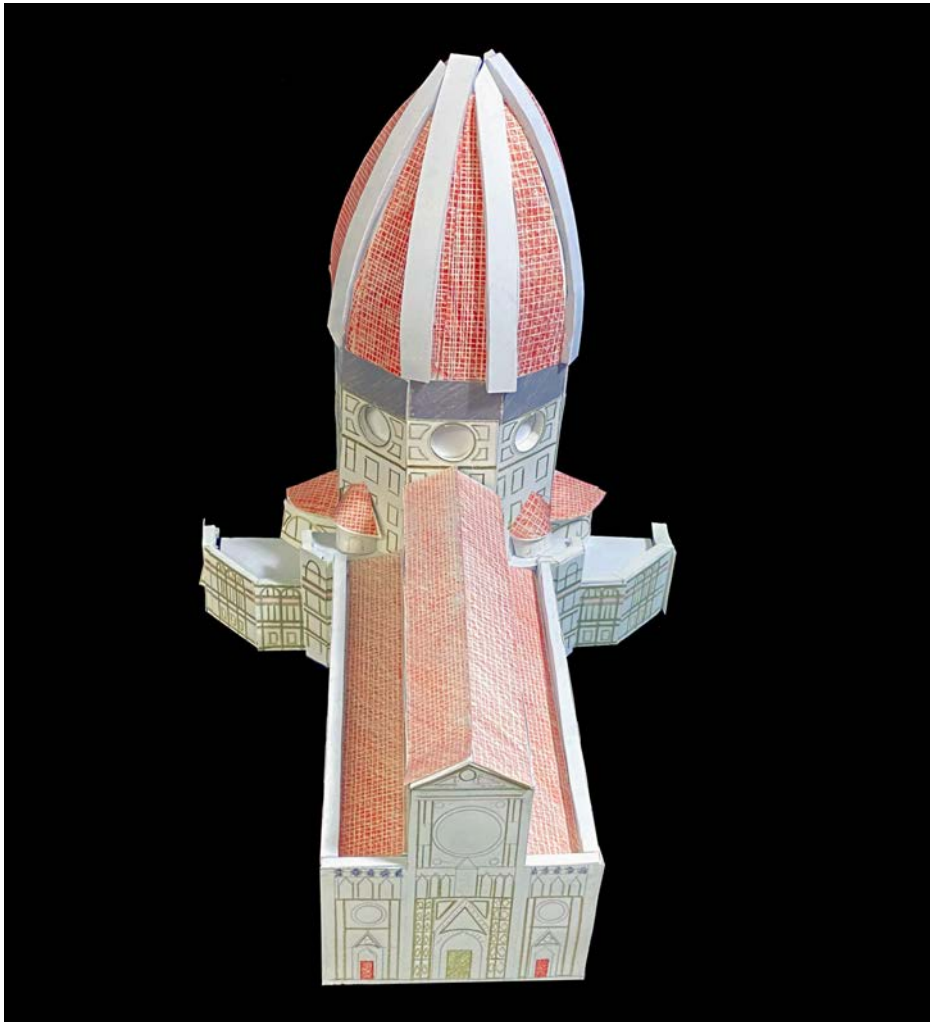



# ASSEMBLAGE, HIERARCHY, & FORM

ARCH 1131: Introduction to Architectural Design | 6 weeks | Prof. Ostergaard | Spring 2020

## OBJECTIVE

The objective was create a symmetrical and asymmetrical composition, beginning with a collage of pieces constructed using a set of rule based upon intersection points. These then developed into several drawings before developing into three-dimensional models and tonal drawings.

ASYMMETRICAL

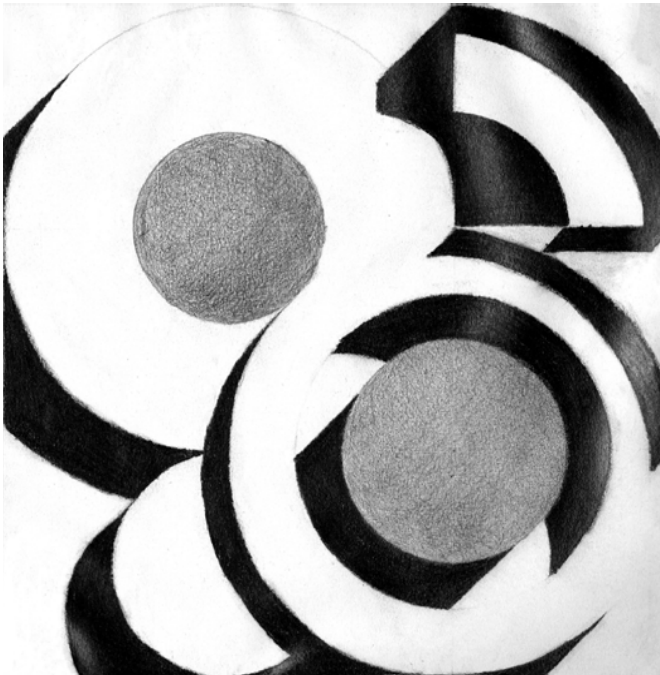
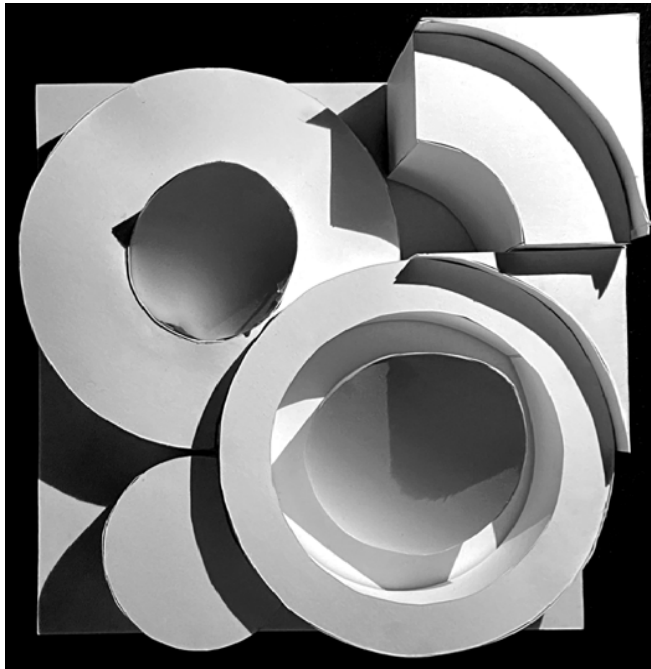
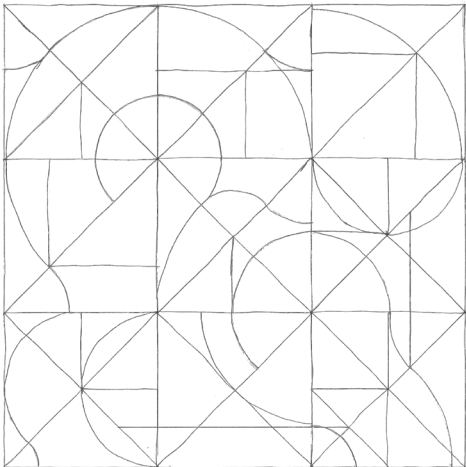
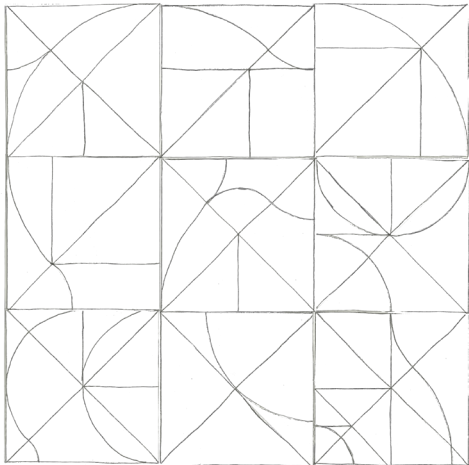

SYMMETRICAL

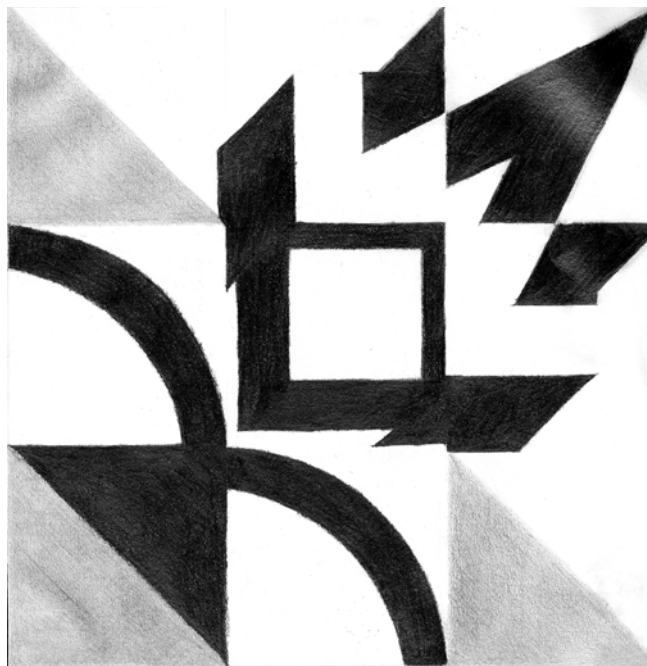
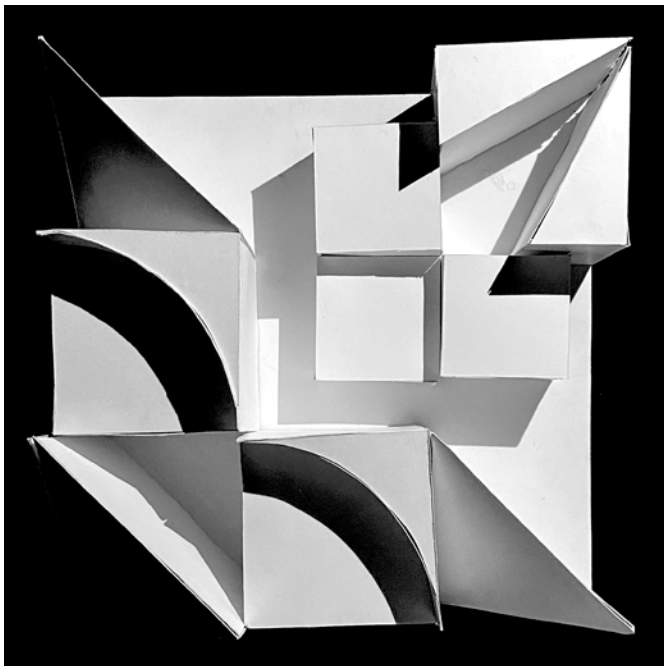
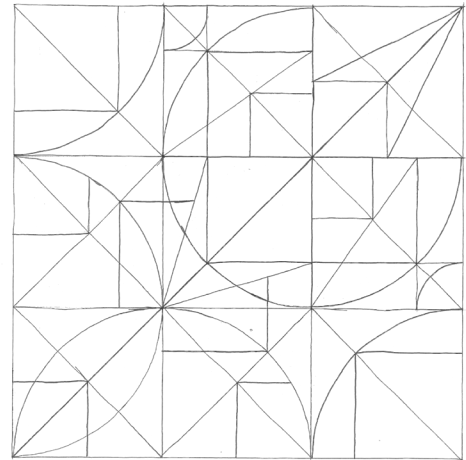
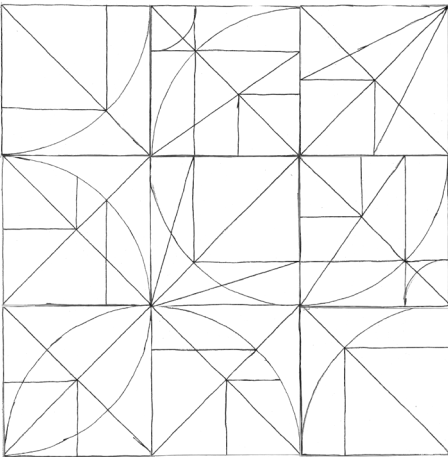

COLLAGE

ADDITIONAL LINES

MODEL

DRAWINGS



# COMMUNITY GATHERING SPACE

ARCH 1131: Introduction to Architectural Design | 3 weeks | Prof. Ostergaard | Spring 2020

## OBJECTIVE

The objective was to design an outdoor space on campus for students and faculty to use. Program requirements were relatively open ended, simply requiring the space be able to accomodate groups of various sizes as well as an individual. Drawings were the main design tool.

## CONCEPT

This design is centered around the idea of a short break. It is located nearby an easily accessible pedestrian route near the main entrance to the building. It is meant to be able to give an individual a place to take a moment for themselves as well as cater to a group to relax and chat between classes.



PLAN OBLIQUE

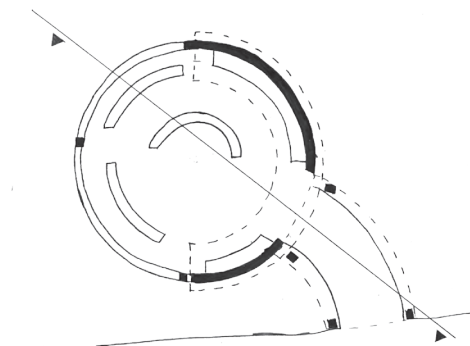

PLAN

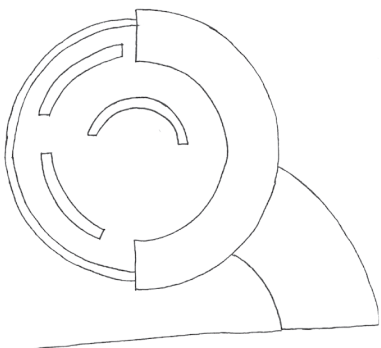

ROOF PLAN



SECTION

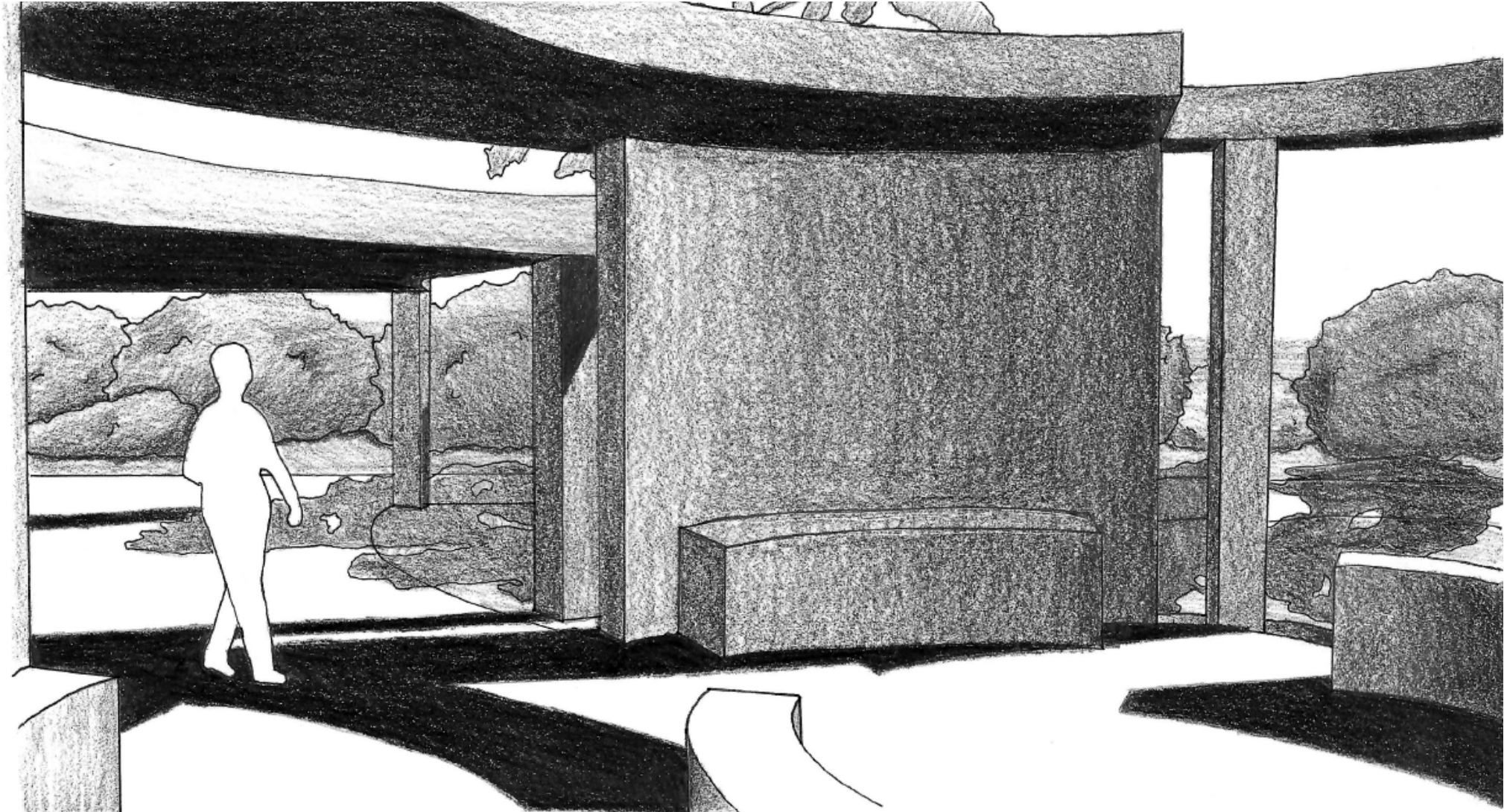



# SPATIAL SEQUENCE

ARCH 1131: Introduction to Architectural Design | 3 weeks | Prof. Ostergaard | Spring 2020

## OBJECTIVE

The objective was to design a series of three outdoor spaces in a park setting linked together by a path built from a limited kit of parts. Each space was supposed to be the most effective in one of three seasons: spring, summer, or fall.

## CONCEPT

This sequence of spaces allows the user to participate in the characteristic elements of each season. The spaces give the user views of greenery and a sense of closeness with nature through a visual connection and physical proximity. The summer space provides a shady spot with a breeze after a short walk to rest from the heat. The spring space looks upon an open expanse in spring to relieve the user from the cramped conditions of winter. The fall space is preceded by a longer walk surrounded by trees leading to a space with changing leaves blowing through it.



PLAN



SECTION



STRUCTURE



CONCEPT



CIRCULATION



PARTI



SUMMER



SPRING



FALL



# INSPIRATION COLLAGE

ARCH 1121: Architectural Design Communication | 3 weeks | Prof. Ostergaard | Fall 2019

## OBJECTIVE

The objective was to create a collage using sketches of buildings and photos from daily life. These three dimensional collages were developed as two series of study models with the choice between the two as the final model.

## CONCEPT

Series 2, which resulted in the final model, focused on studying the contrast between organic materials and refined natural materials, shifting to a sole focus on wood. It emphasizes layering and an irregular rhythm of repetitive elements to reinforce the concept. The final model juxtaposes the driftwood with the basswood strips as a communication this the concept.

## KEY SKETCHES

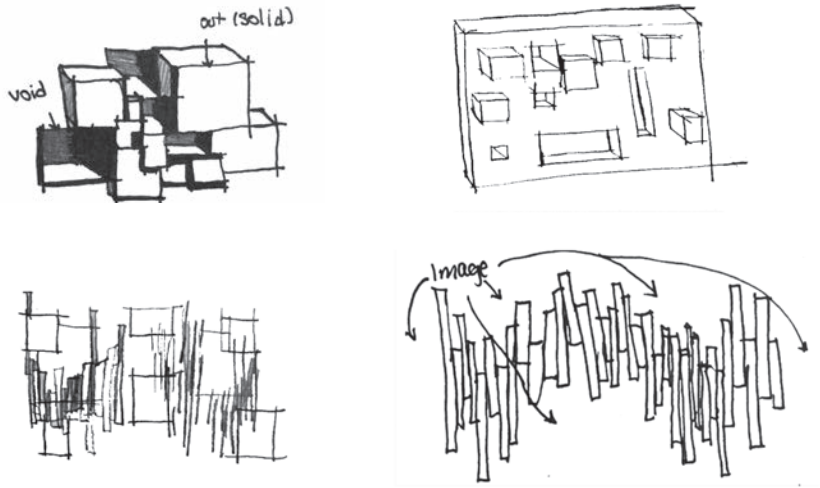

## STUDY MODELS

SERIES 1

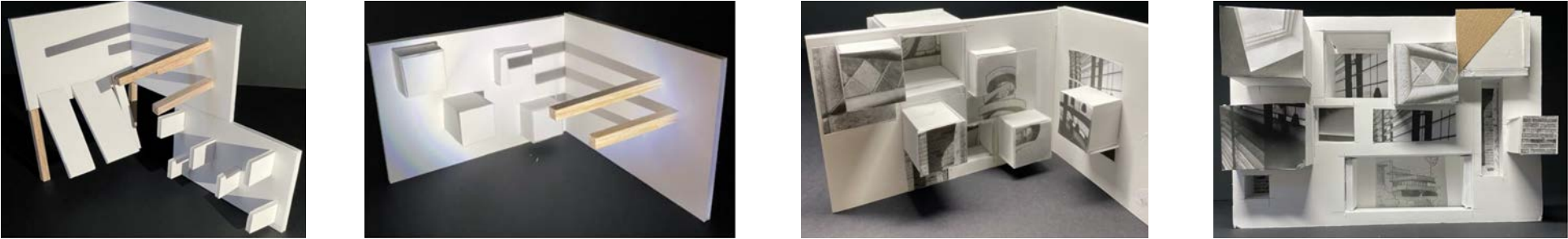

SERIES 2

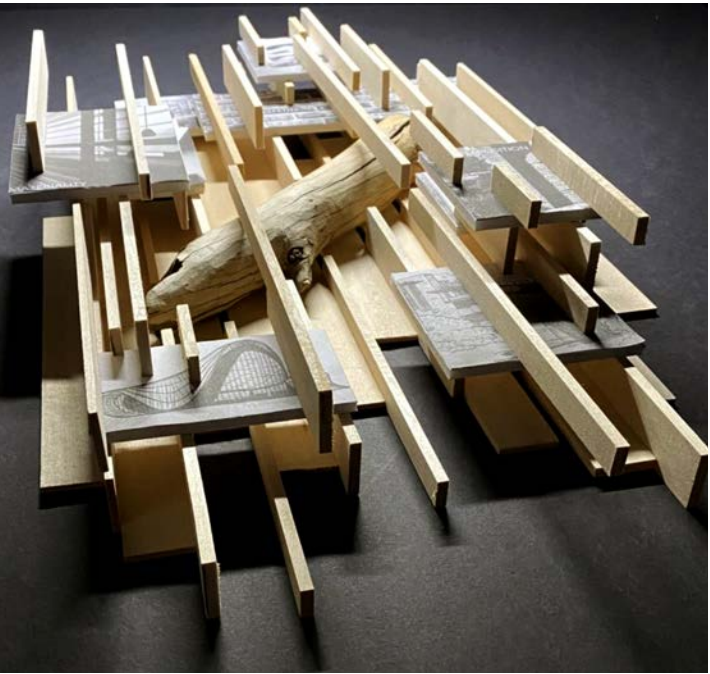
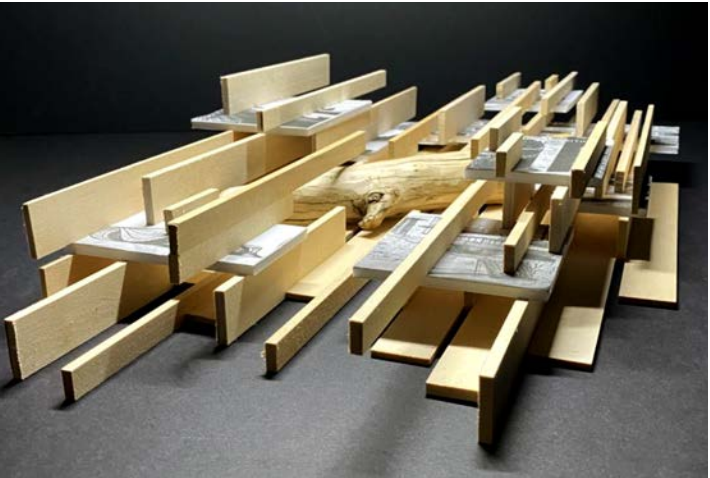
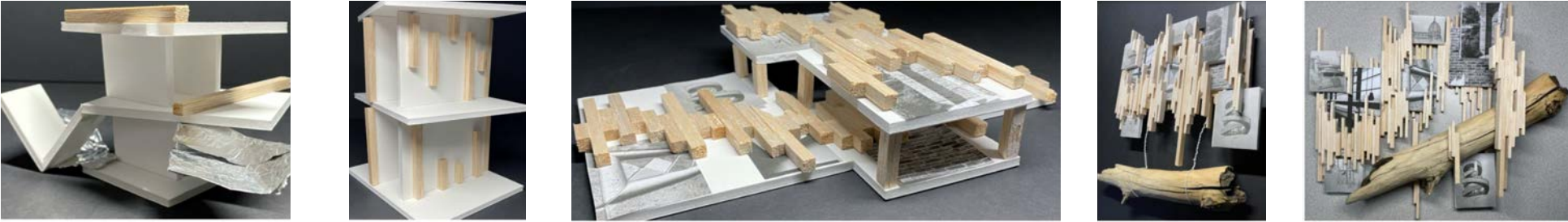



# ECOLOGY CENTER

ARCH 2201: Architectural Design I | 12 weeks | Prof. Pearson | Fall 2020

## OBJECTIVE

The objective was to design an ecology center located on a community college campus in a suburban area adjacent to the prairie on campus. The program involved an event space, some education spaces including a lab, a cafe, an outdoor classroom, and a small greenhouse, as well as some additional support spaces.

## CONCEPT

When standing in the prairie, it is easy to look in two different directions and feel an entirely different sense of the place. This environmental education center aims to celebrate that changing nature of the prairie. It uses the corner view as a mechanism to experience and emphasize that atmosphere. The corner view emphasizes the juxtaposition between two views at once. Throughout the center and the site, the user is meant to feel closer to the prairie with the boundary close to allow for a hands-on interaction. It brings visitors closer to the prairie in order to better connect with and understand it.

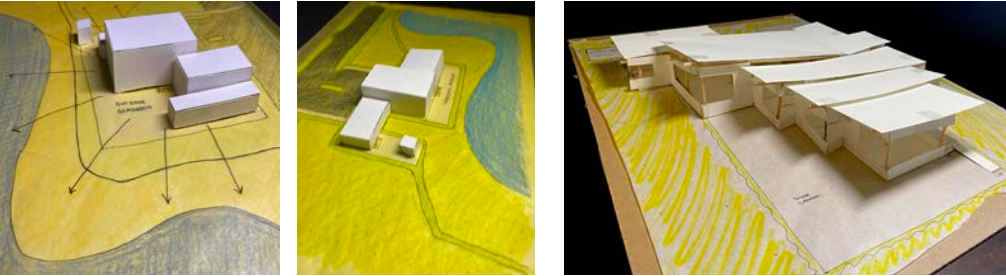
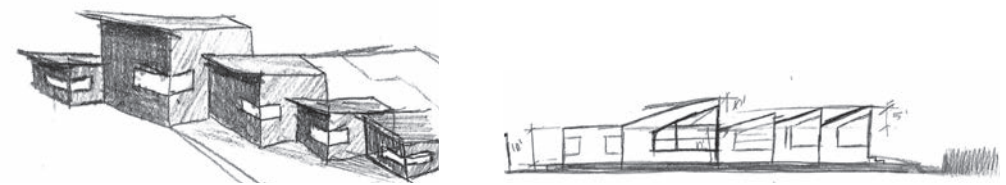

PROCESS SKETCHES AND MODELS

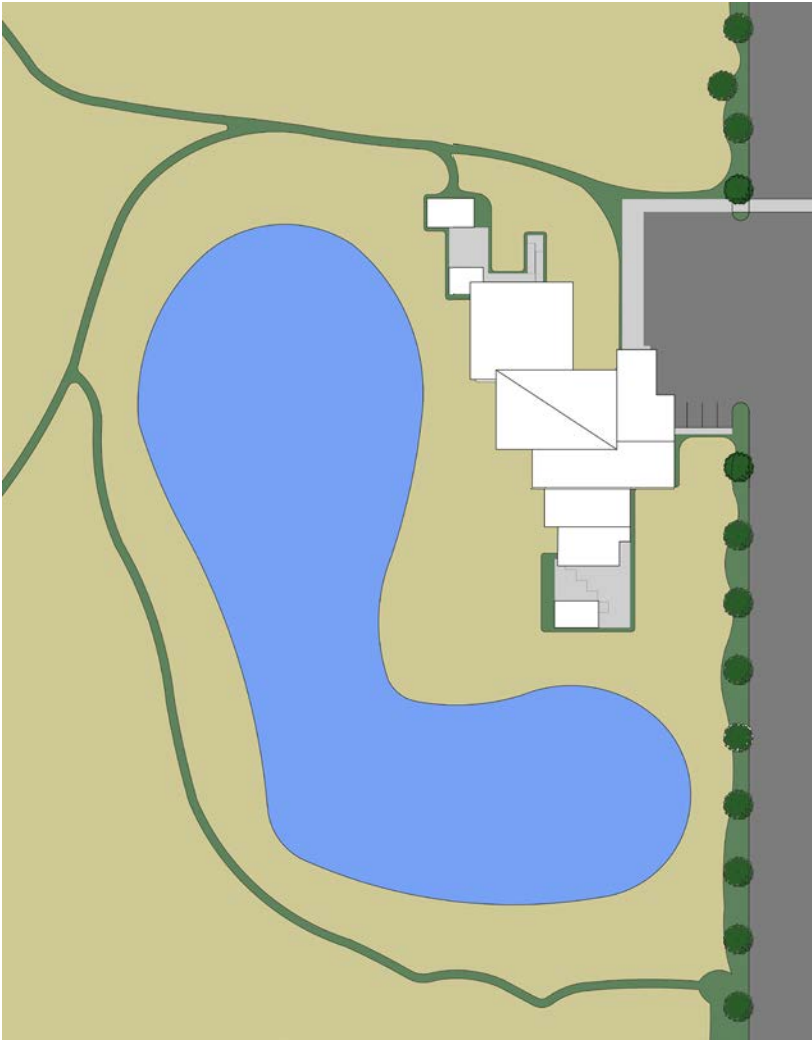
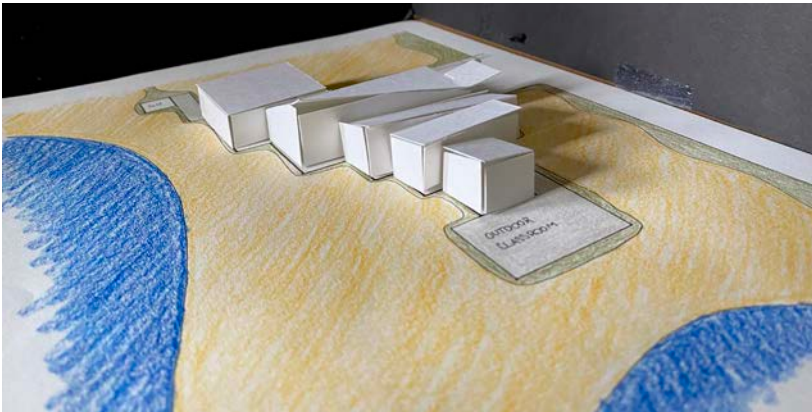

SITE PLAN

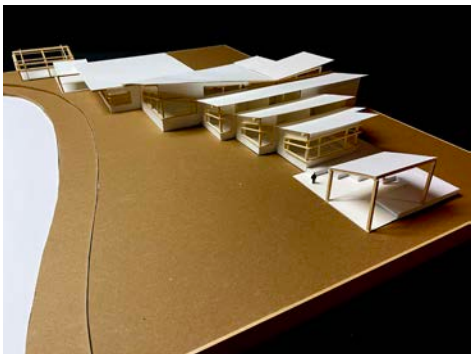
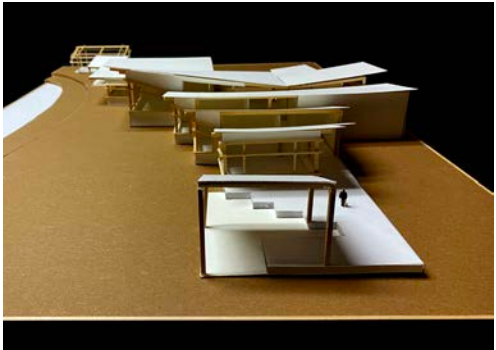
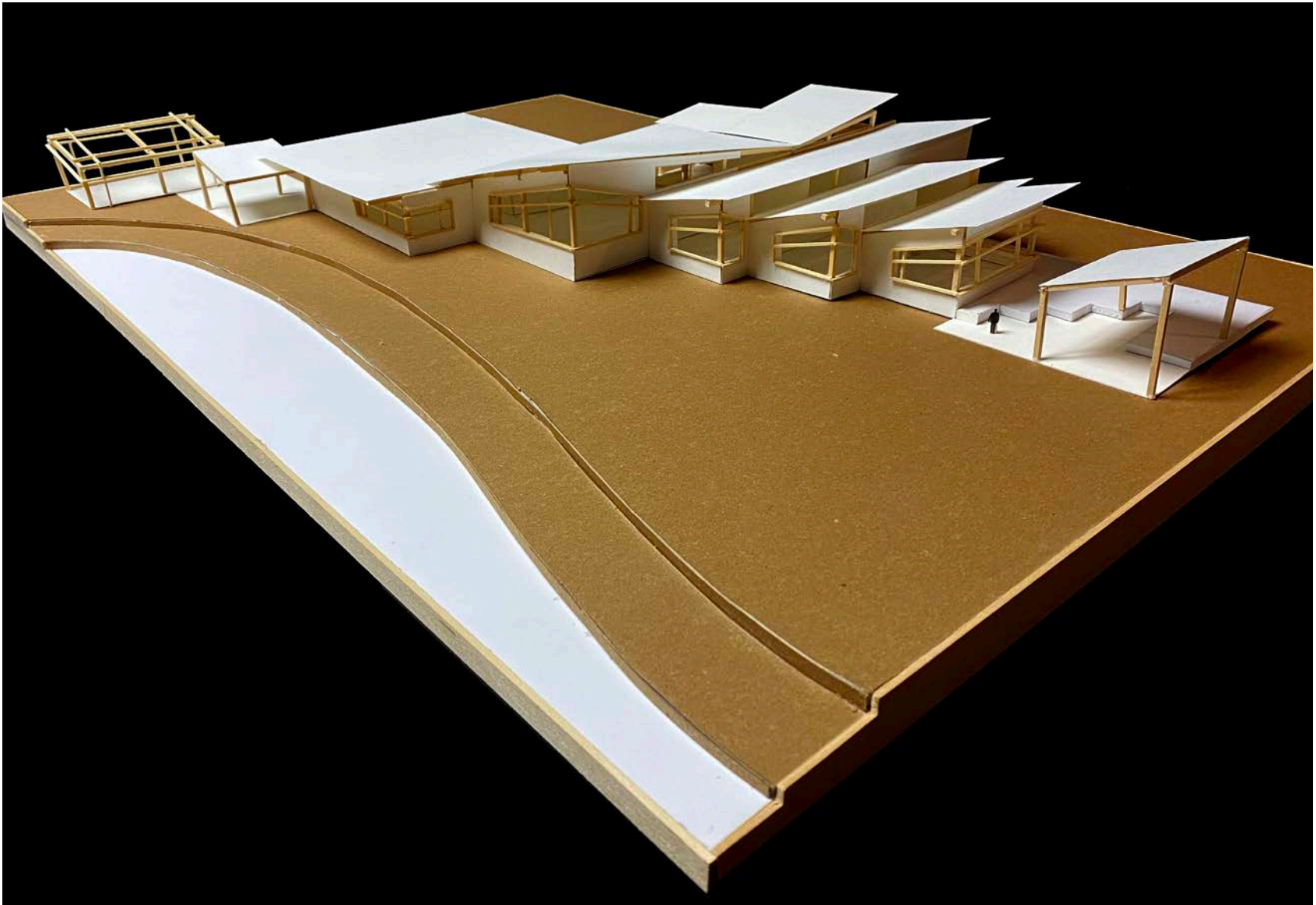



# ECOLOGY CENTER

ARCH 2201: Architectural Design I | 12 weeks | Prof. Pearson | Fall 2020

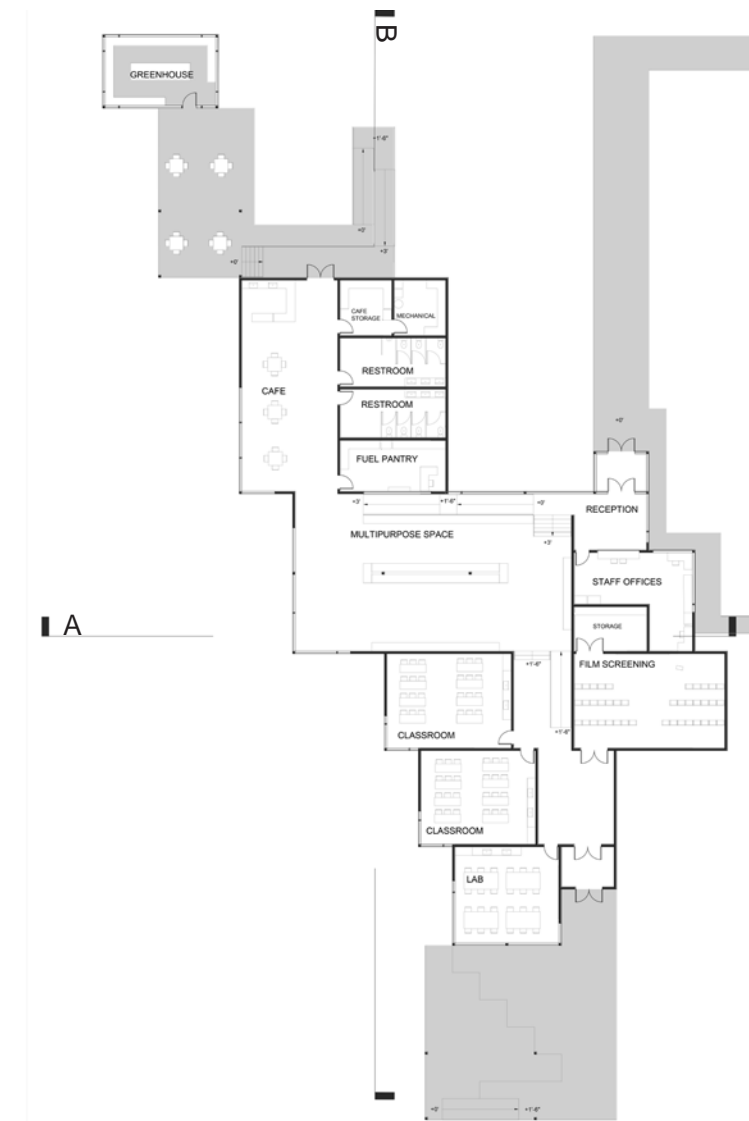

PLAN

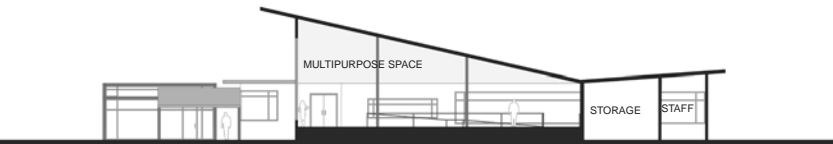

SECTION A

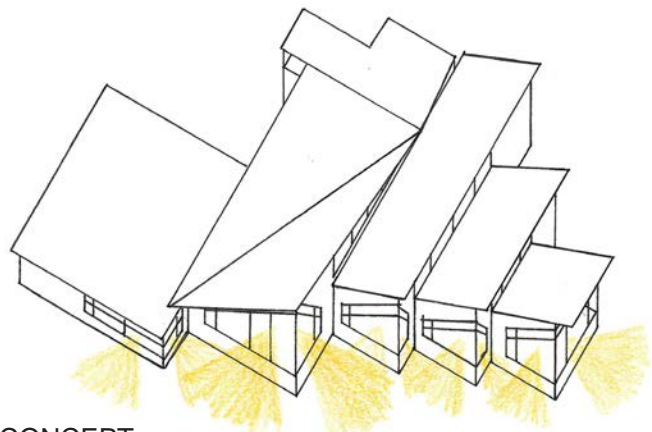

CONCEPT

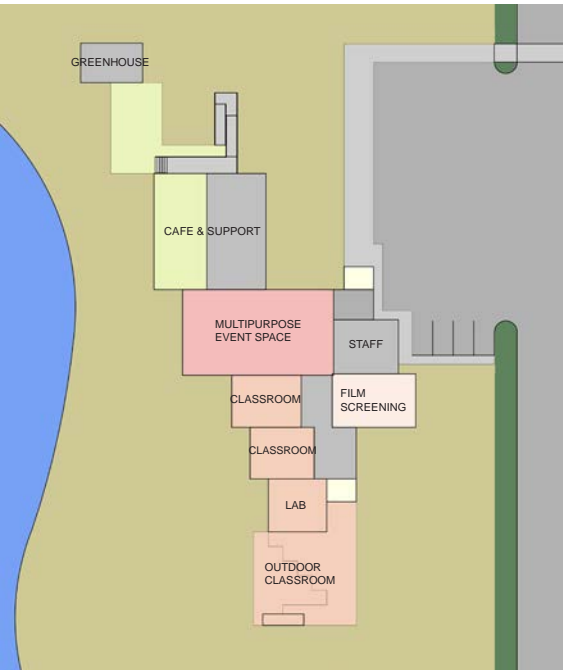

PARTI

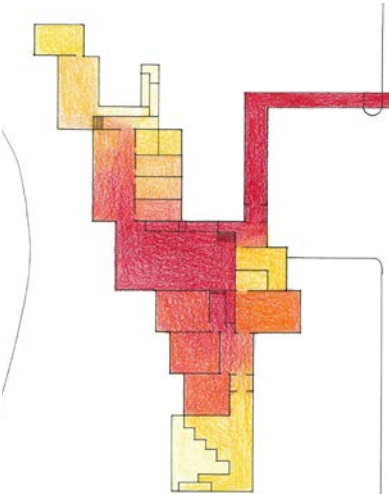

CIRCULATION

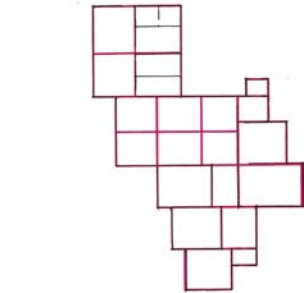

STRUCTURE

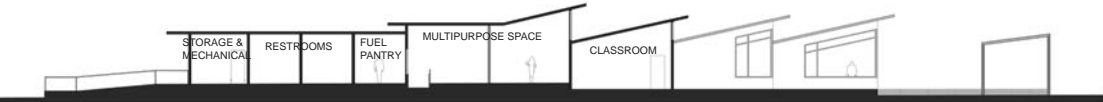

SECTION B

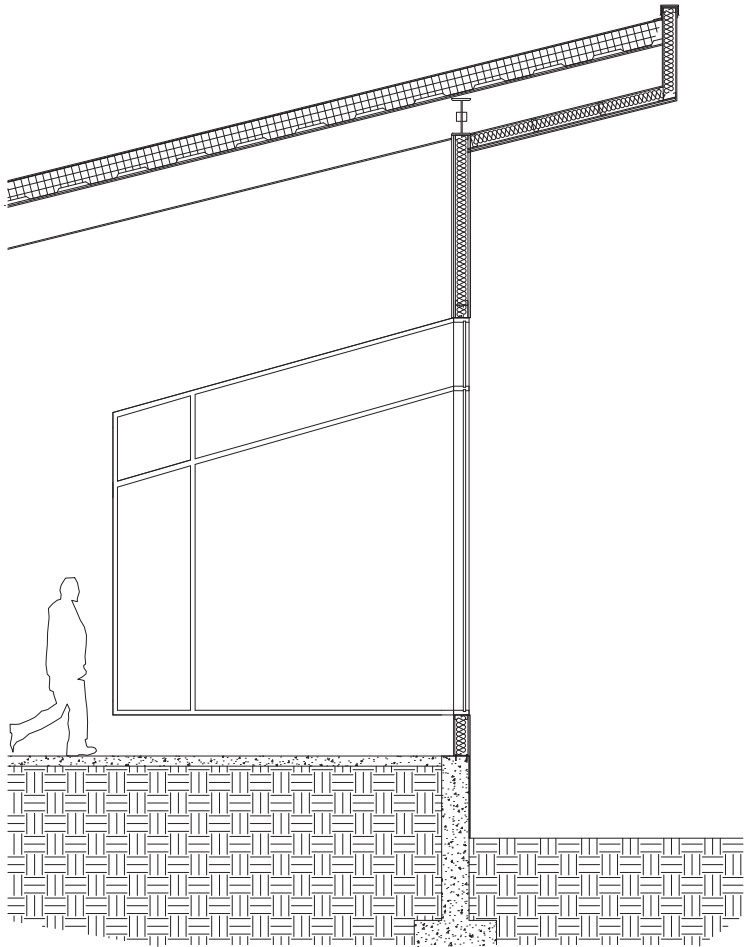
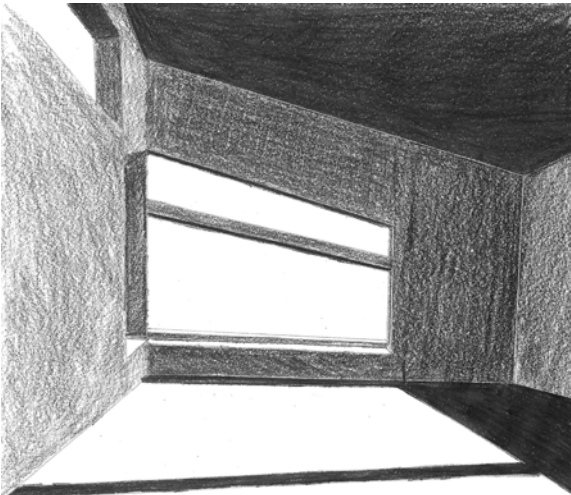
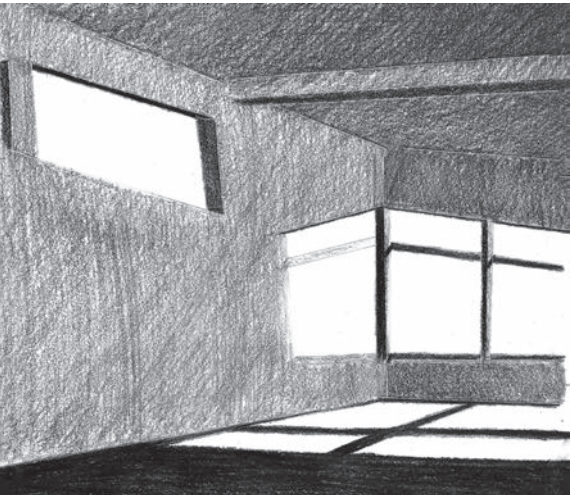

DETAIL SECTION, PHOTOGRAPHS, & INTERIOR PERSPECTIVES





