

Stephanie McNicholas

PORTFOLIO

PERSPECTIVE JOURNEY

ARCHITECTURE 1121

SPRING 2016

Objective: Design imaginary spaces using one-point and two-point perspective.

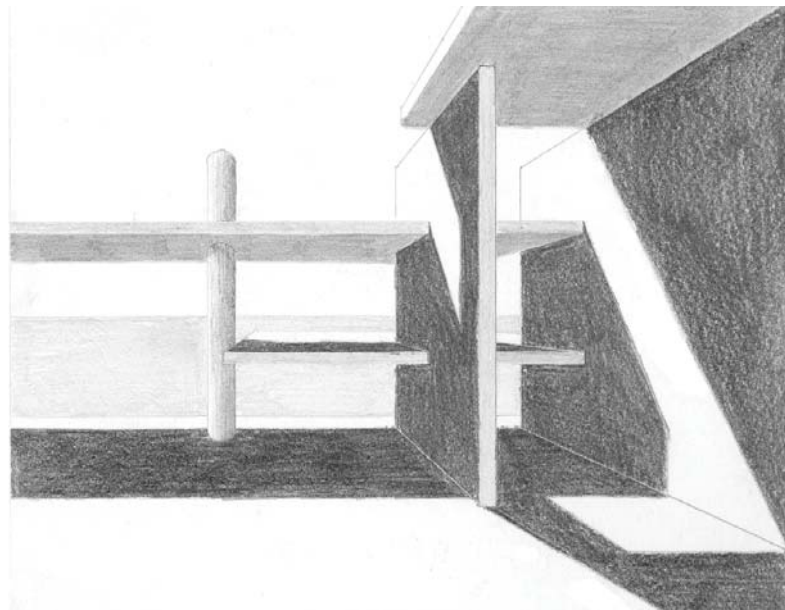
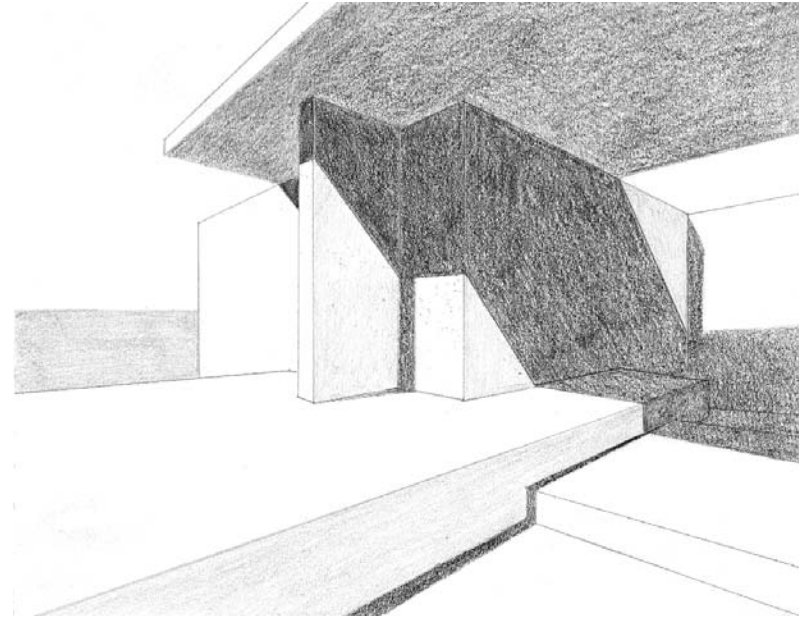
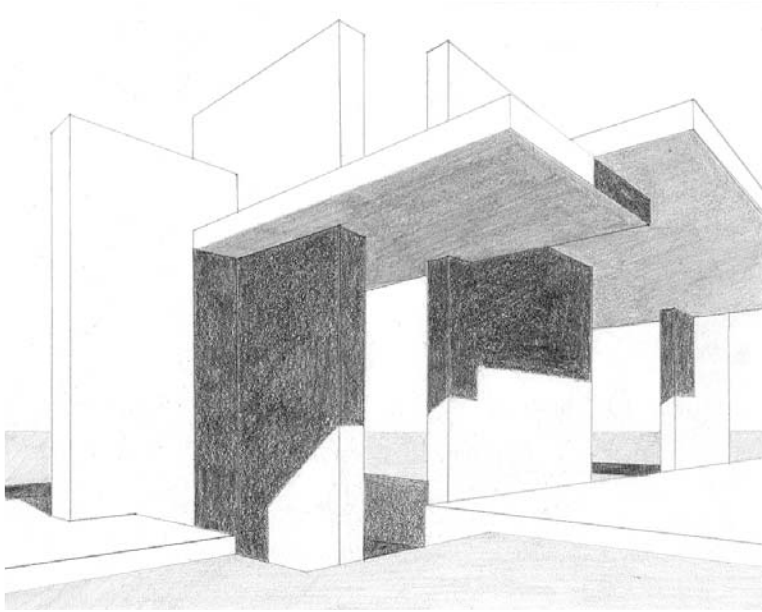

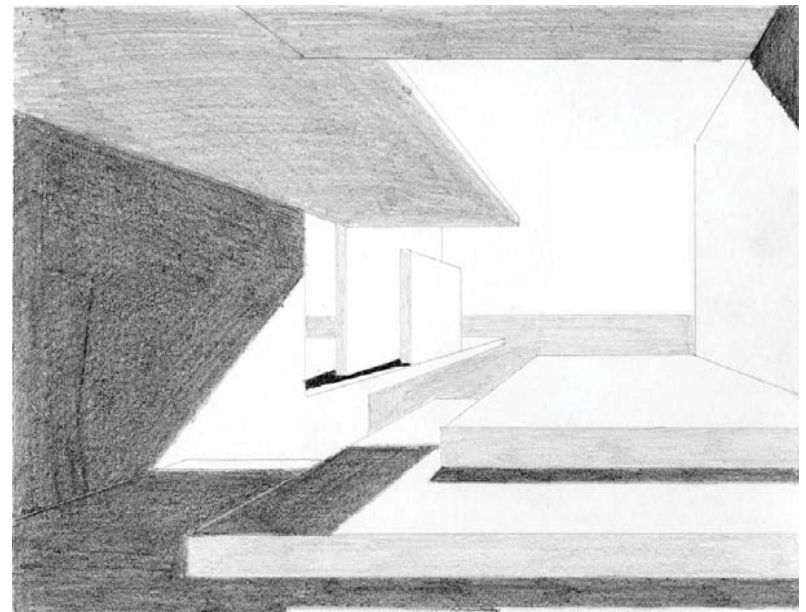
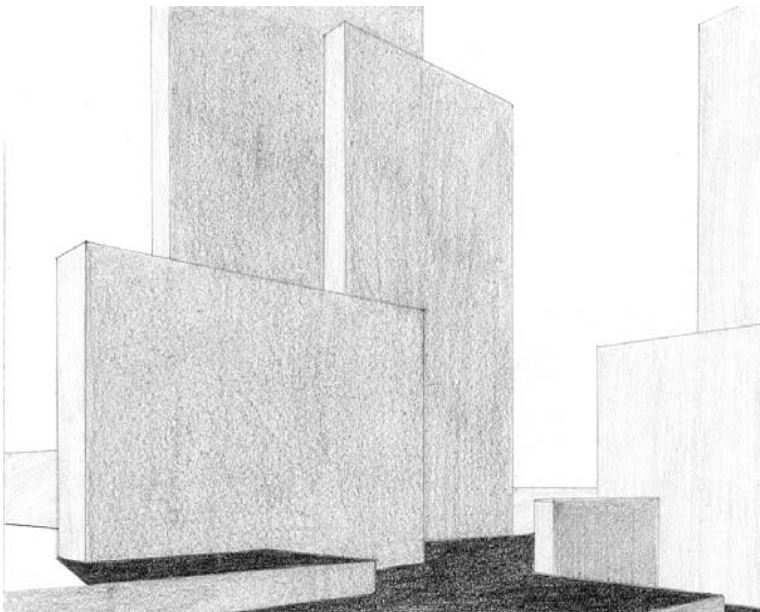
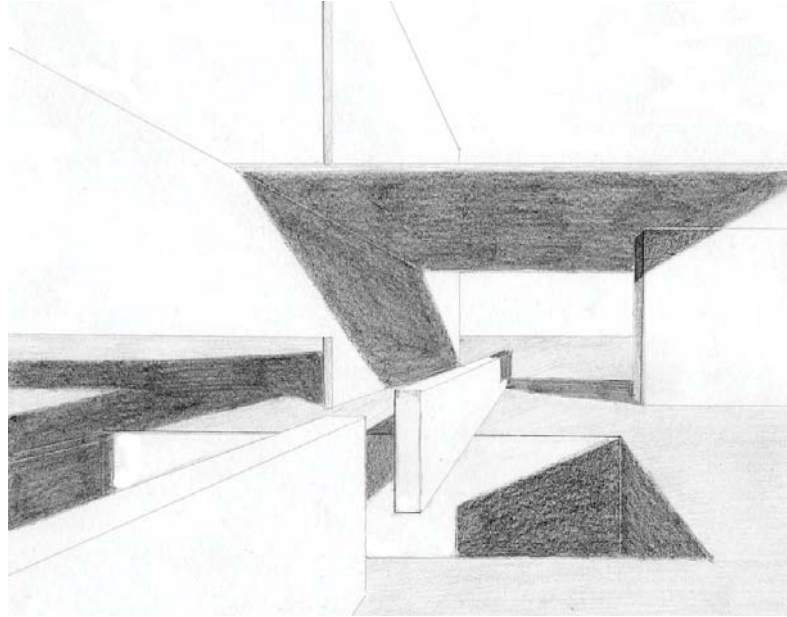

ASSEMBLAGE, HIERARCHY & FORM

ARCHITECTURE 1131

SUMMER 2016

Objective: Design 3x3 inch compositions. Arrange compositions into 9x9 inch symmetrical and asymmetrical collages. Develop collages by adding lines and line weights. Construct models of designs and create three-dimensional drawings using tone.

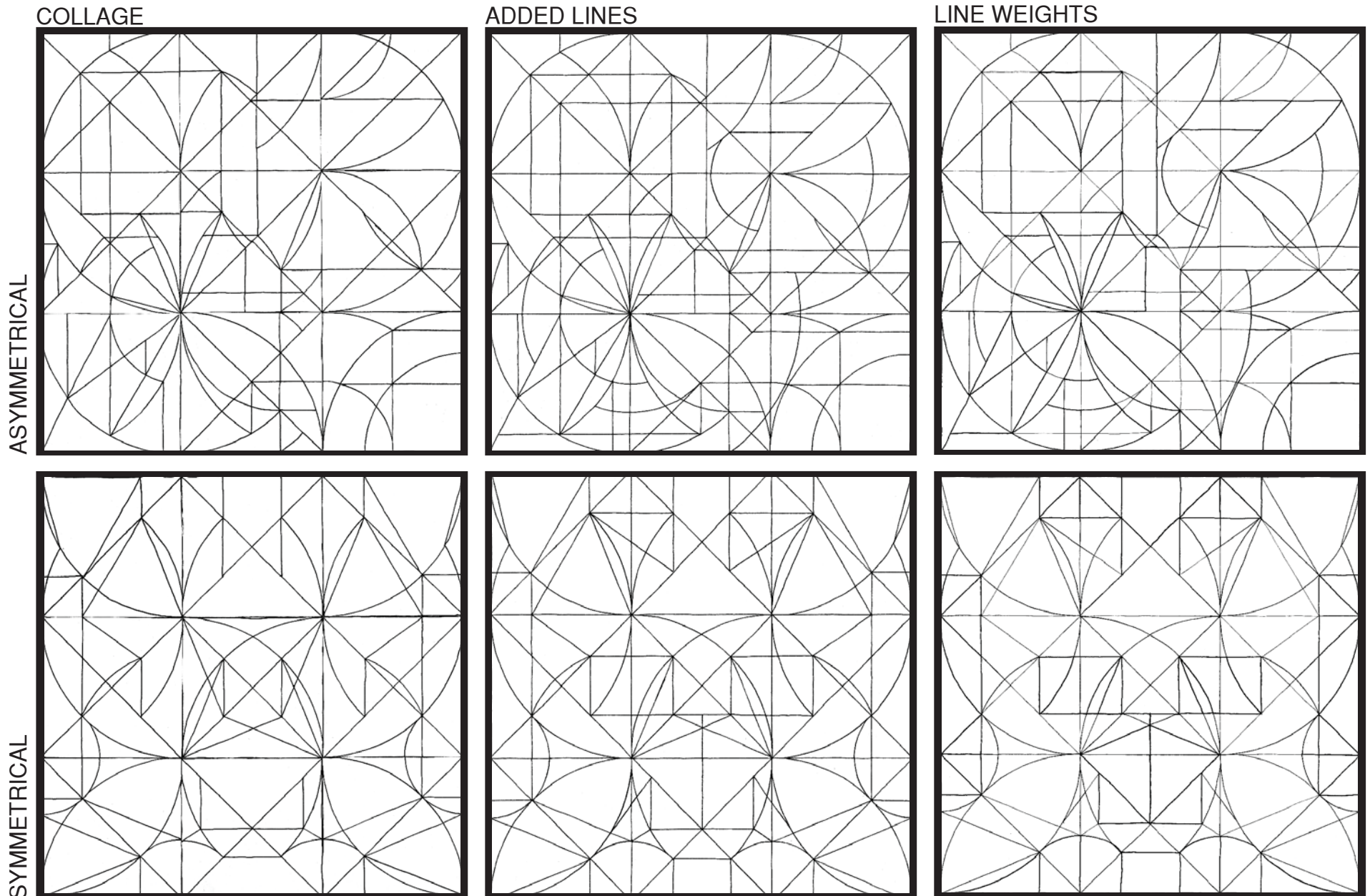

ASYMMETRICAL

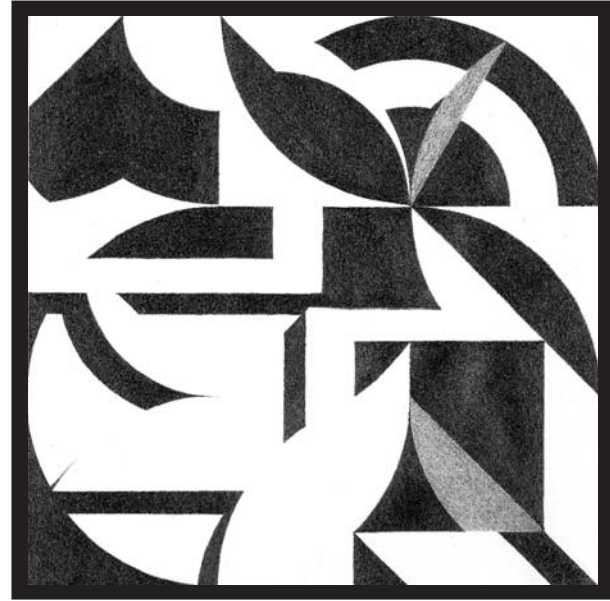

SYMMETRICAL

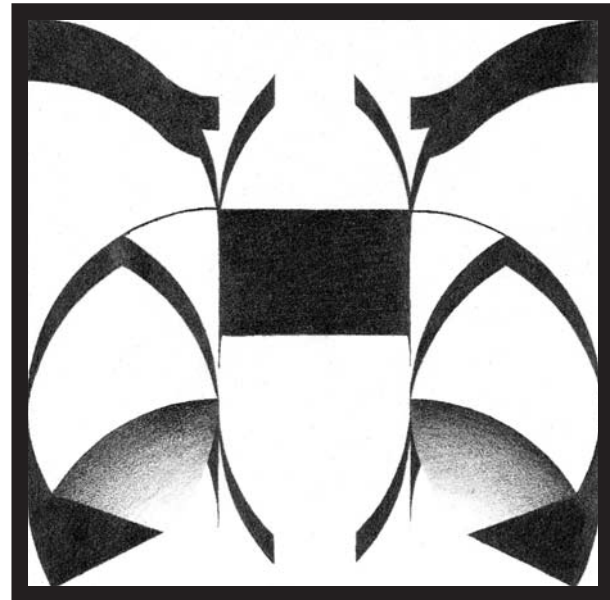
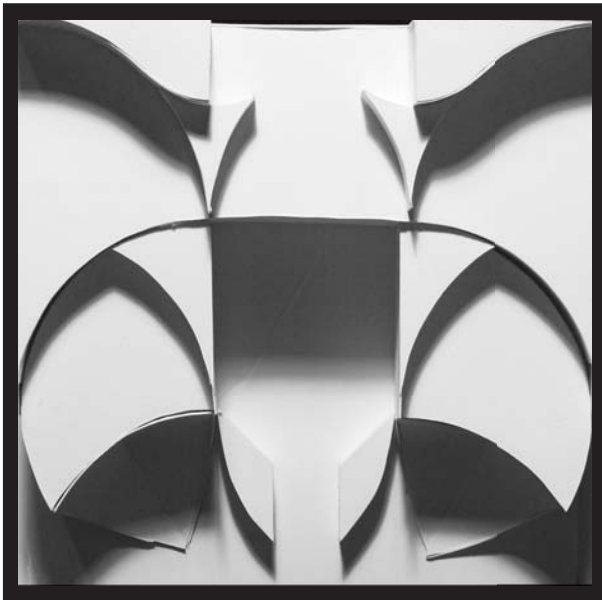

COMMUNITY GATHERING SPACE

ARCHITECTURE 1131

SUMMER 2016

Objective: Design an entry zone, path and flexible space for students and faculty to gather.

Solution: Generate tension and curiosity at the entrance, slowly relieve visitors as they travel through the path until they reach an open space where they can relax.

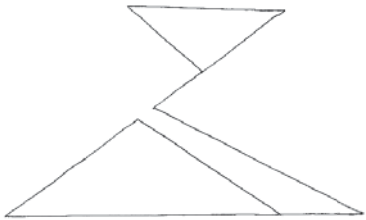

CONCEPT DIAGRAM

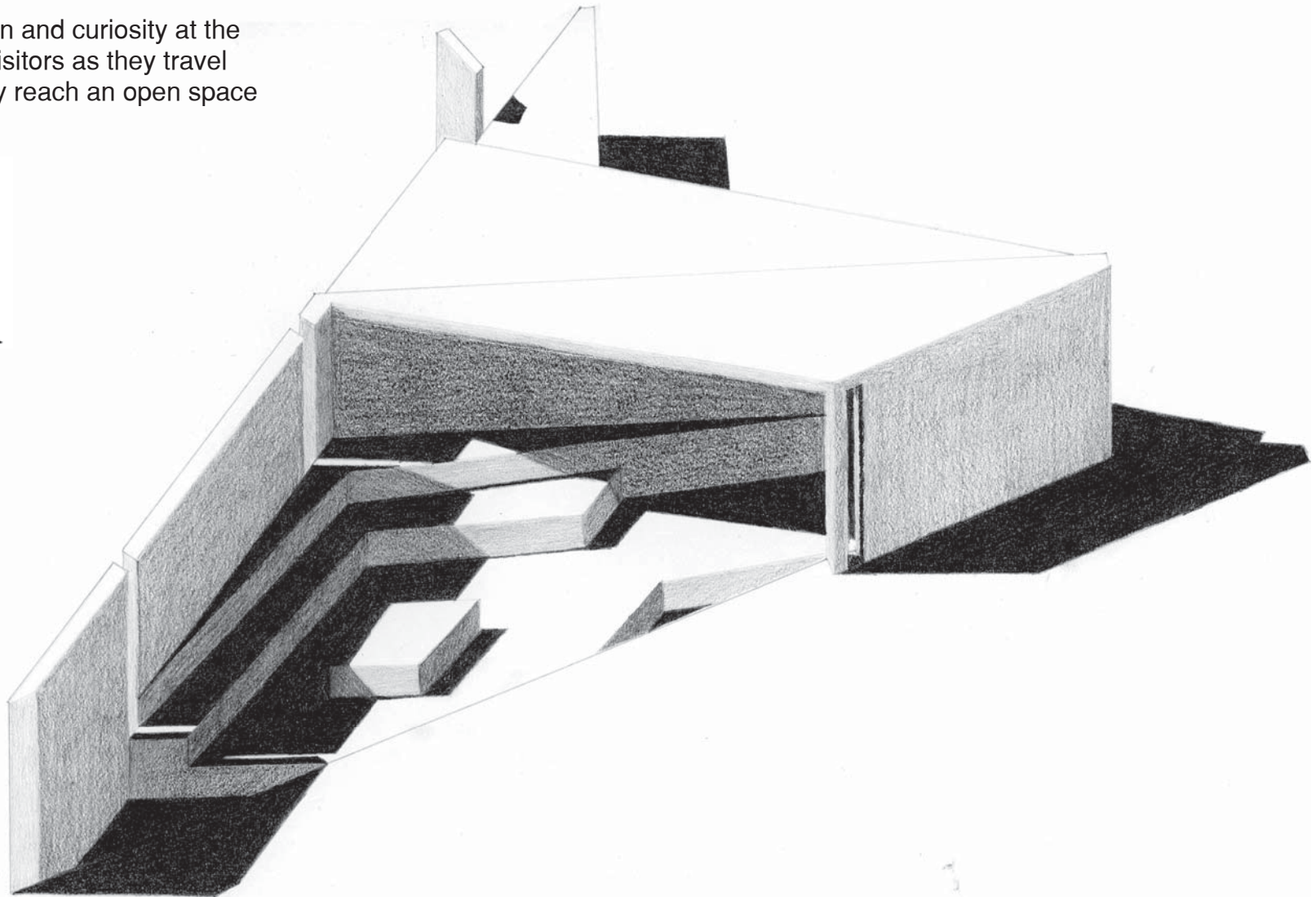

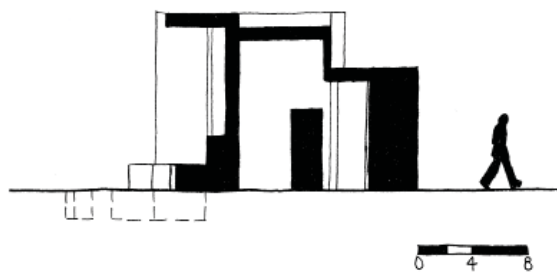

SECTION

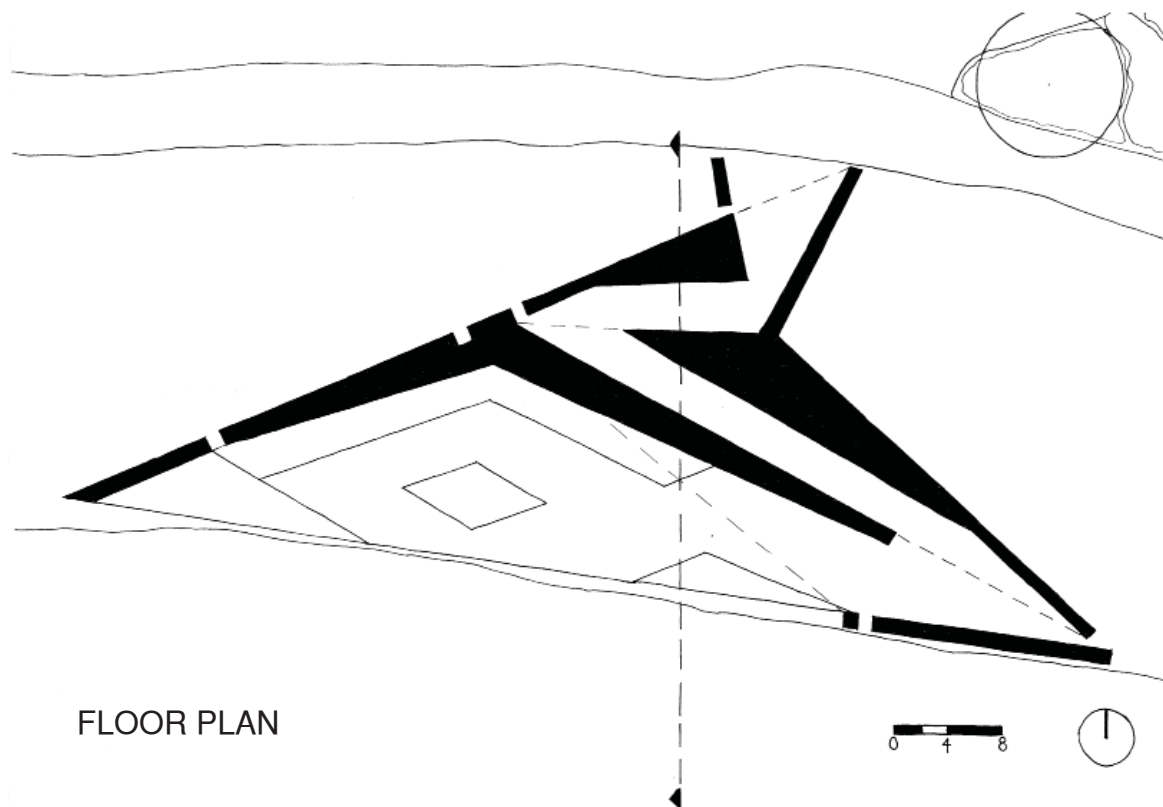

FLOOR PLAN

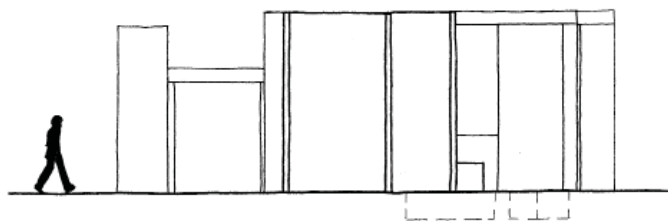

WEST ELEVATION

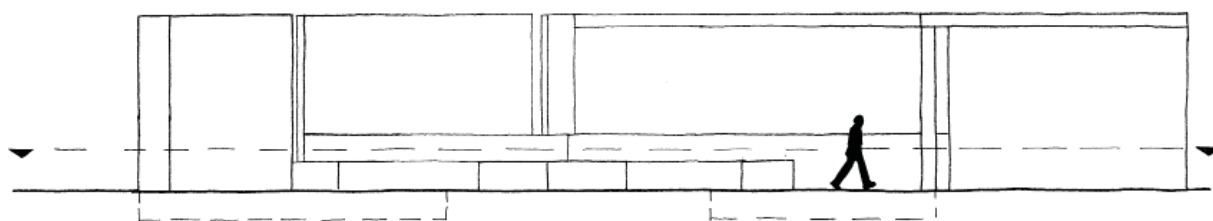

SOUTH ELEVATION

SPATIAL SEQUENCE

ARCHITECTURE 1131

SUMMER 2016

Objective: To create three gathering spaces in a park setting, that represents spring, summer and fall, using a kit of parts.

Solution: Highlight the natural flow and beauty of the seasons through a series of changing elevations.

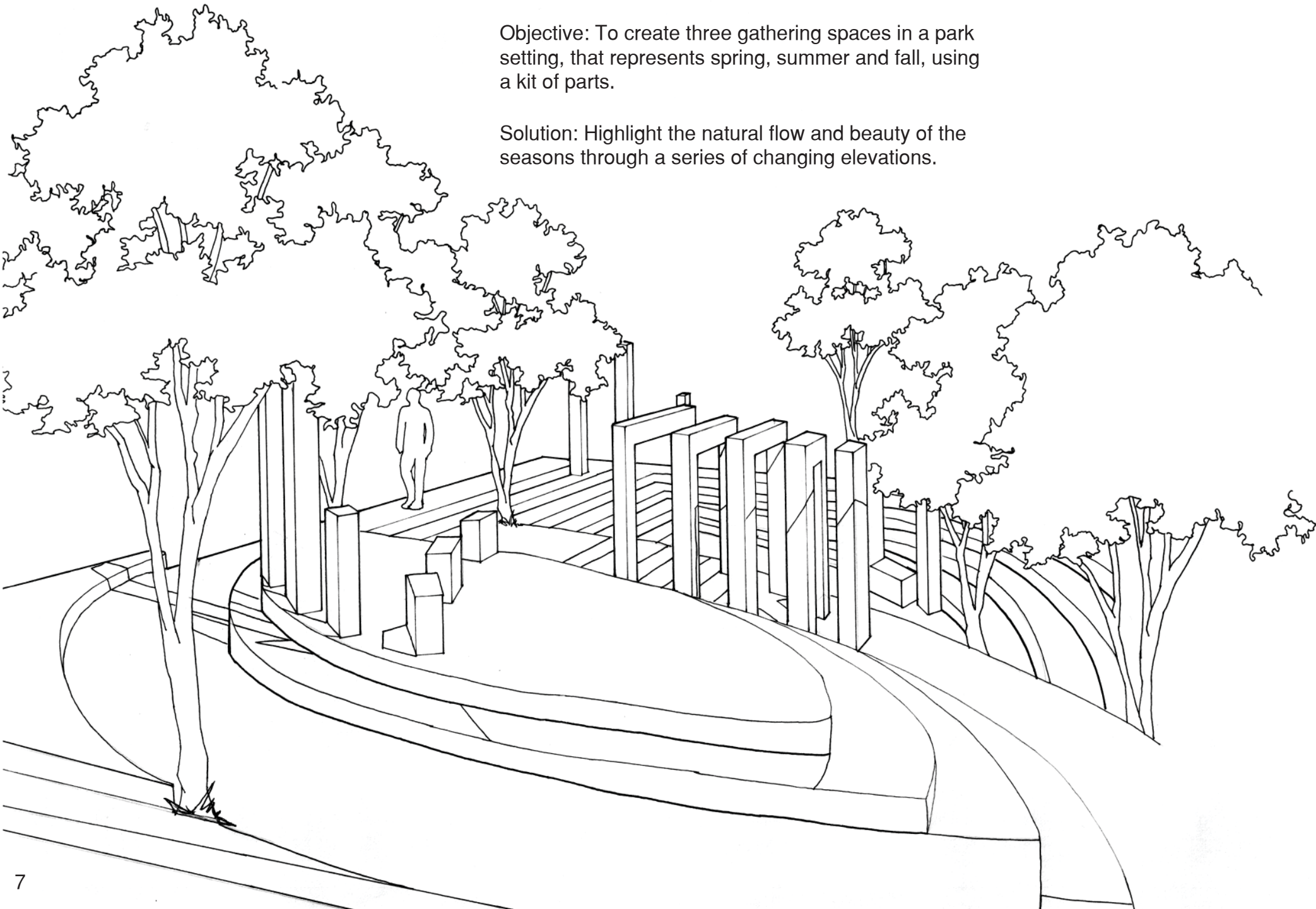

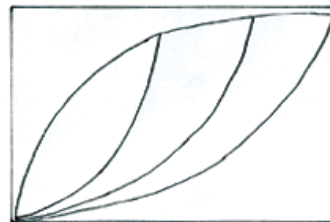
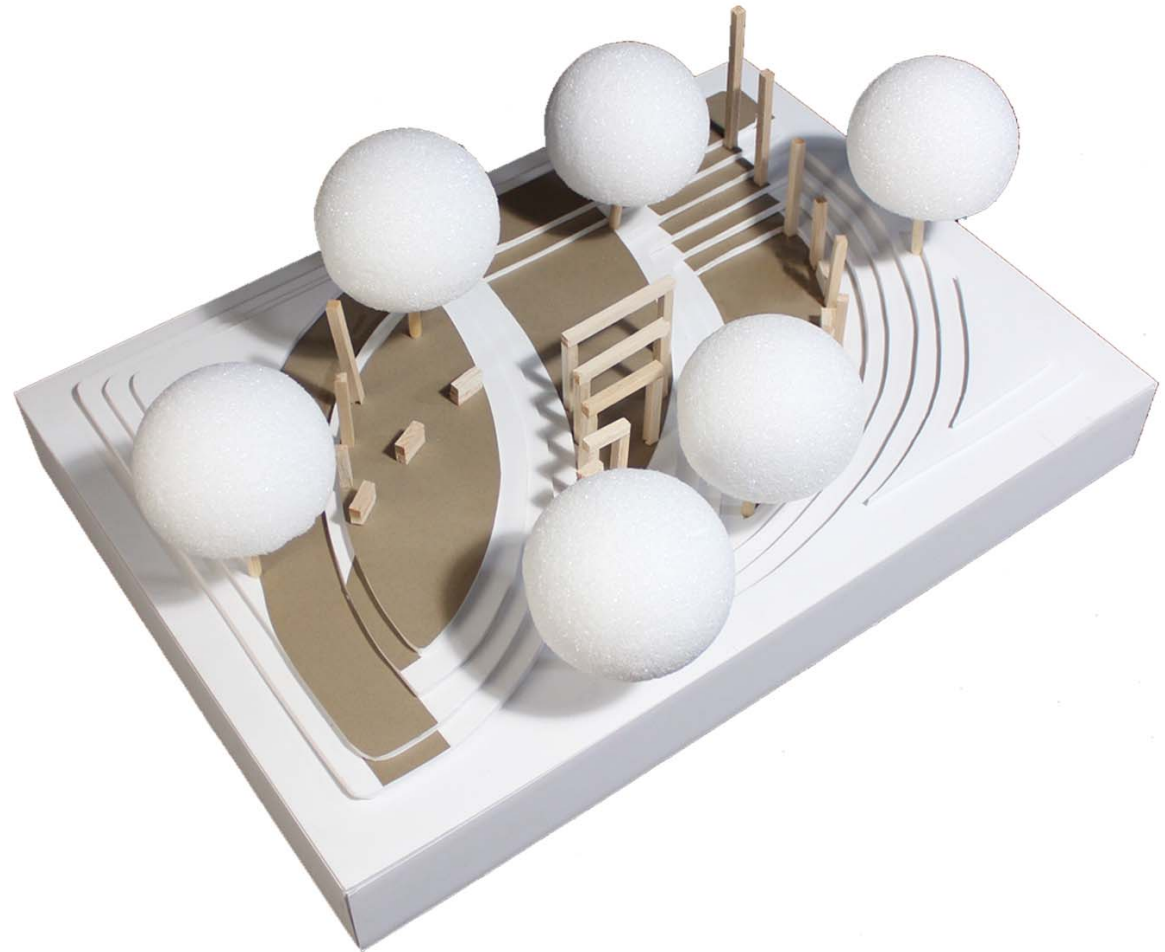
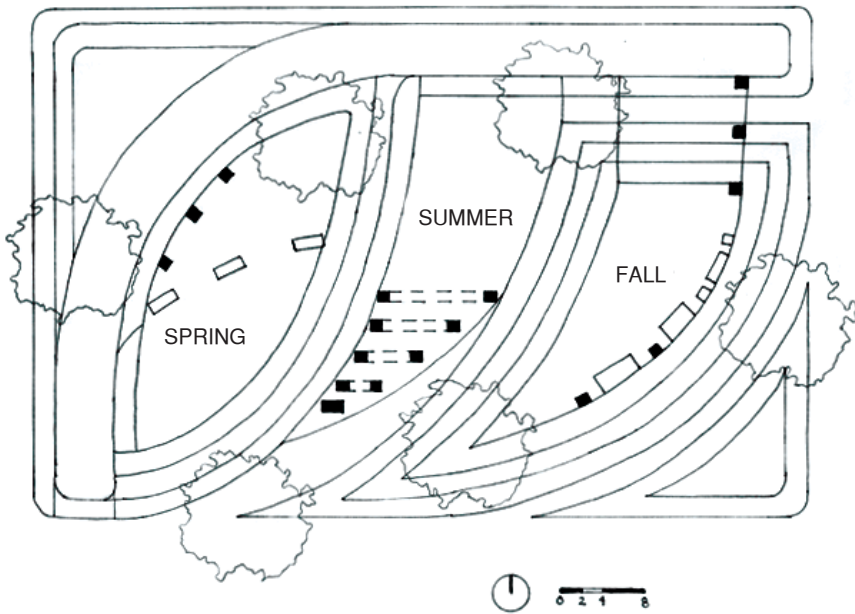

ORGANIZATION

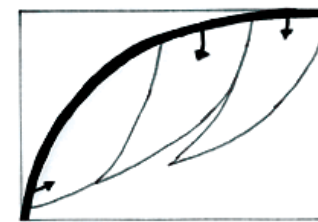

CIRCULATION

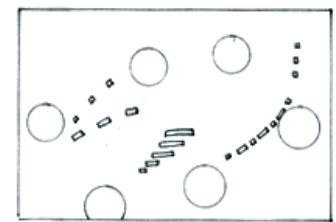

ELEMENTS

NATURE OF MATERIALS

ARCHITECTURE 1131

SUMMER 2016

Objective: To create an abstract sculpture to express an architect's concept for a specific building using concrete, metal, wood and glass.

Solution: Researched Peter Zumthor's Therme Vals and how he blended the line between landscape and architecture. The wood represents the building imitating the natural landscape and the importance of framing views. The wooden box is tilted to imitate a mountain, and to encourage viewers to wander around the sculpture in order to see through it. The glass represents the pools that exist in the Bath House. The aluminum represents the skylights that separate the units within his design. The concrete represents the natural locally sourced stone that Zumthor used throughout his design.



arcspace.com

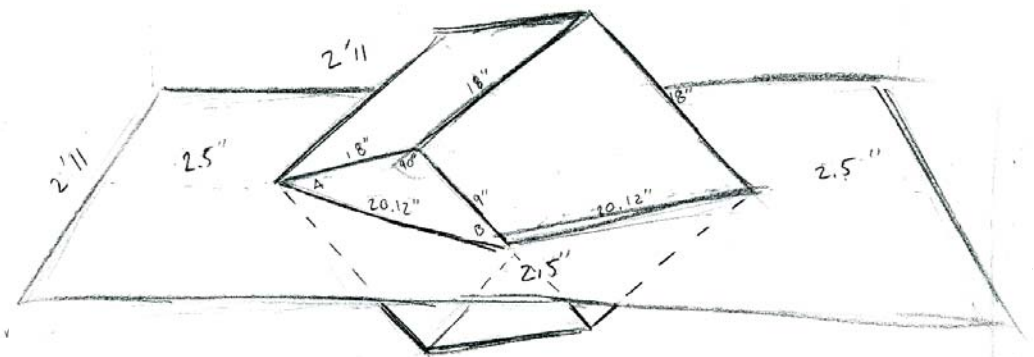
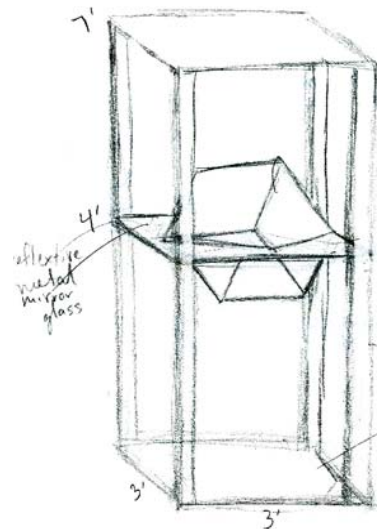
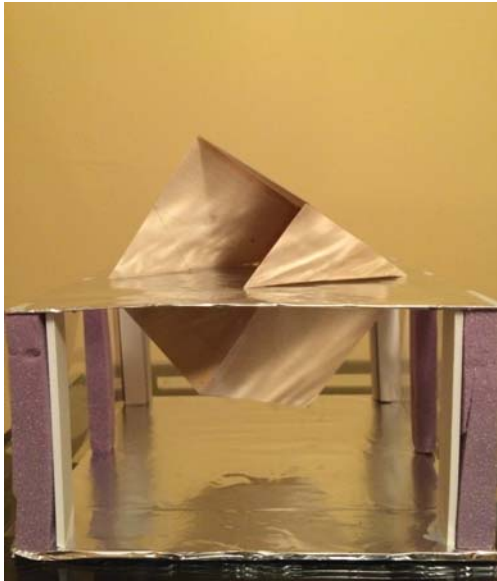

"... a bath born of the mountains, just like the hot springs are born of the mountains, so that gives us the feeling that this building has always been there, before all the others." (Peter Zumthor, Les Thermes De Pierre.)

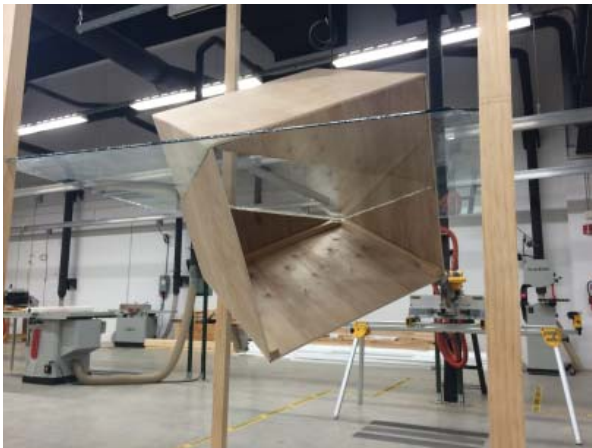
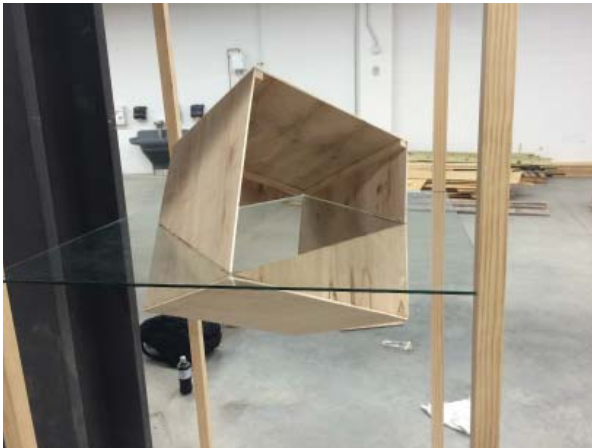
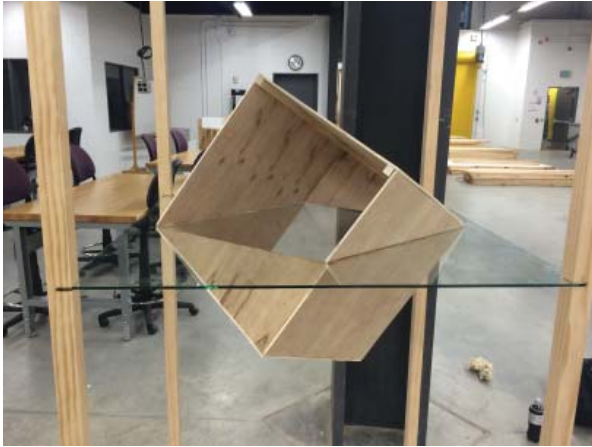

INSPIRATIONS COLLAGE

ARCHITECTURE 2201

FALL 2016

Objective: To use photography and sketches to show inspiration from cities. Then intergrate those photographs and sketches into an abstract sculpture representing cities.

Solution: Focus on how cities are formed and organized. The white museum board represents the natural environment as well waves of people coming together with their pure ideas and dreams for cities. The photographs, sketches and basswood represent conflict and growth that occurs when these various plans try to work together.

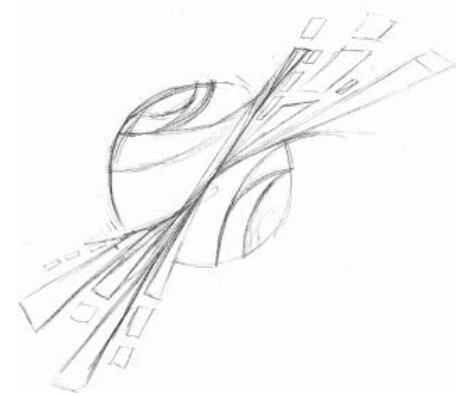

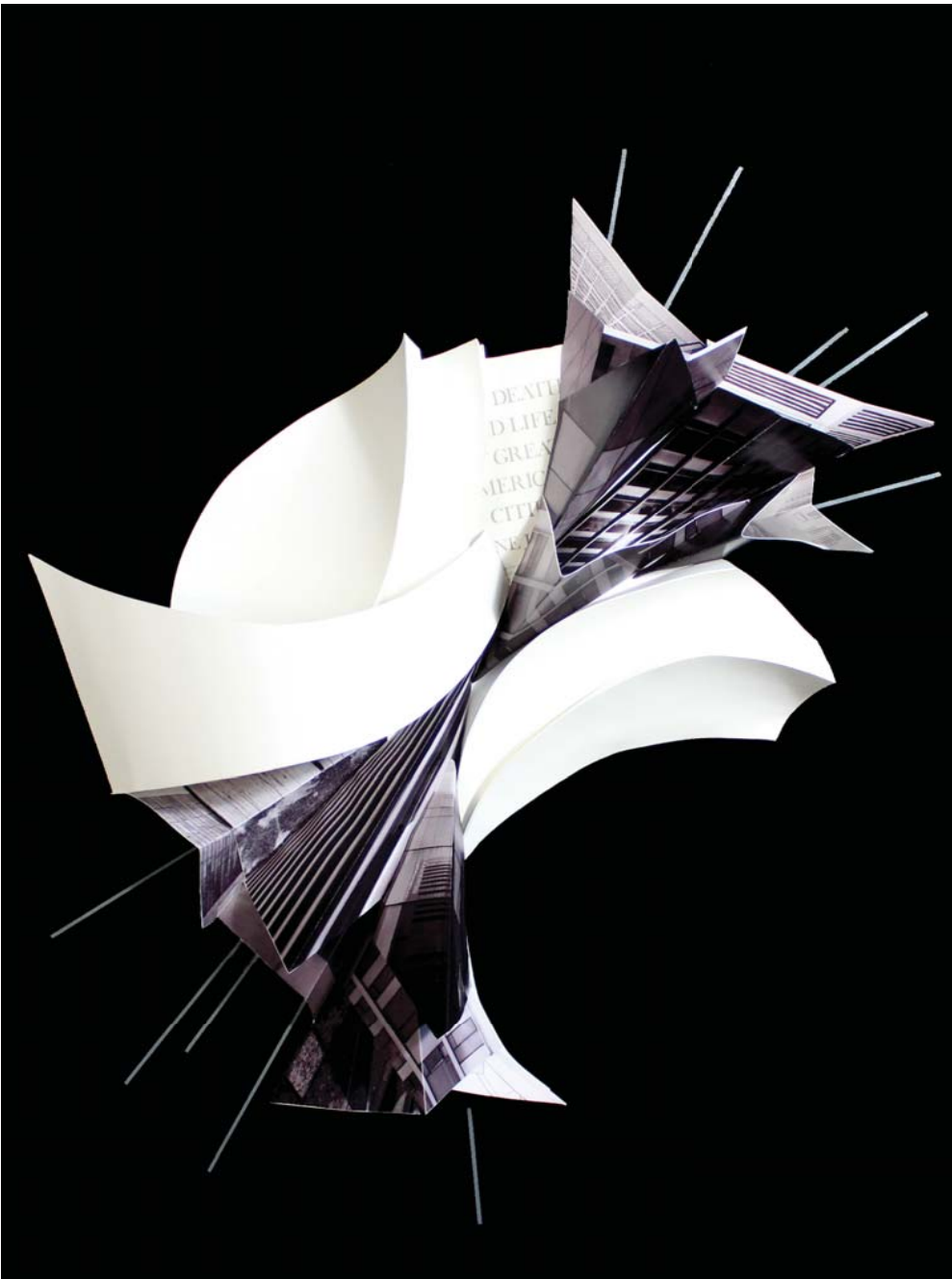
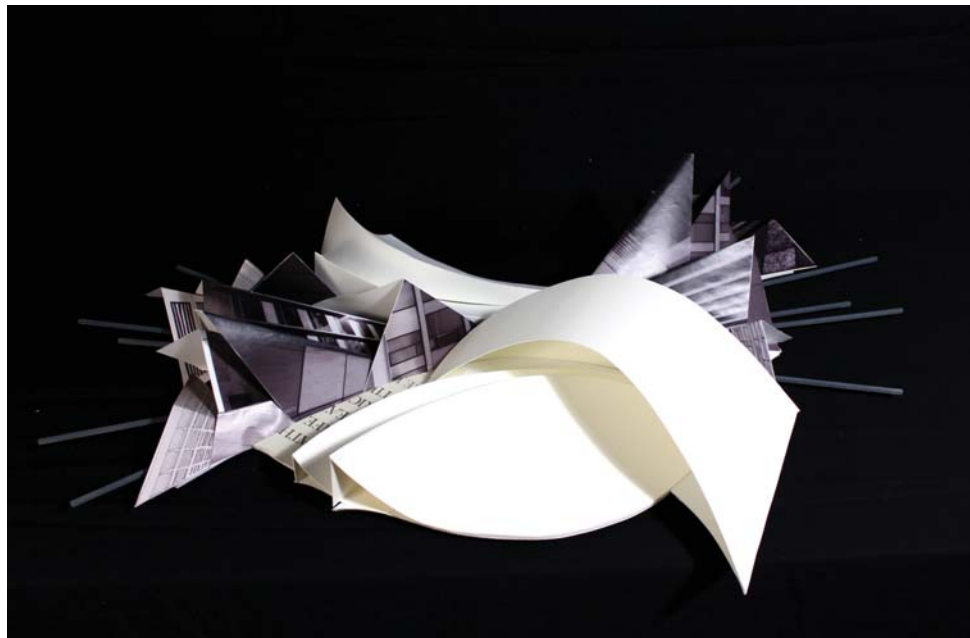

Objective: Design an ecology center along Lake Shore Drive in Chicago, Illinois. The ecology center should include an exhibit, two classrooms, a lab, cafe and office space.

Solution: Highlight the different characteristics of water and how they contrast each other through layering circulation patterns that vary in complexity.

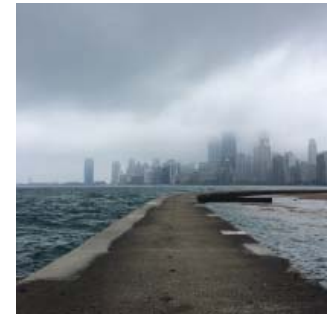

SITE ANALYSIS



Traffic



Noise



Lines of Sight

SITE PLAN



PROCESS

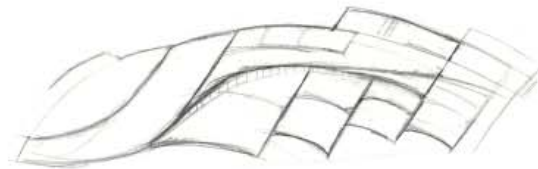

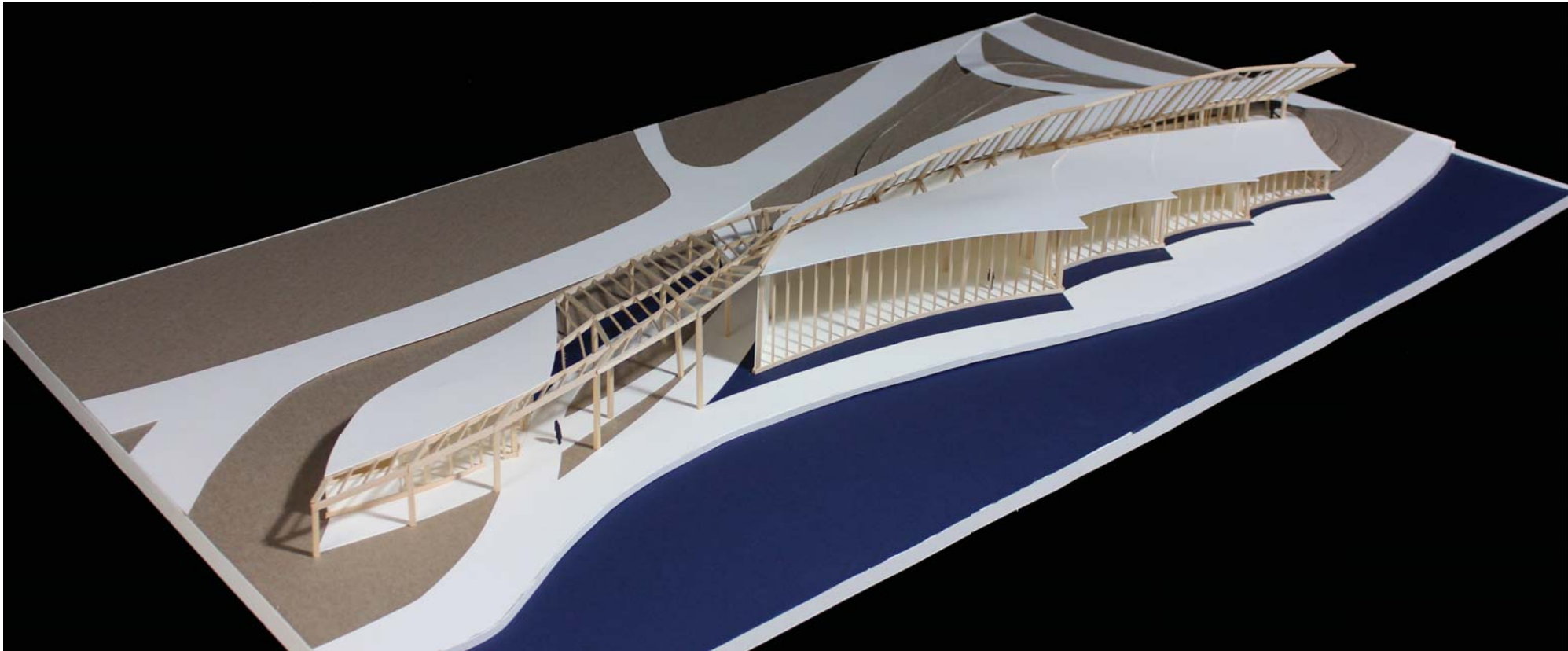
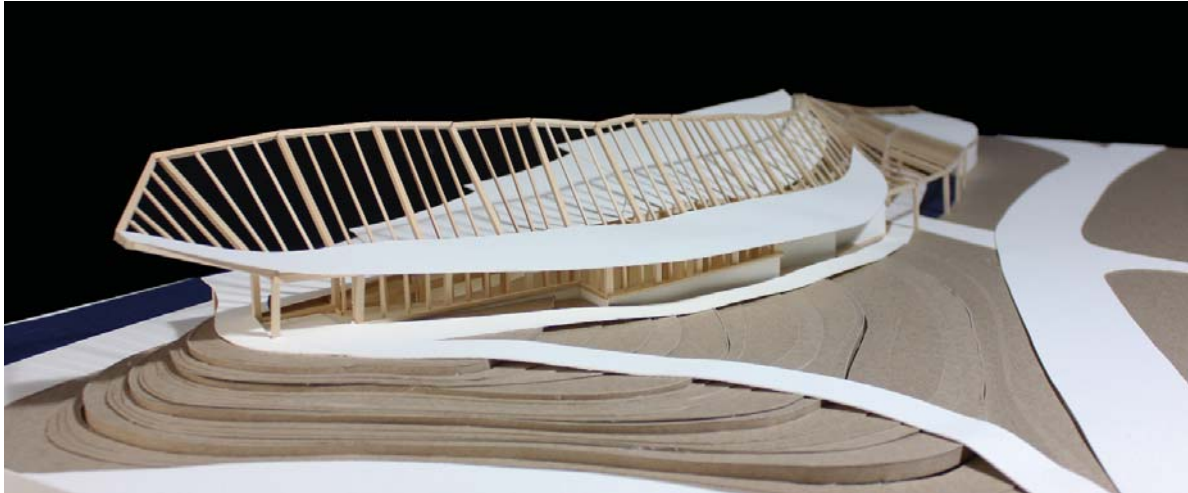

ECOLOGY CENTER

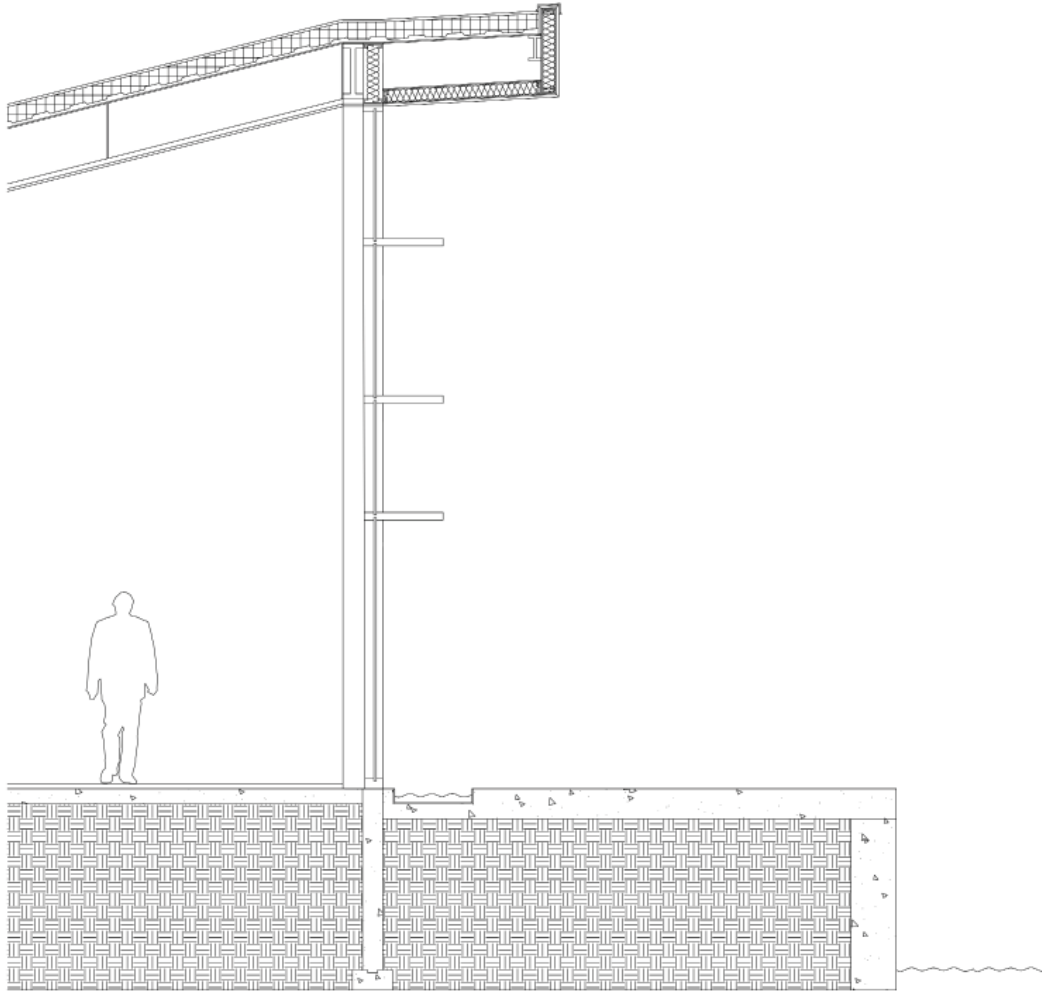

DETAILED SECTION

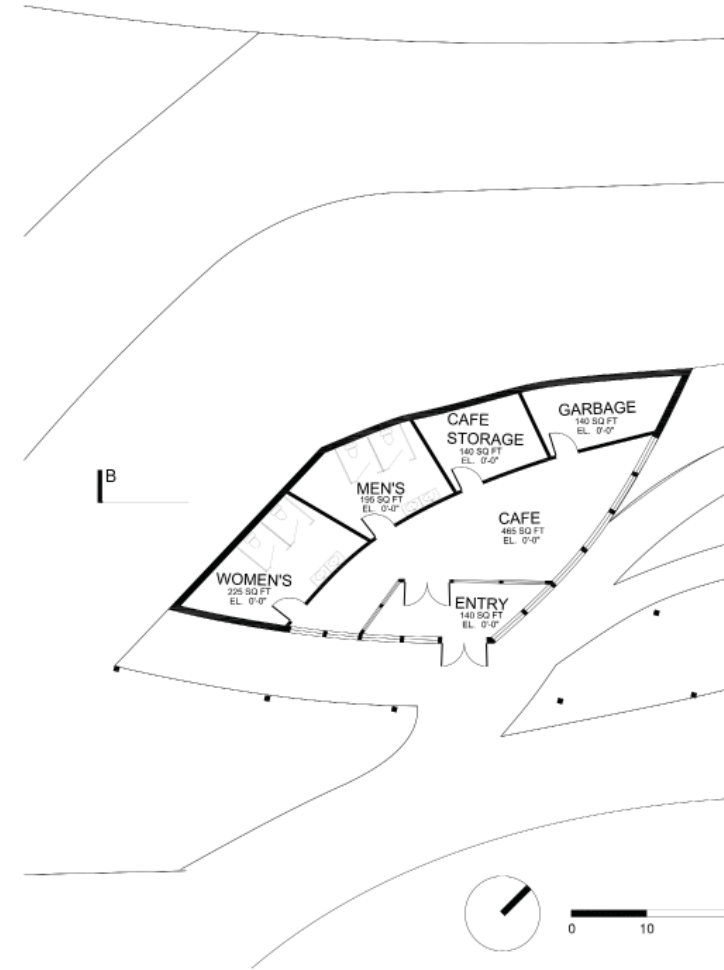

SECTION B

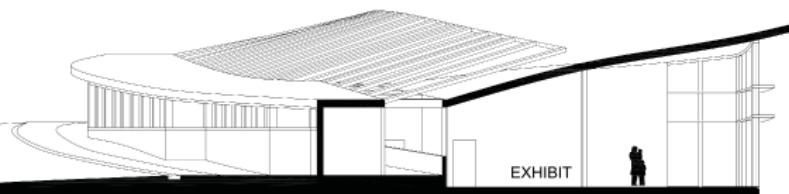

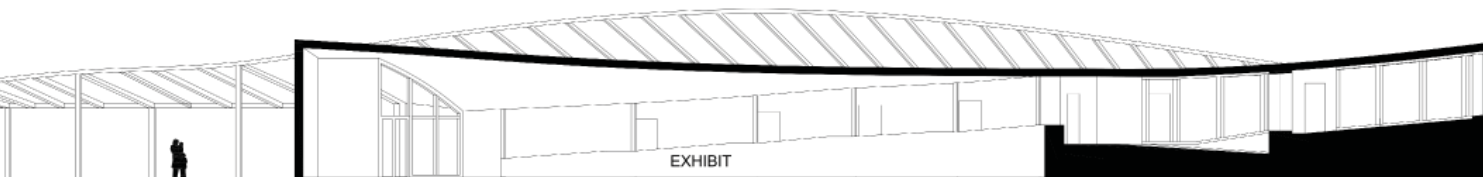
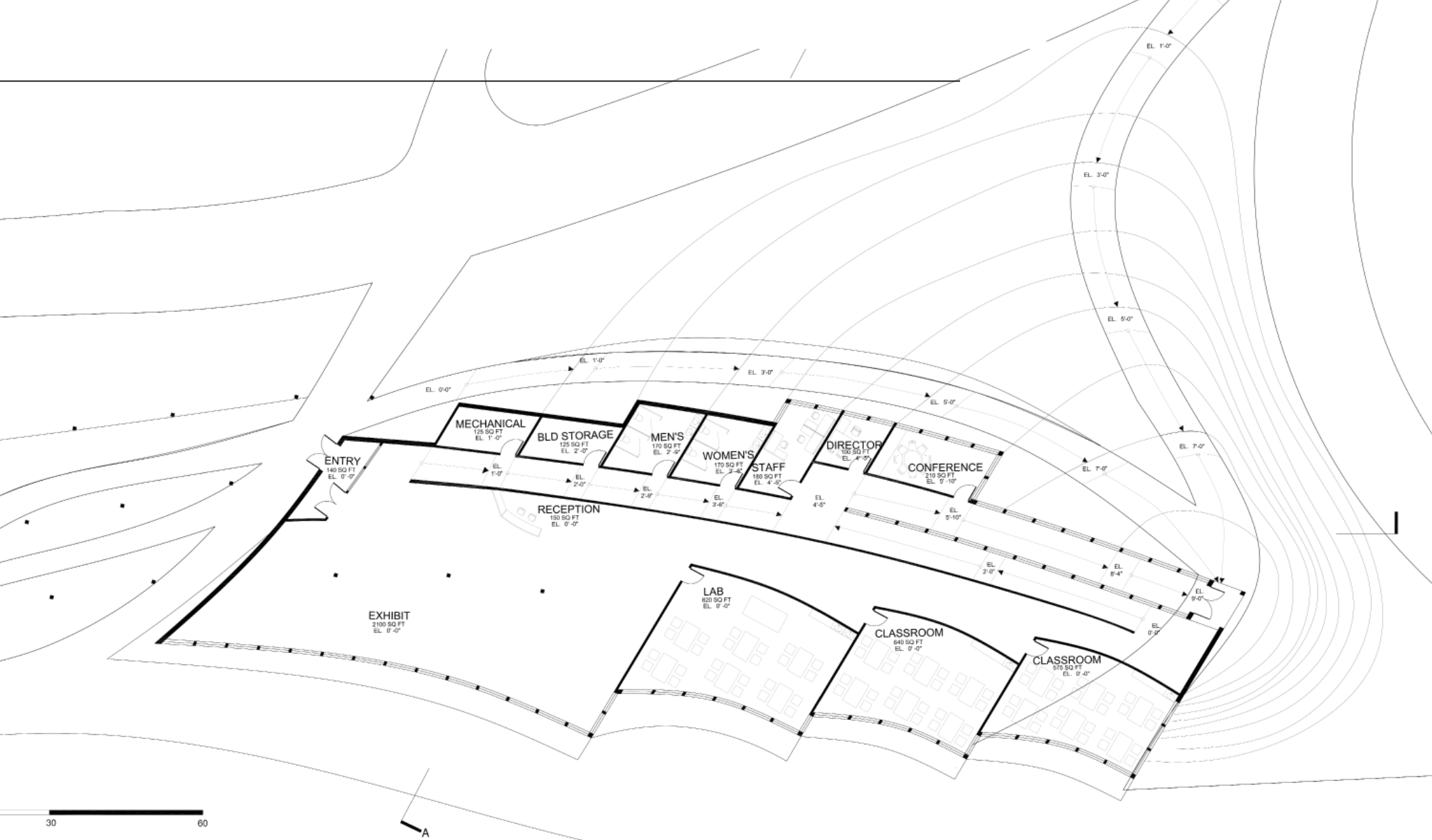

PERSONAL WORK



Study of Photograph
Pen on bristol
9x12 in

Study of Photograph
Graphite on bristol
9x12 in



PERSONAL WORK

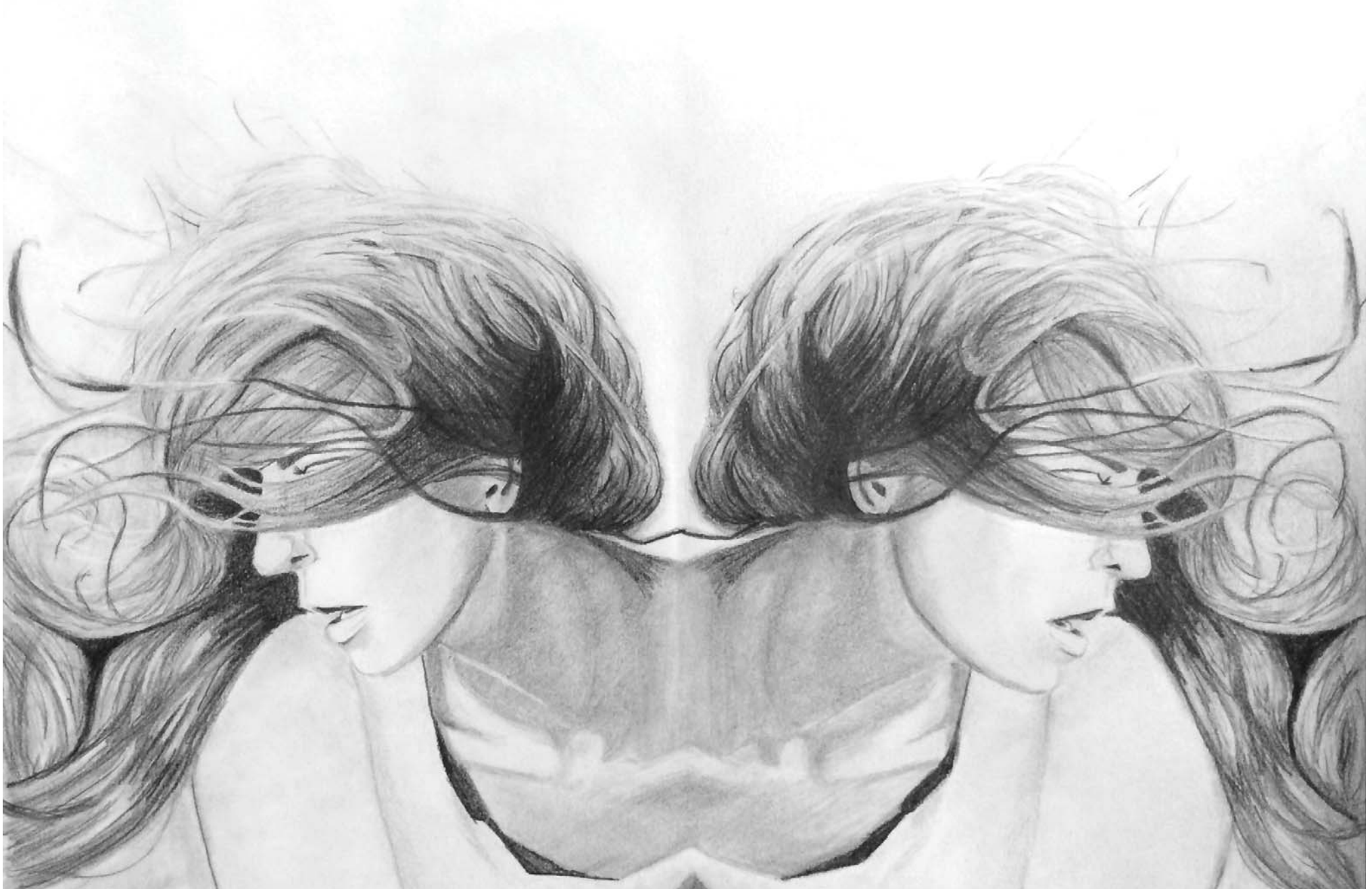

Study of Photograph, then mirrored image
Graphite on bristol
9x12 in



"Untitled"
Charcoal on bristol
18x24 in

PERSONAL WORK



Study of Photograph
Oil on Canvas
18x24 in

Study of Photograph
Graphite on bristol
9x12 in

