

JONATHAN GUTTELLO

PORTFOLIO

COLLEGE OF DUPAGE

Table of Contents

3-4	Figure Drawing	Self Taught
5-6	Perspective Journey	Course Architectural Design Communication
7-8	Still Life	Duration 16 weeks Semester Fall 2017
9-10	Barcelona Pavilion	Professor Jane Ostergaard Course # ARCH 1121
11-12	Assemblage, Hierarchy, and Form	Course Intro to Architectural Design
13-14	Nature of Materials	Duration 16 weeks Semester Spring 2018
15-16	Spatial Sequence	Professor Jane Ostergaard Course # ARCH 1131
17-18	Inspirations Collage	Course Architectural Design I
19-20	Precedent Study	Duration 16 weeks Semester Fall 2018
21-26	Ecology Center	Professor Mark Pearson Course # ARCH 2201
21-22	Intro	
23-24	Process	
25-26	Orthographics	
27-30	Light Wall	Course Architectural Design II
27-28	Intro	Duration 16 weeks Semester Spring 2019
29-30	Process	Professor Mark Pearson Course # ARCH 2202
31-36	Gridlock	
31-32	Intro	
33-34	Process	
35-36	Renderings	
37-38	Orthographics	
39	Structural Stability	Course Structural Systems
		Duration 16 weeks Semester Fall 2018
		Professor Jane Ostergaard Course # ARCH 2230

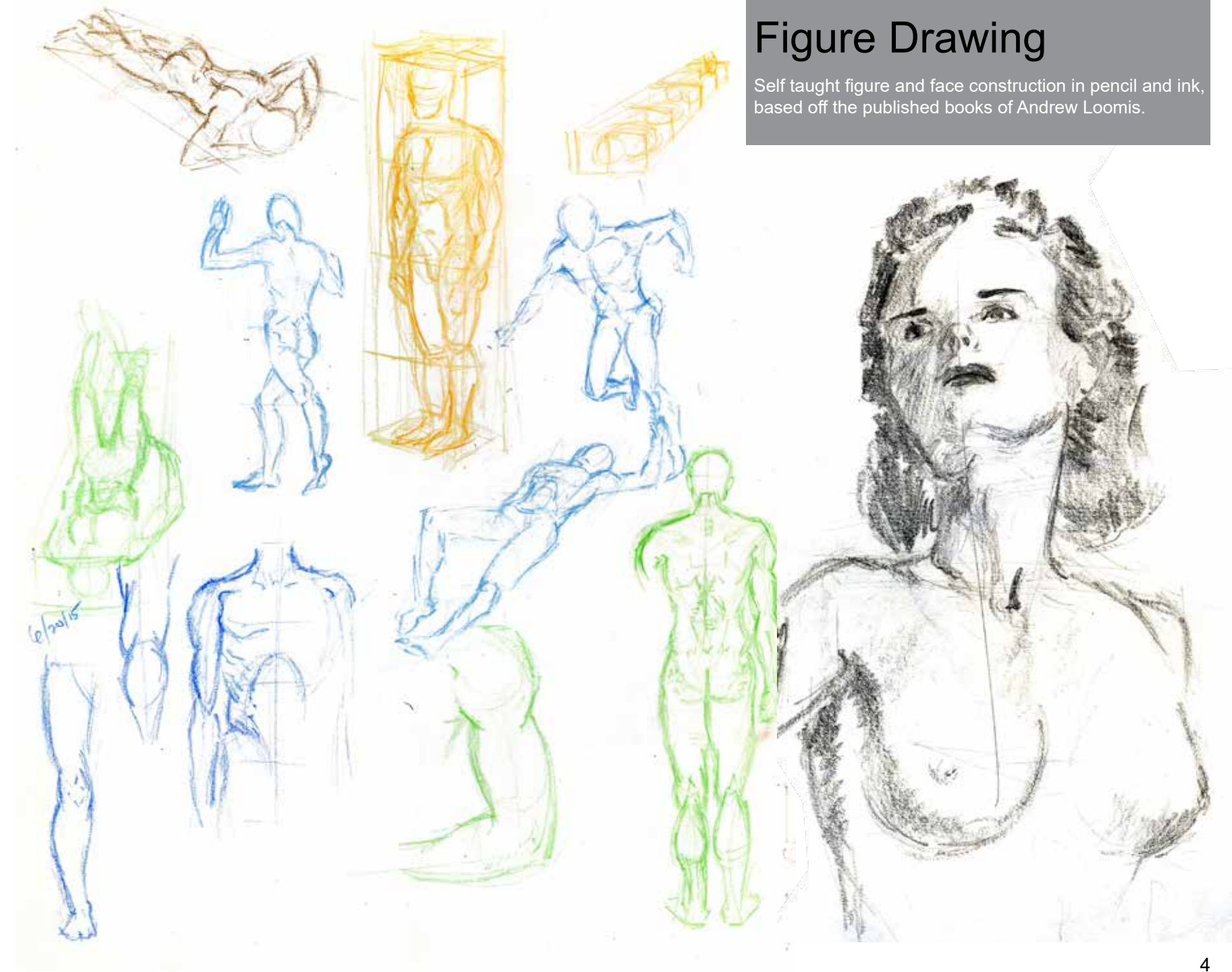

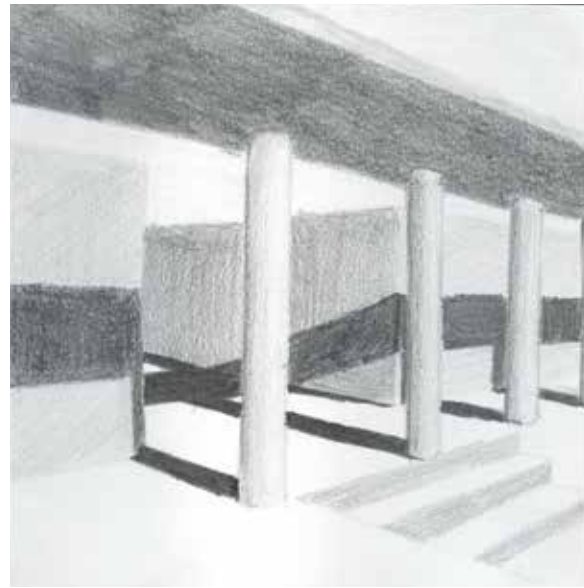
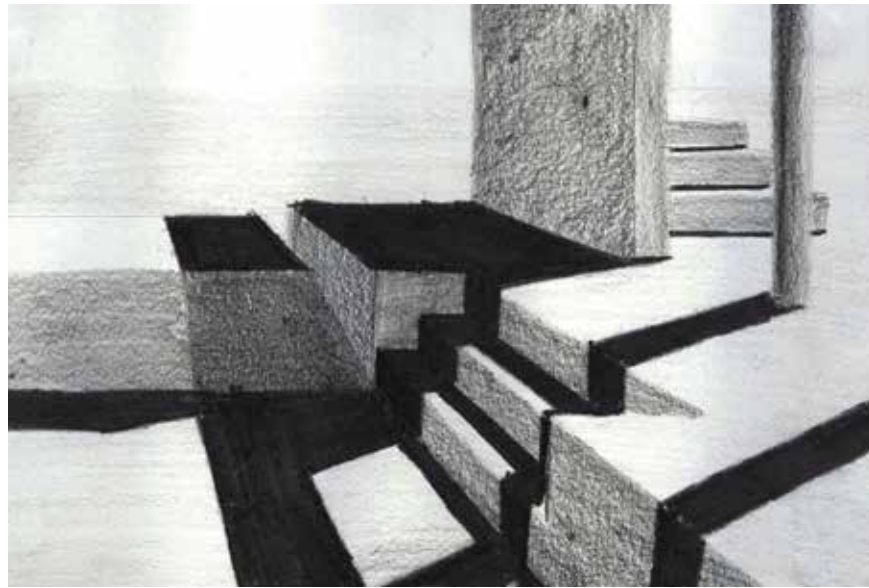
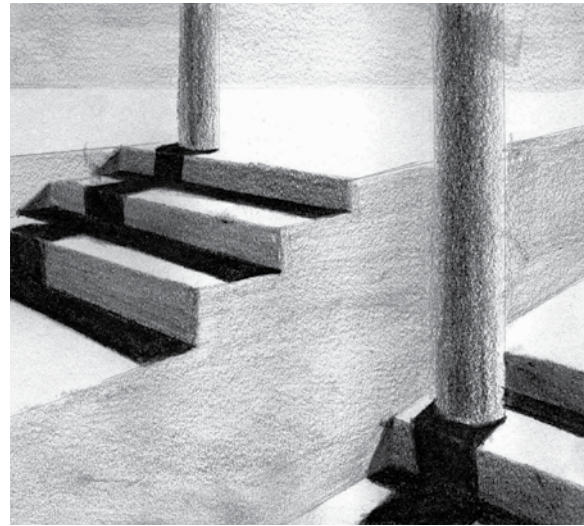
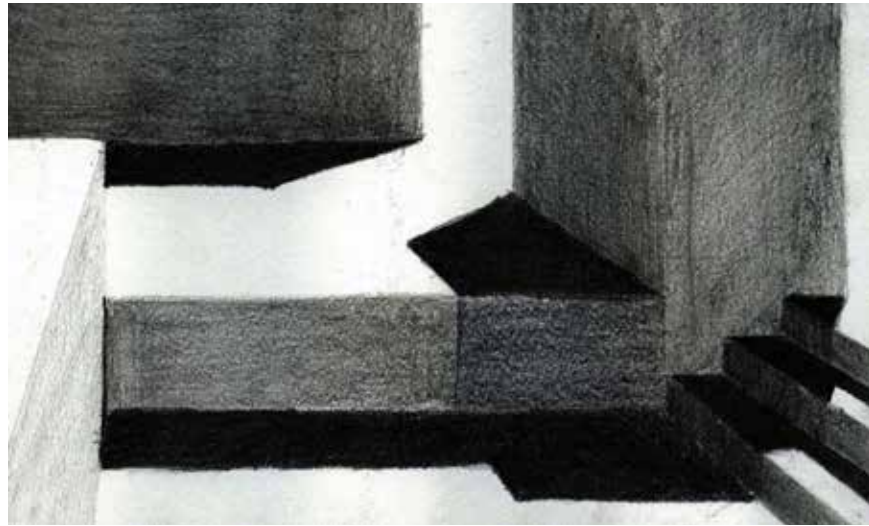

Perspective Journey

Course Architectural Design Communication
 Duration 2 weeks Semester Fall 2017
 Professor Jane Ostergaard Course # ARCH 1121

Description: Compose compelling perspectives with basic architectural elements; stairs, columns, planes by using vanishing points. Then create accurate shadows using the same rules that follow perspective to help express the essence of the space. Finally, take one of the most compelling views and create a model based off the drawing.

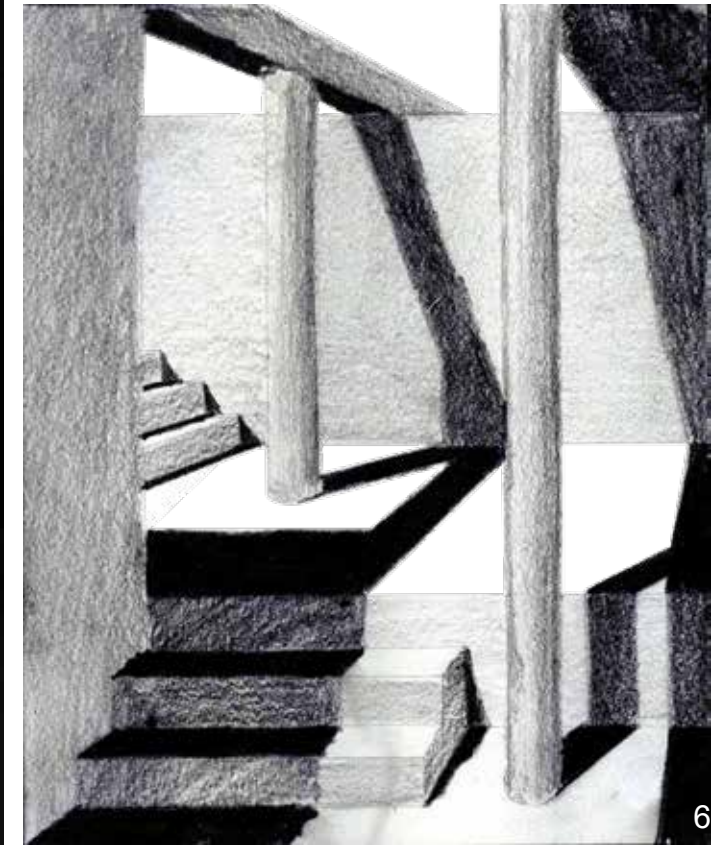
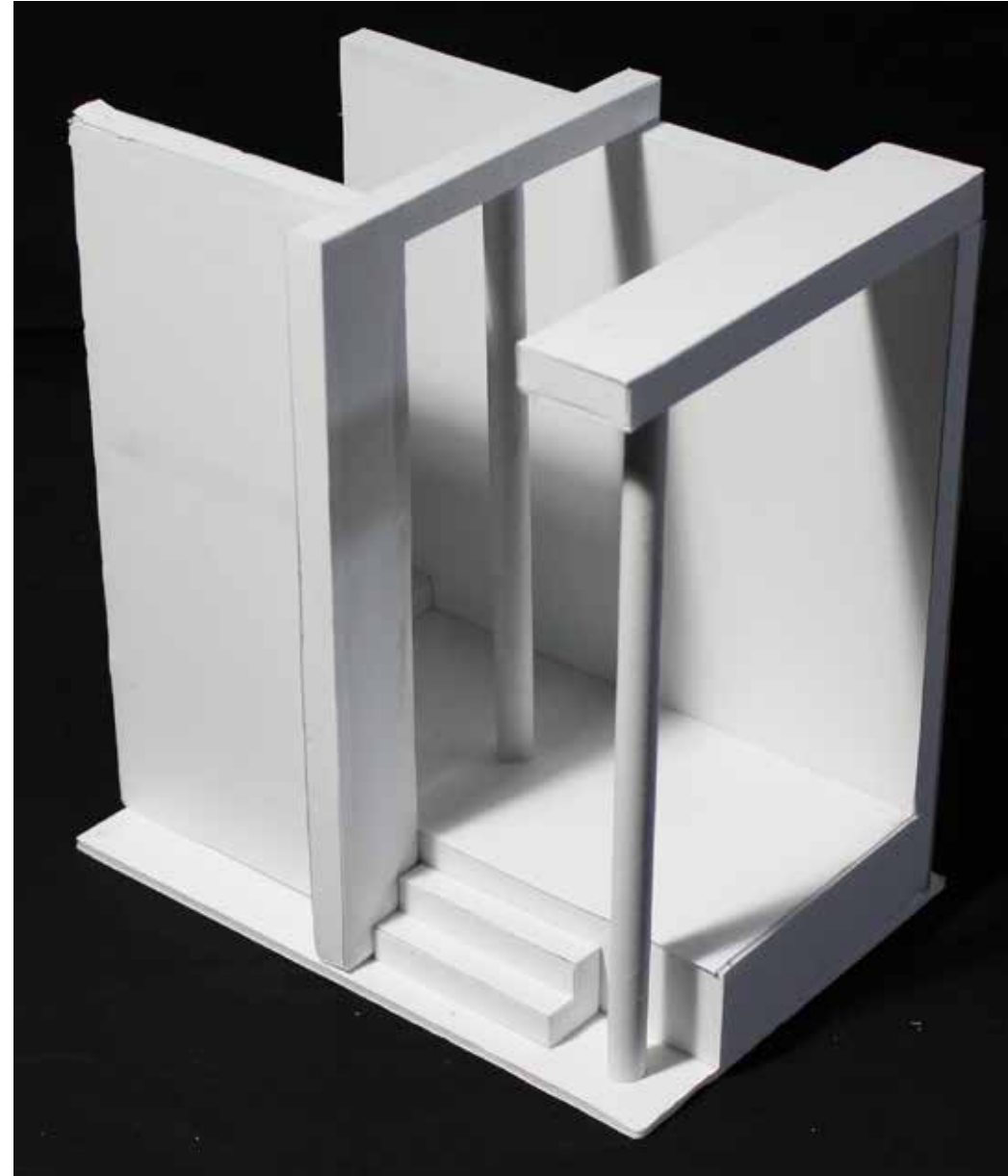

Still Life

Course Architectural Design Communication
Duration 3 weeks Semester Fall 2017
Professor Jane Ostergaard Course # ARCH 1121

Project Description: Each student was required to construct one of each shape: a sphere, tower, cube, cone, pyramid, and a disk. Combine the shapes into a composition and create orthographic drawings (plan, section, and elevations). Sections will vary through the different shapes cut, as they were made with different materials. The shaded drawings were used as different skill building techniques.

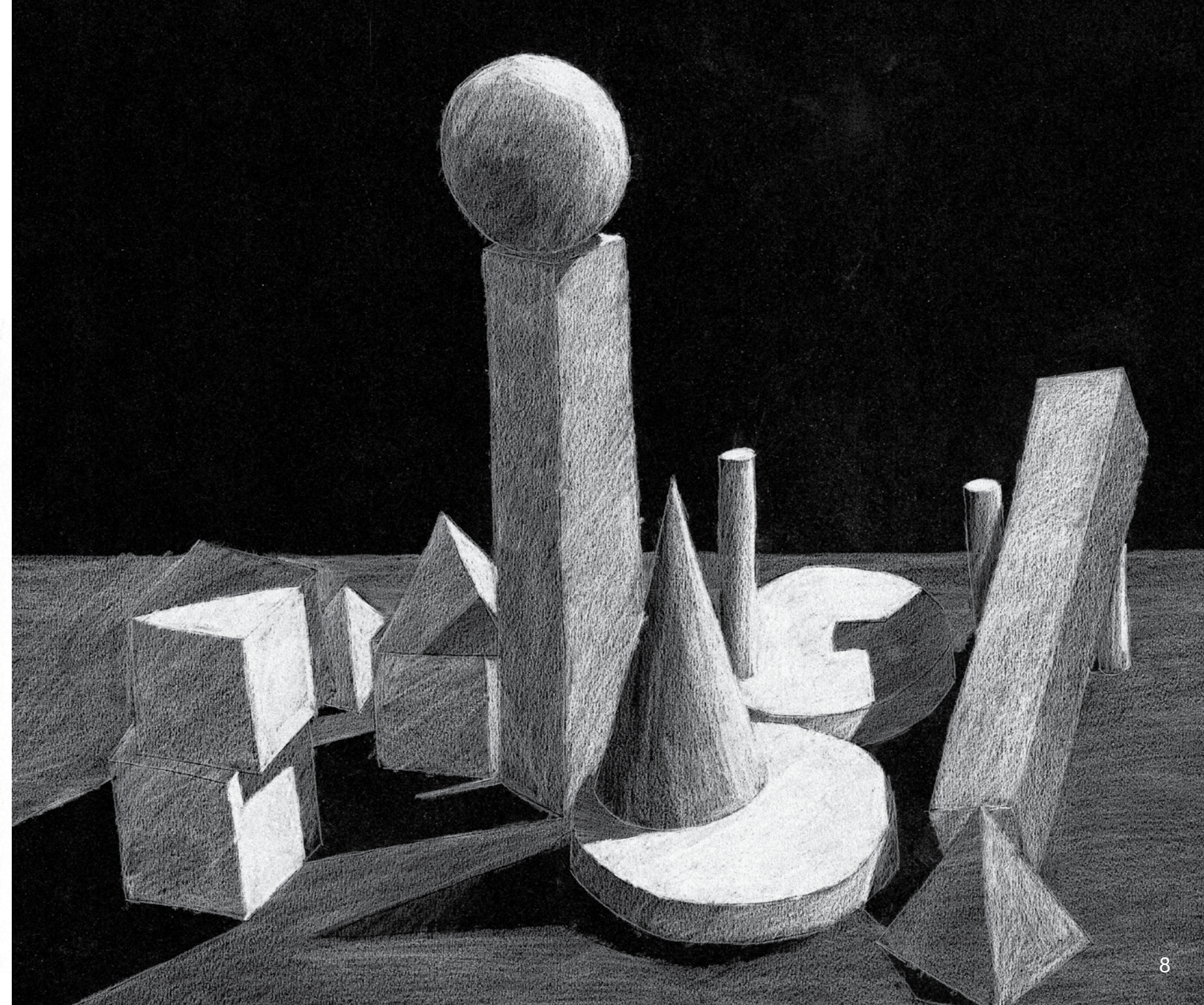
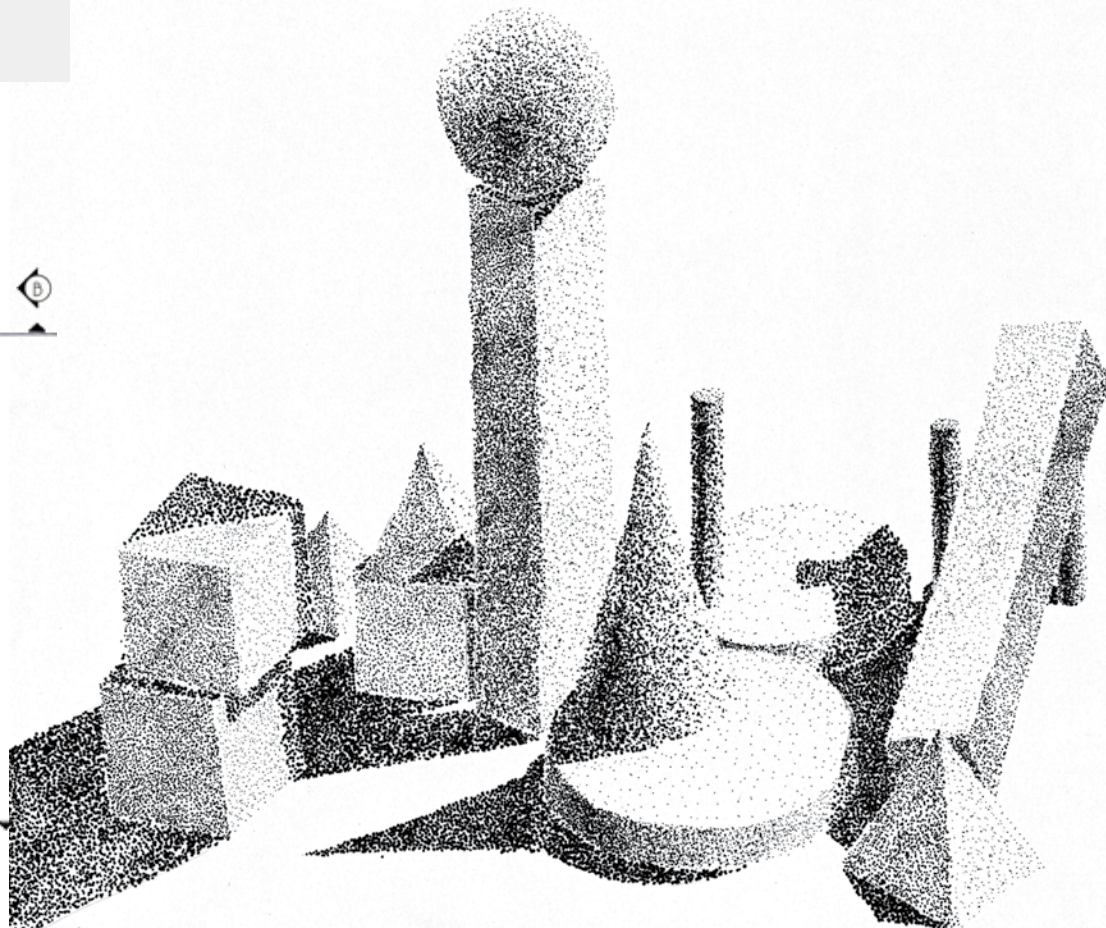
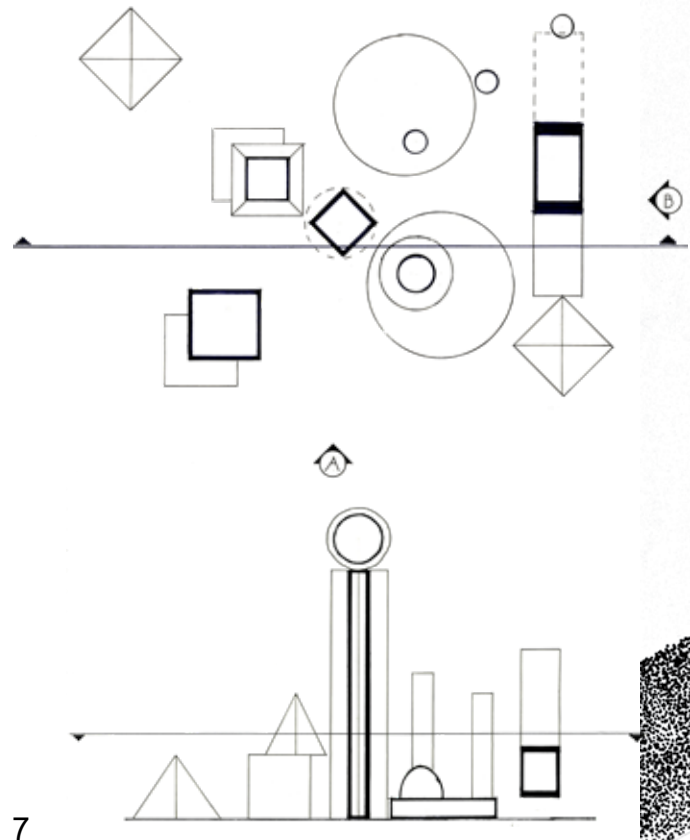

Barcelona Pavilion

Course Architectural Design Communication
 Duration 4 weeks Semester Fall 2017
 Professor Jane Ostergaard Course # ARCH 1121

Project Description: Given various floor plans of the Barcelona Pavilion, accurately recreate the pavilion in a 30/60 plan oblique and perspective, drafted in ink. Hand drawn shadows were one of the skill building techniques learned during this project. Shadows were constructed at a 45 degree angle from the verticle.

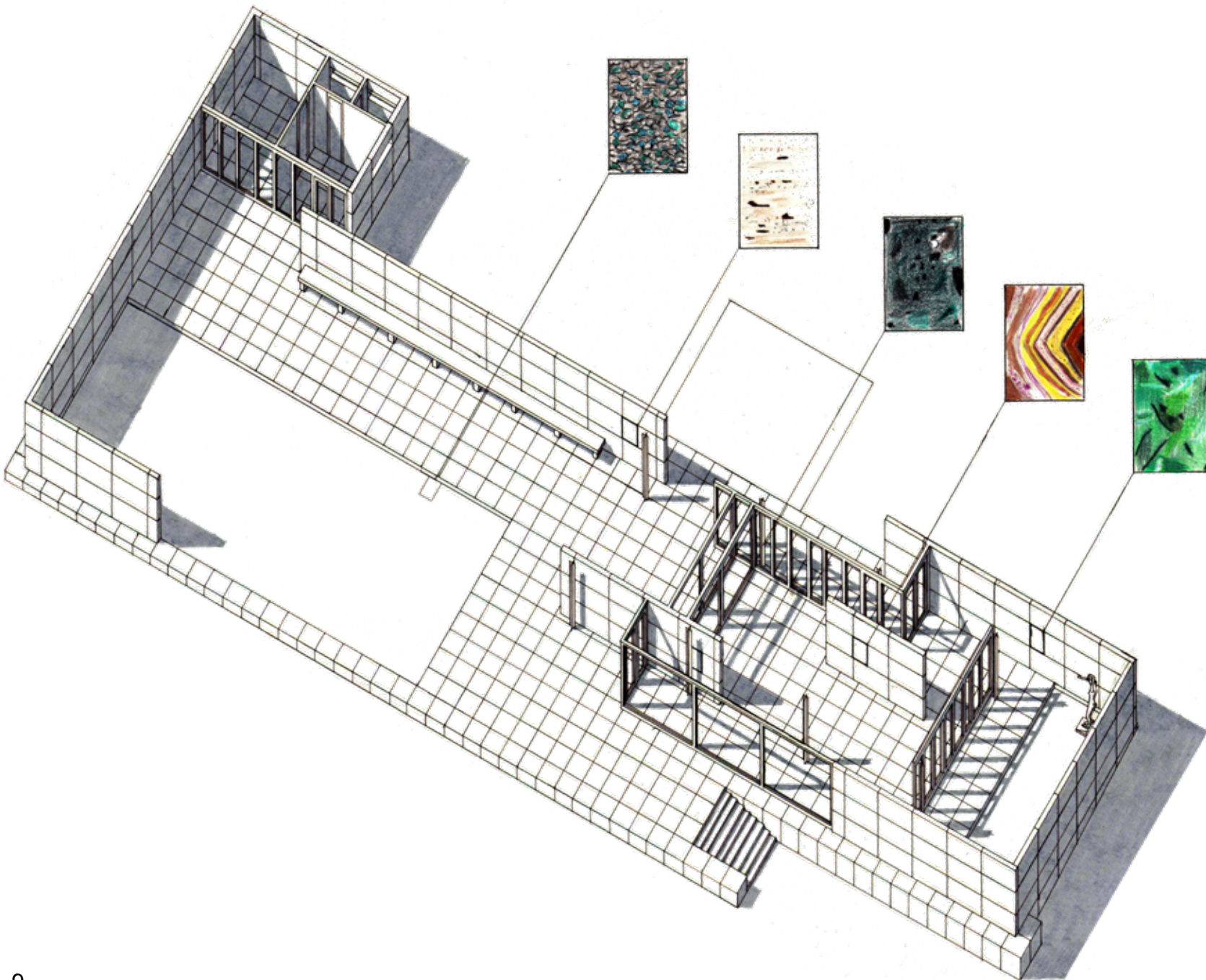
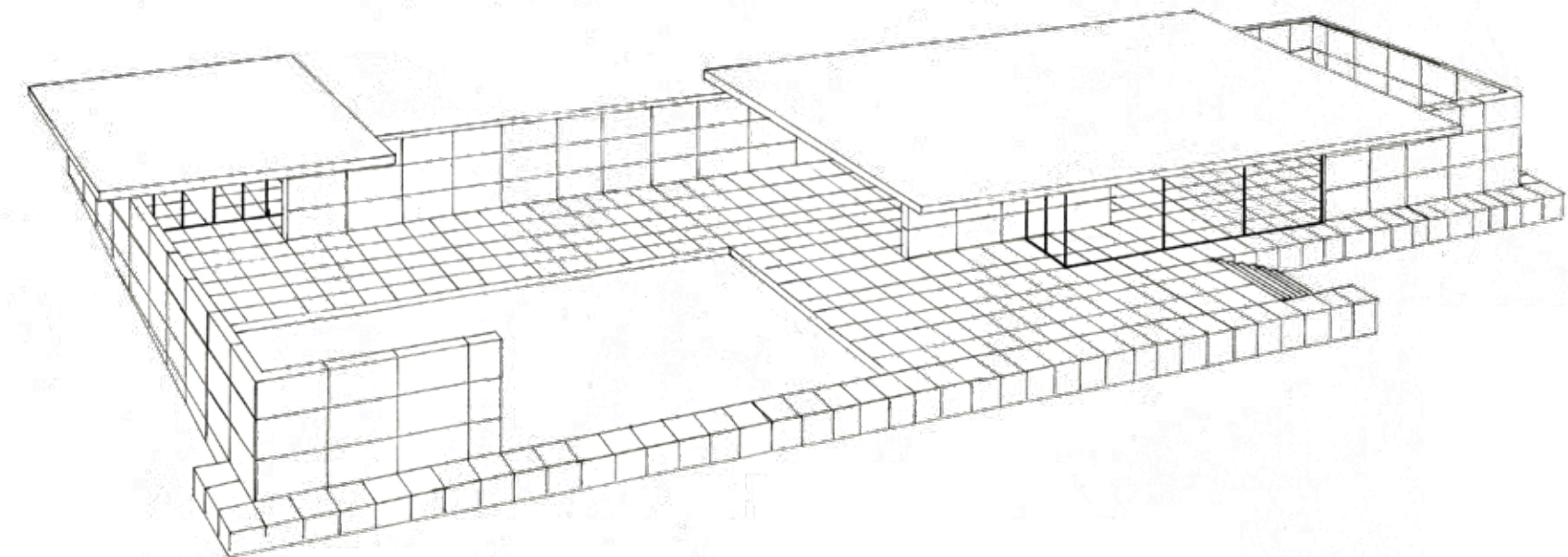
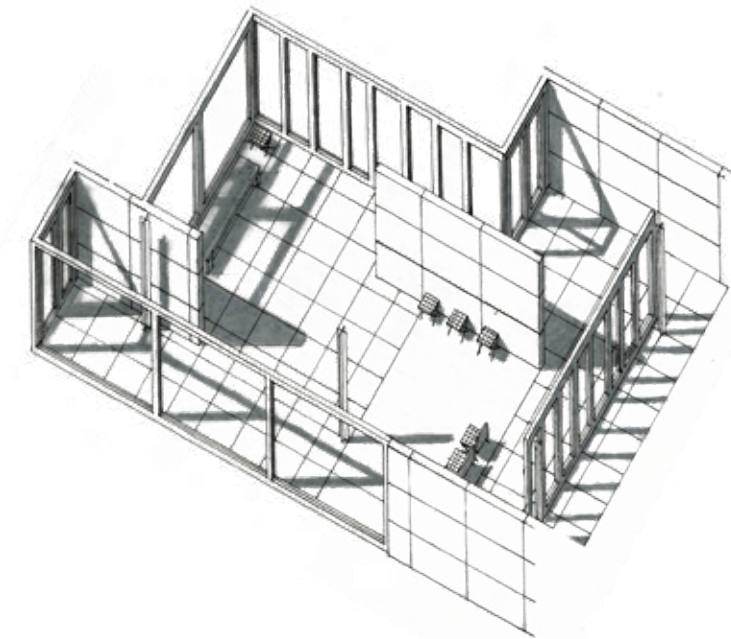

Assemblage

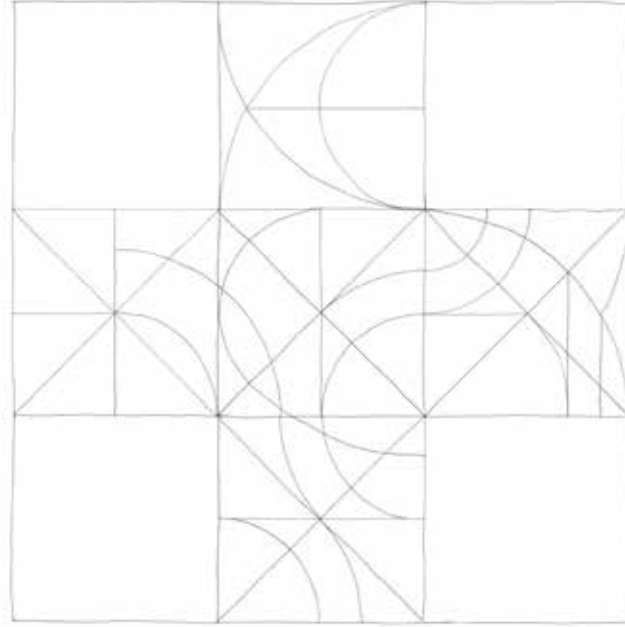

Assemblage: Given a set of rules, draft curves and line segments on one inch squares and assemble five of them onto a three by three grid. All lines must be freehand ink.

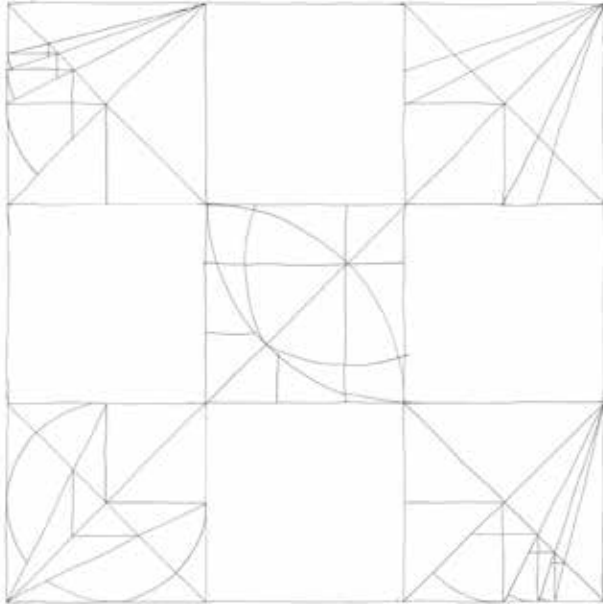

Hierarchy

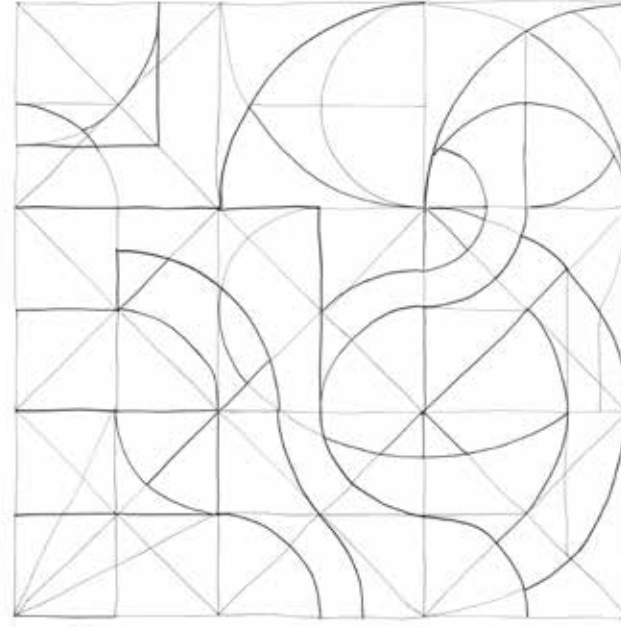

Hierarchy: Using the 3x3 grid and line segment rules as before, add lines to the missing boxes to complete the composition. Then add line weights to create a sense of hierarchy of shapes or pieces in the design.

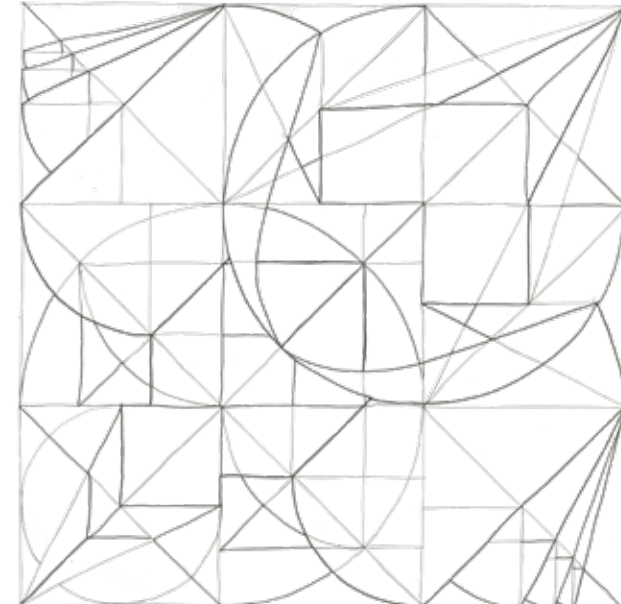

Form

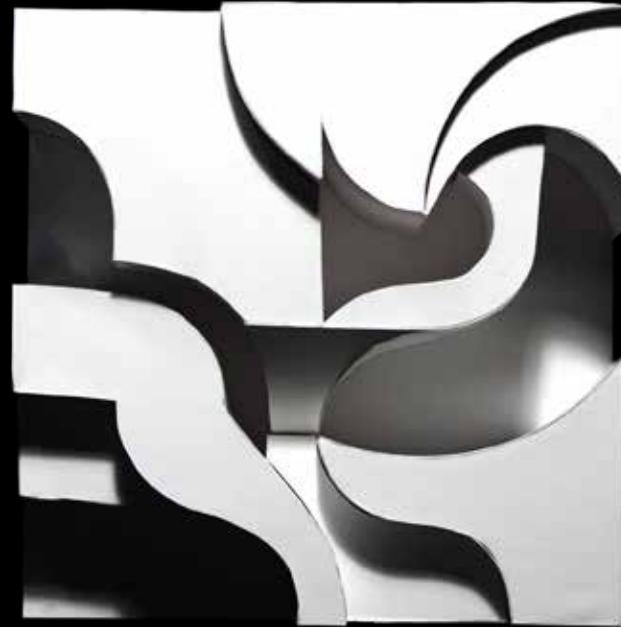

Form: Visualize the hierarchy composition as a three dimensional form. The form should create interesting shadows that reflect the same aspects expressed before using line weights.



Assemblage, Hierarchy, and Form

Course Intro to Architectural Design
Duration 5 weeks Semester Spring 2018
Professor Jane Ostergaard Course # ARCH 1131

Shadow



Shadows: Construct the shadows that would be seen if light were to be exposed at the top of the form, so the height can be demonstrated in drawing by its length.

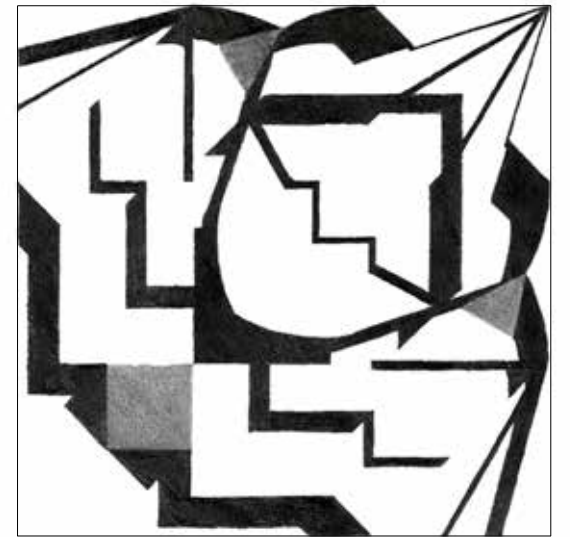

Nature of materials

Course Intro to Architectural Design
Duration 3 weeks Semester Spring 2018
Professor Jane Ostergaard Course # ARCH 1131

Project Description: Given an architect and a building, research the concepts that the architect intended and how they were accomplished. Then, create a sculpture that expresses the concept of the building. The sculpture must use four basic building elements in a way that takes advantage of its abilities: glass, wood, metal, and concrete.

Kimbell Art Museum by Louis Kahn: The concept behind the Kimbell Art Museum was mostly focused on light. Kahn manipulated light in an elegant way by shaping the roof into cycloids with a slit in the top, allowing light through which was reflected, from aluminum sheets, onto the concrete cycloid.

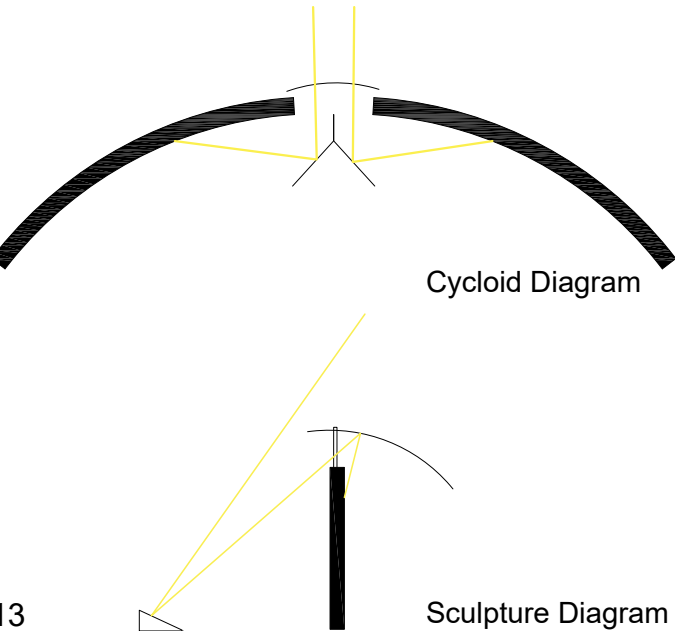

Sculpture Description: The sculpture stands as a wall, made of out of concrete, which blocks light from passing. The wood form around the concrete shows the construction of concrete, as Kahn expresses how the building is built through his design. Then, using reflective aluminum sheets, the light is manipulated onto the concrete wall. The mosaic tiles on the glass demonstrate where the light is being manipulated. Rebar is used for steel for its ability to hold concrete together as well as provide structure to the reflective aluminum.

Kahn also viewed service areas of a building being separated from the public parts of the building, which is why the triangular form that is used to reflect light is entirely separated from the sculpture.

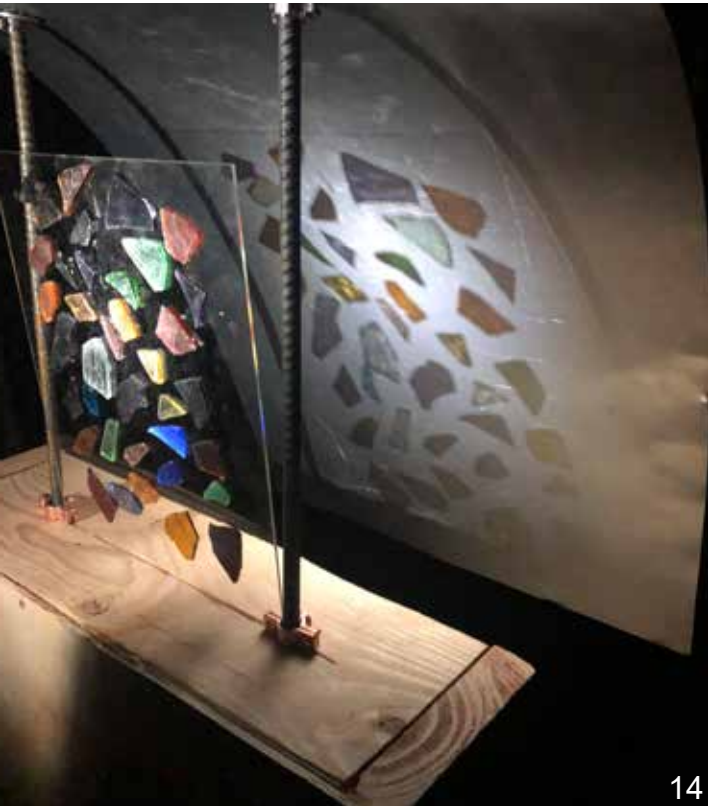

Spatial Sequence

Course Intro to Architectural Design
Duration 3 weeks Semester Spring 2018
Professor Jane Ostergaard Course # ARCH 1131

Project Description: After crafting a kit of parts, design a sequence of three spaces in a park. This design is limited by the kit of parts. Each space will be designed to represent a specific season; spring summer and fall.

Concept: Spaces that provide a sanctuary against the elements of nature. Seasons spring and fall tend to be cold and windy while summer tends to be hot and humid. Spring and fall are elevated to absorb the sunlight and escape the cold. Summer is placed below grade to cool the space. Spring and fall provide protection from the cold and strong wind from the west and direct that wind towards summer. Summer is designed to collect wind from the west to provide a cool breeze during the hot summer.

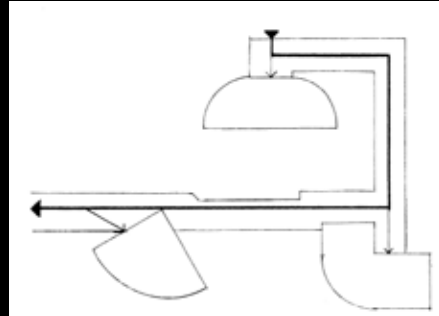
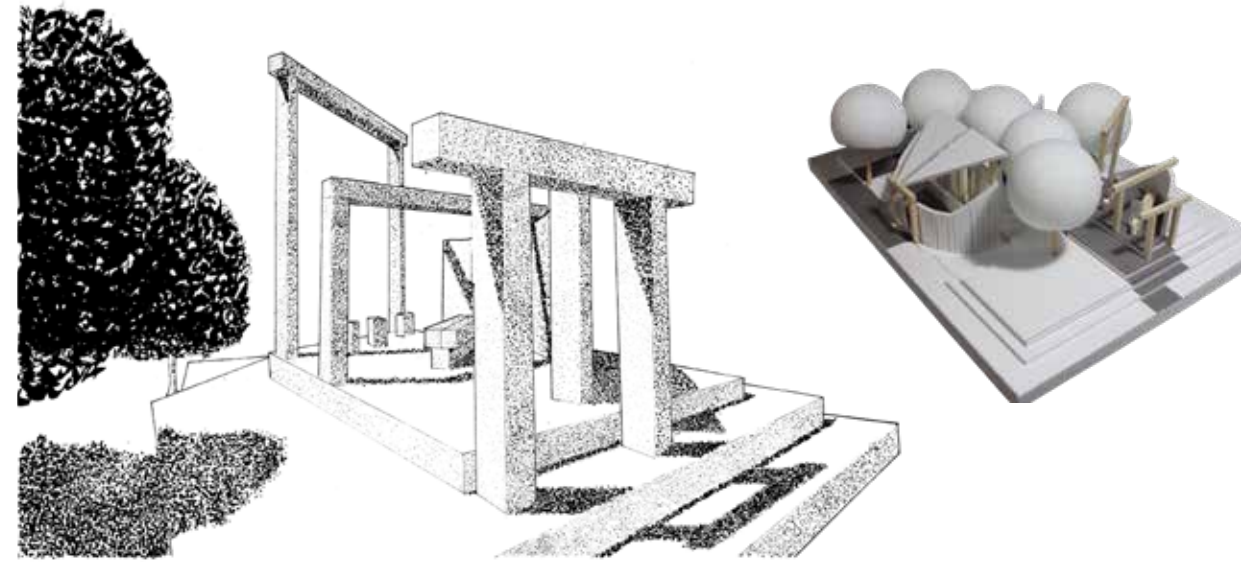
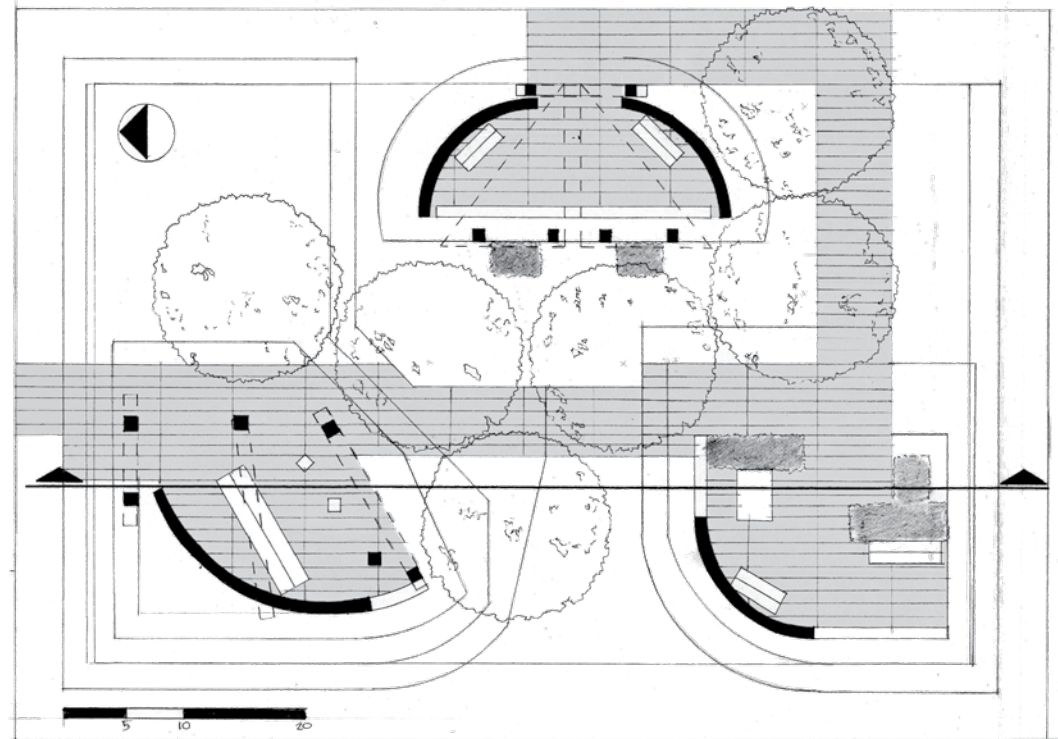
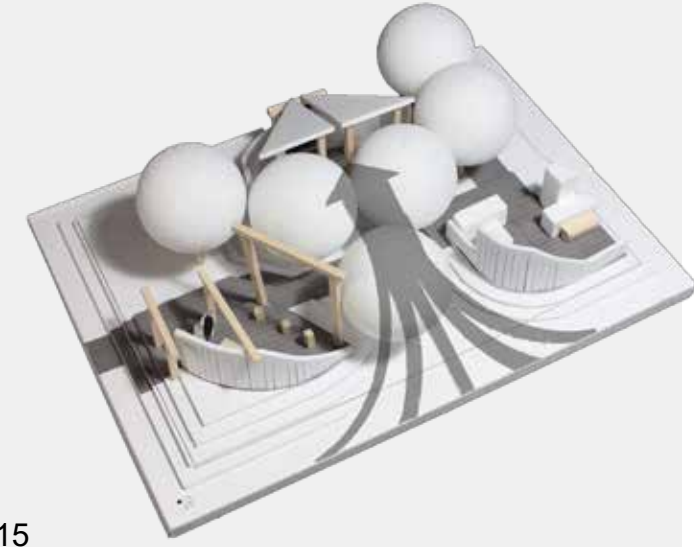

Circulation

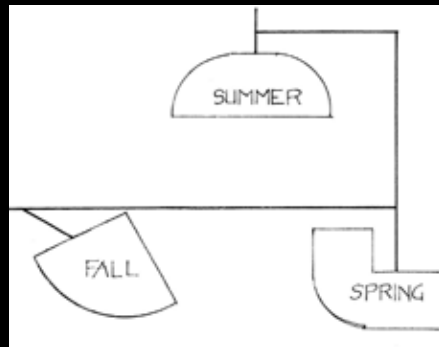

Organization

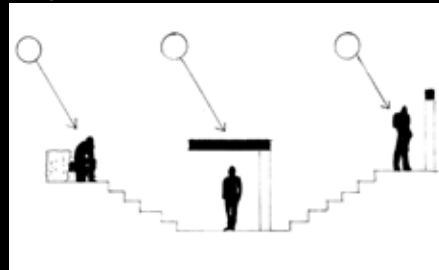

Shadow

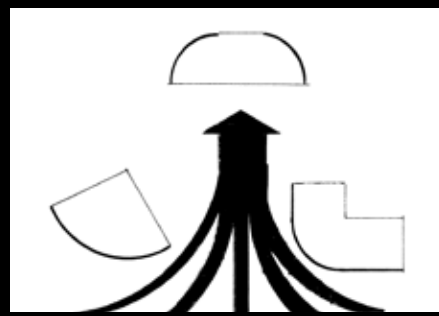

Concept

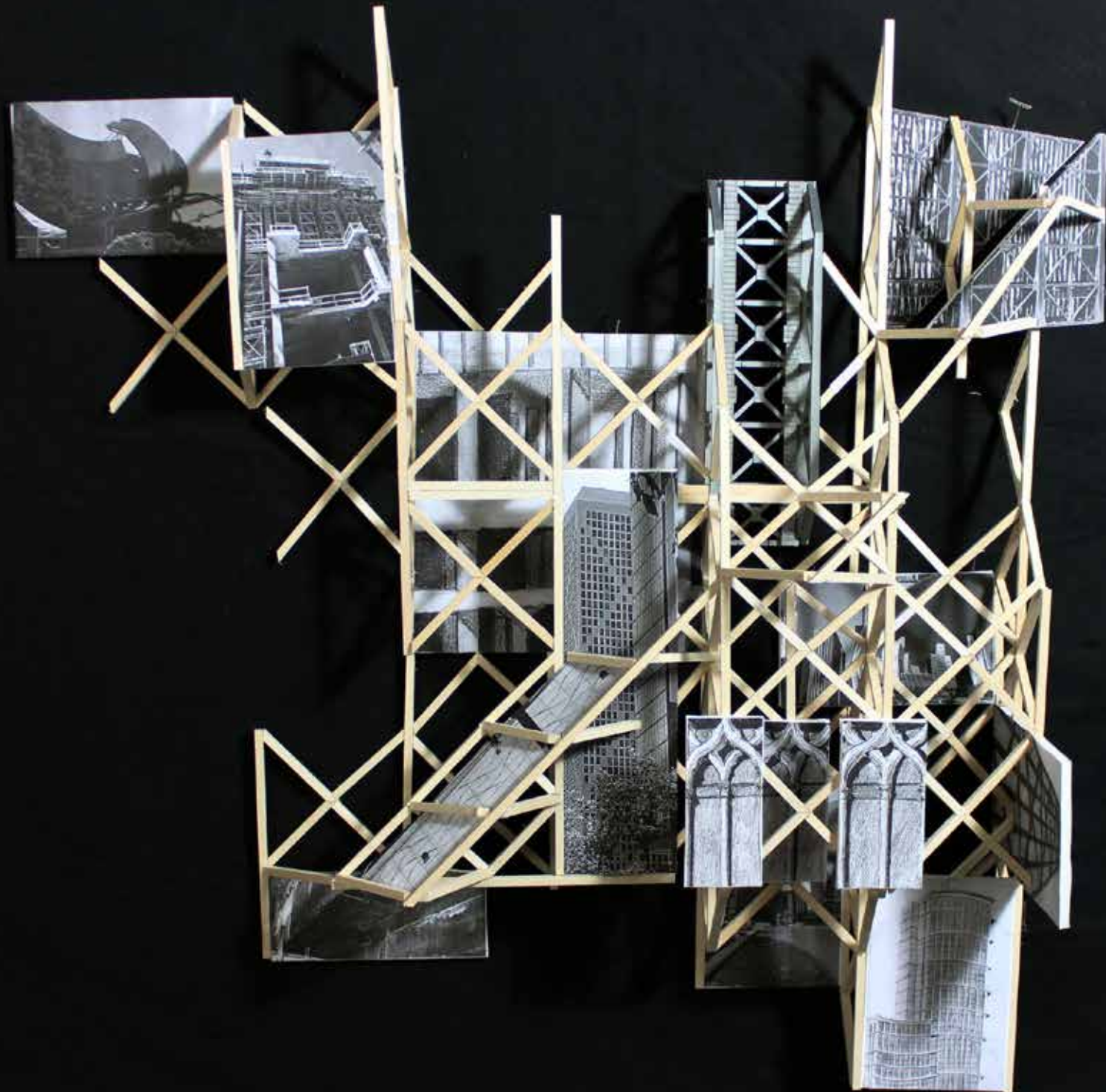

Inspirations Collage

Course Architectural Design I
 Duration 2 weeks Semester Fall 2018
 Professor Mark Pearson Course # ARCH 2201

Project Description: After travelling through the city of Chicago, design a sculpture that captivates the ideas of the city. Incorporate sketches and pictures throughout the design.

Concept: The sculpture creates multiple layers using a truss-like form, embracing the structure of the city while showing pictures on many different layers of the composition. The city is made up of many layers; street, sidewalk, building, underground passage ways. The intent of the design was to reflect these layers as well as the structure of the city through trusses. The composition is also meant to be unfinished and reaching outwards, just as a city continues to grow and expand.

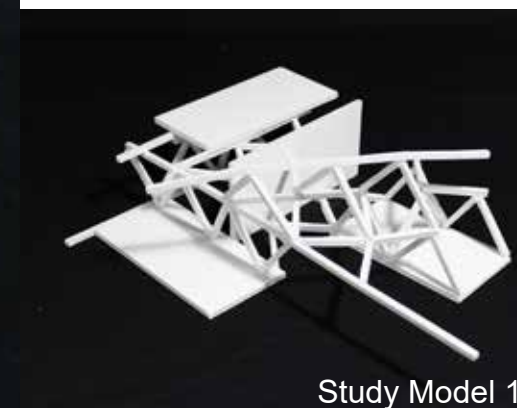
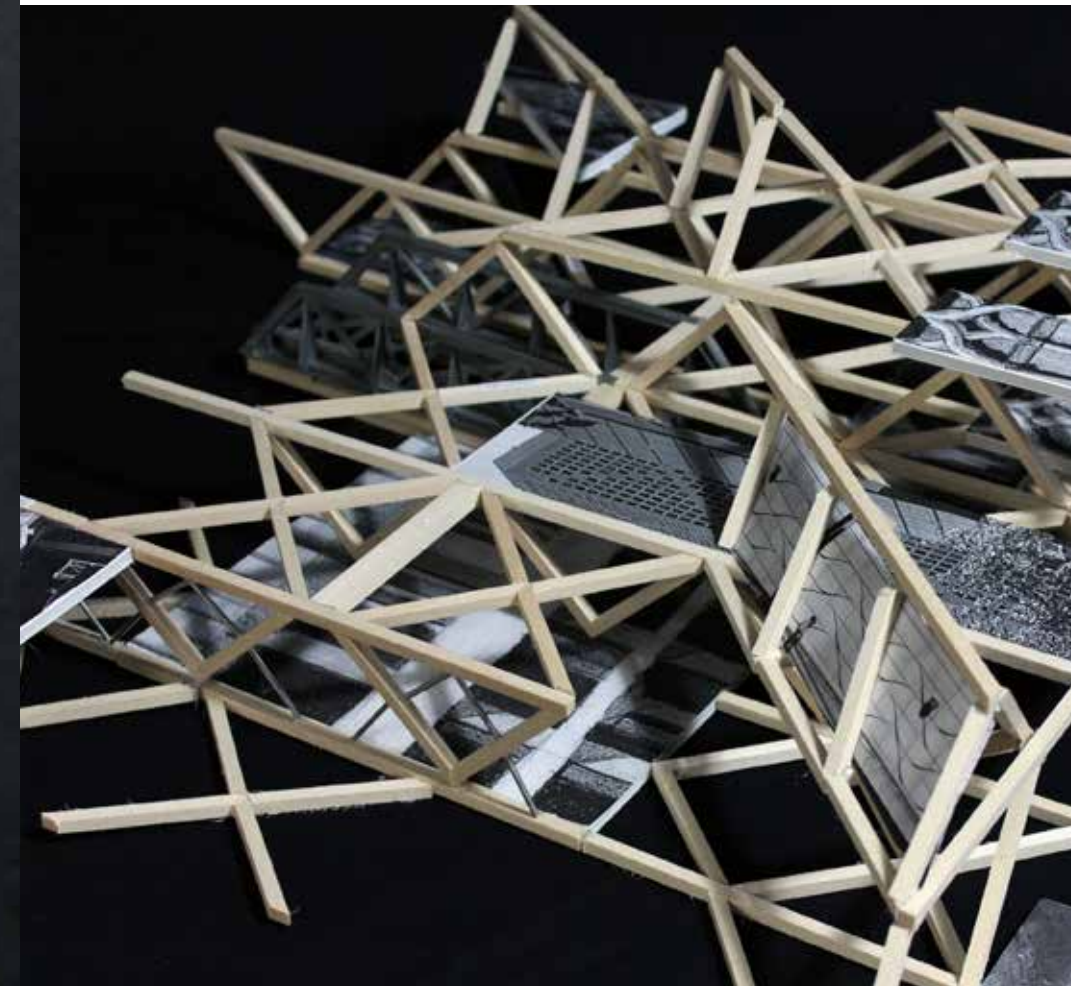

Study Model 1

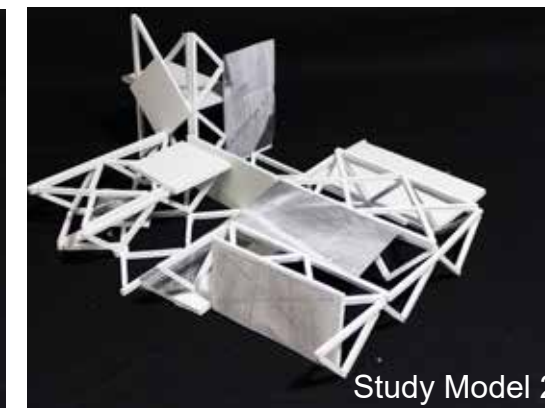

Study Model 2

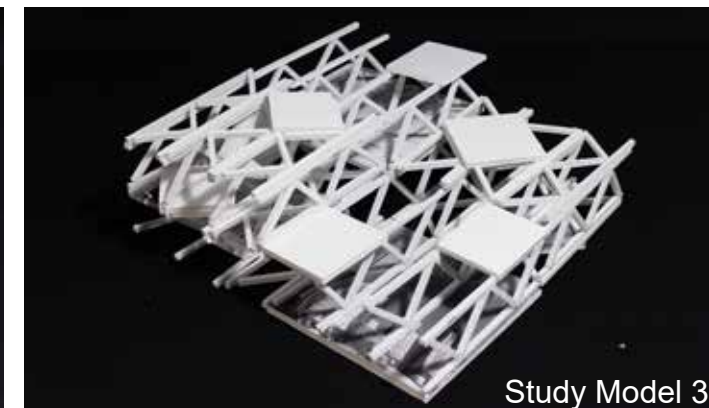

Study Model 3

Precedent Study

Course Architectural Design I
Duration 1 week Semester Fall 2018
Professor Mark Pearson Course # ARCH 2201
Group Jon Guttello, Jorge Saenz

Project Description: Sketch perspectives and diagram the concepts presented by Marlon Blackwell in the Ruth Lilly Pavilion. Marlon Blackwell described his inspiration for the building from a crumpled leaf. The pavilion lies in a forest and the shadows created by the roof form are representative as the shadows created by the forest; branches equivalent to beams casting larger, darker, shadows and thin strips of wood equivalent to leaves casting an ambient shadow.

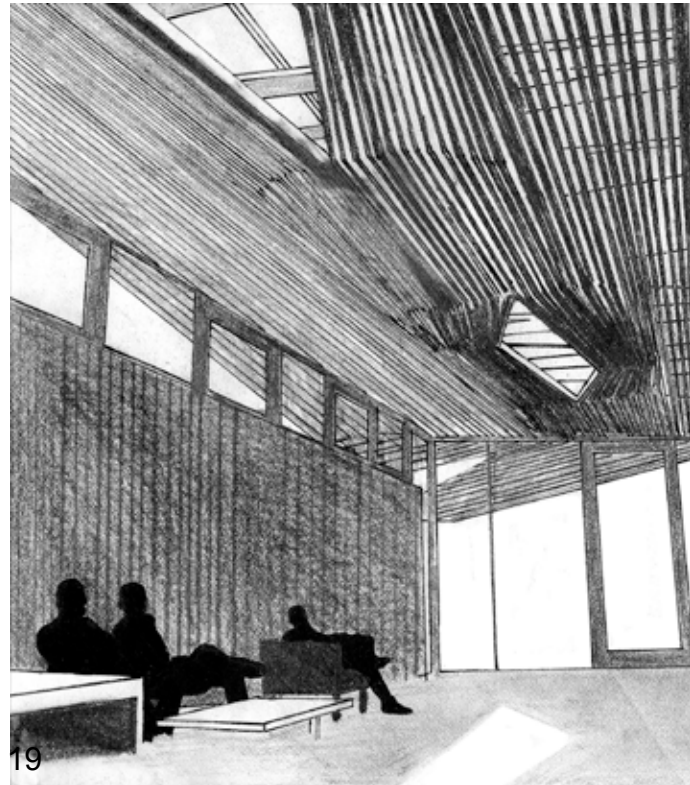

19

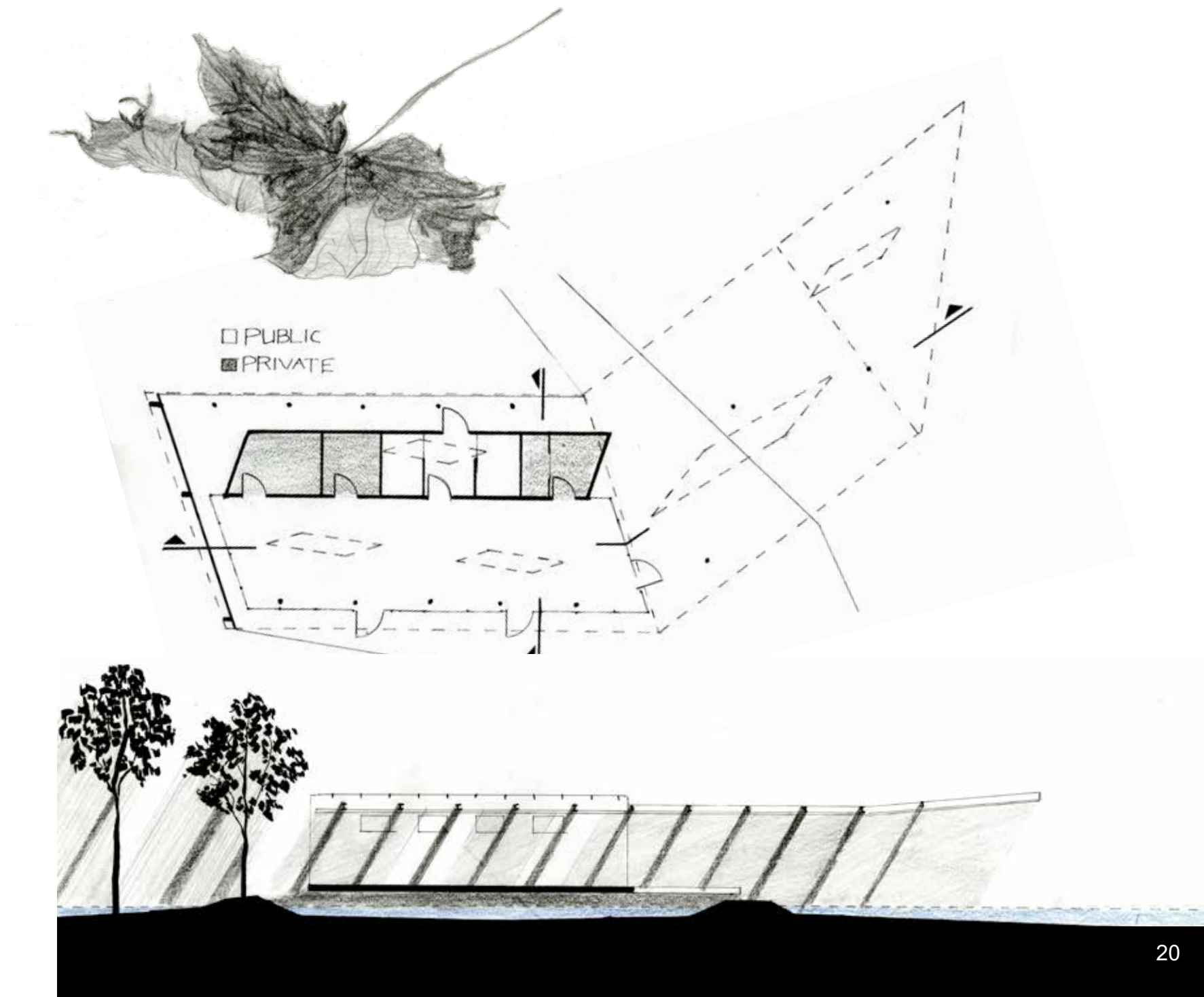
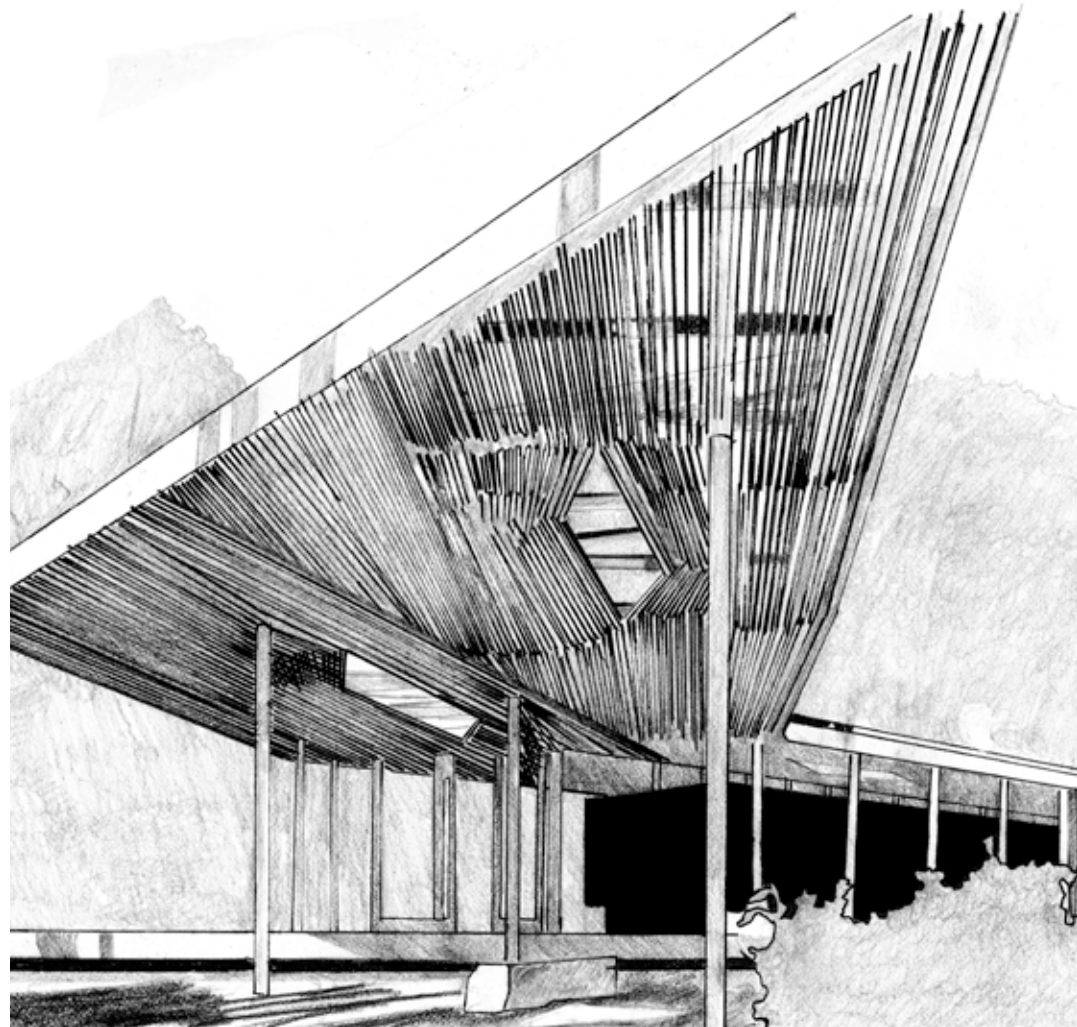

20



Ecology Center

Course Architectural Design I
Duration 12 weeks Semester Fall 2018
Professor Mark Pearson Course # ARCH 2201

Project Description: Design an ecology center in Chicago that focuses on water along the lakefront of Lake Michigan. The site is located on the south of Lincoln Park. The building must have the following spaces; a cafe, exhibit space, two classrooms, an interactive lab, offices and a conference room.

Concept: A ramp that spans through the site, dividing the site, and creating a roof terrace.

The ramp created the concept of steps through terraced seating that is expressed in multiple ways throughout the building and the site.

The building footprint with the ramp creates an L shape that is used to frame the public space around the lake.

The roof forms represent waves crashing on the shore while also expressing the concept of steps.





Ramp Process: Initially in the 1:30 scale models, a ramp that spanned the entire site was introduced into the project. Eventually terraced seating was developed from the ramp and created the concept of steps throughout the design

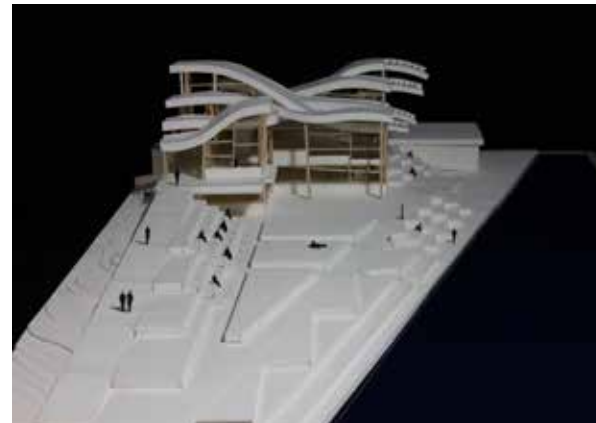

Roof Process: The roof of the ecology center started out as a stepped pattern, mimicking the pattern of the terraced seating (opposite). Through further development, the stepped pattern was still used as the roof transitions into a stepped curve. The stepped curve had the aesthetic of a wave crashing on the shore.



Concept Diagram

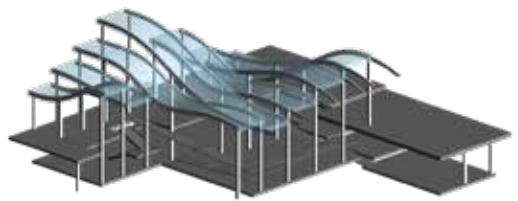

Structure Diagram

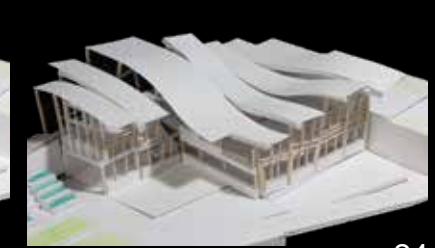
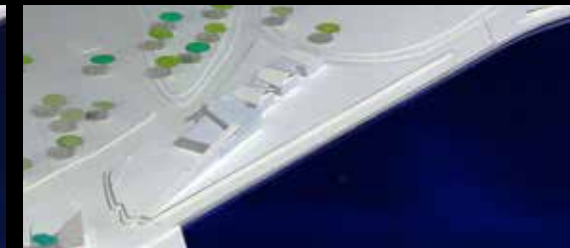

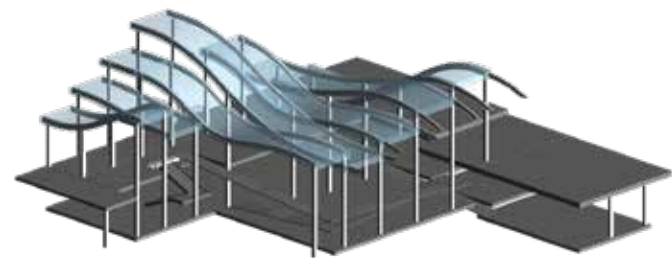
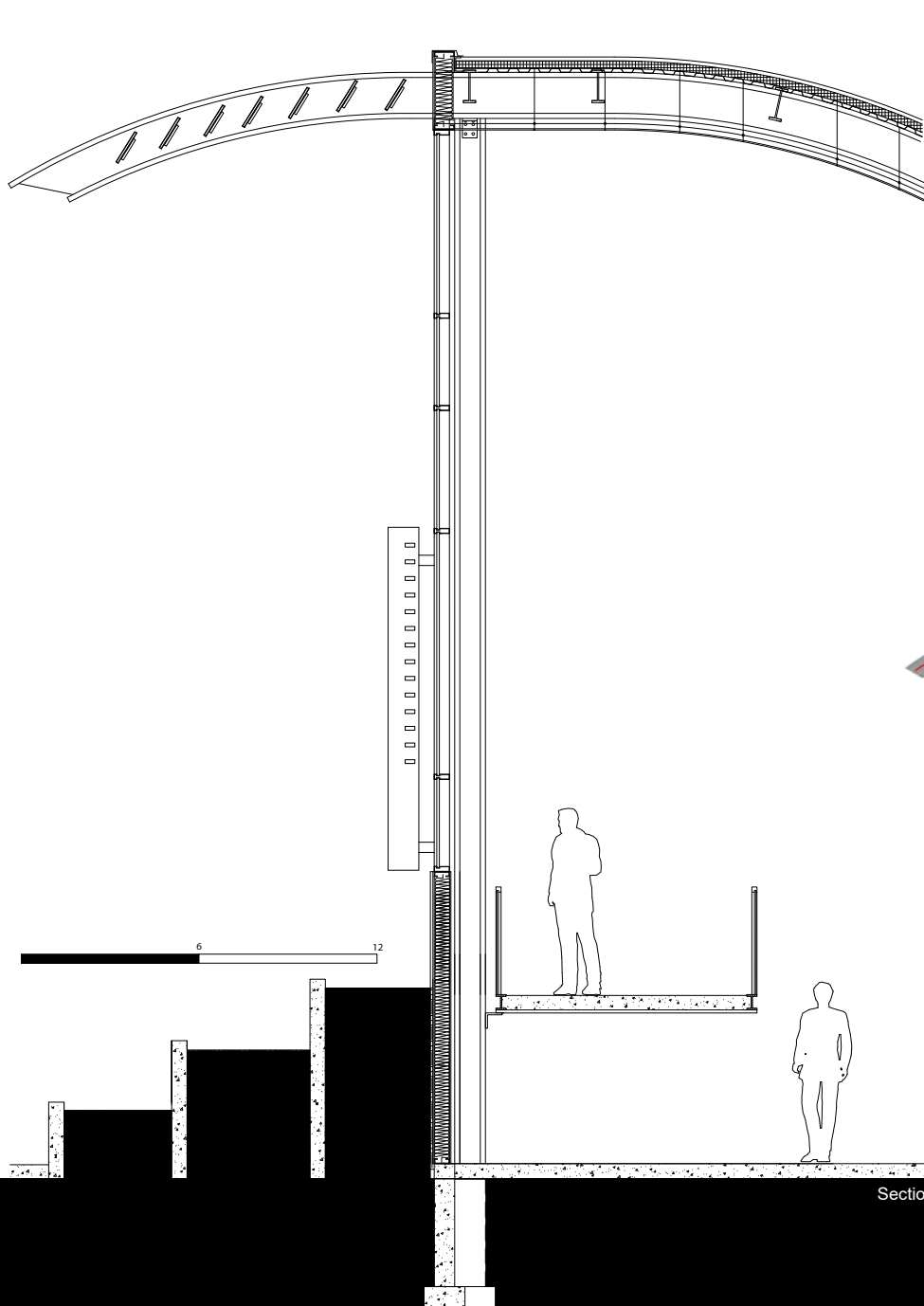

Structure

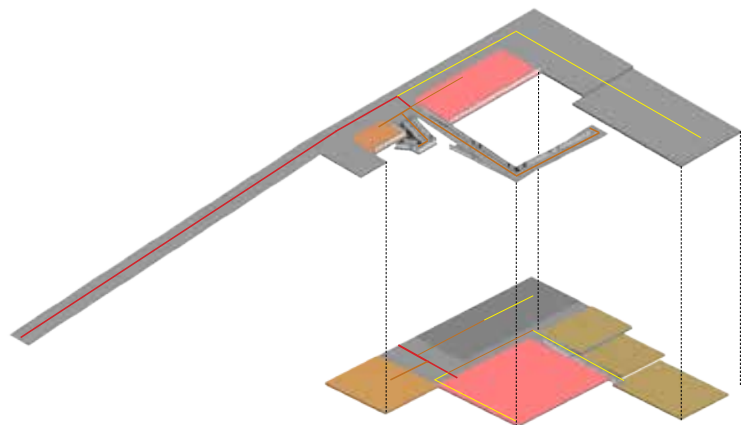

Circulation

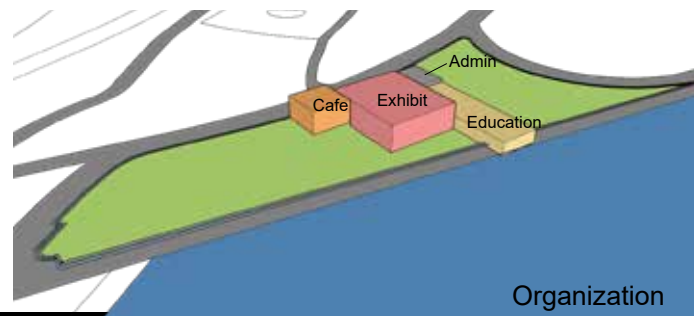

Organization

Section C

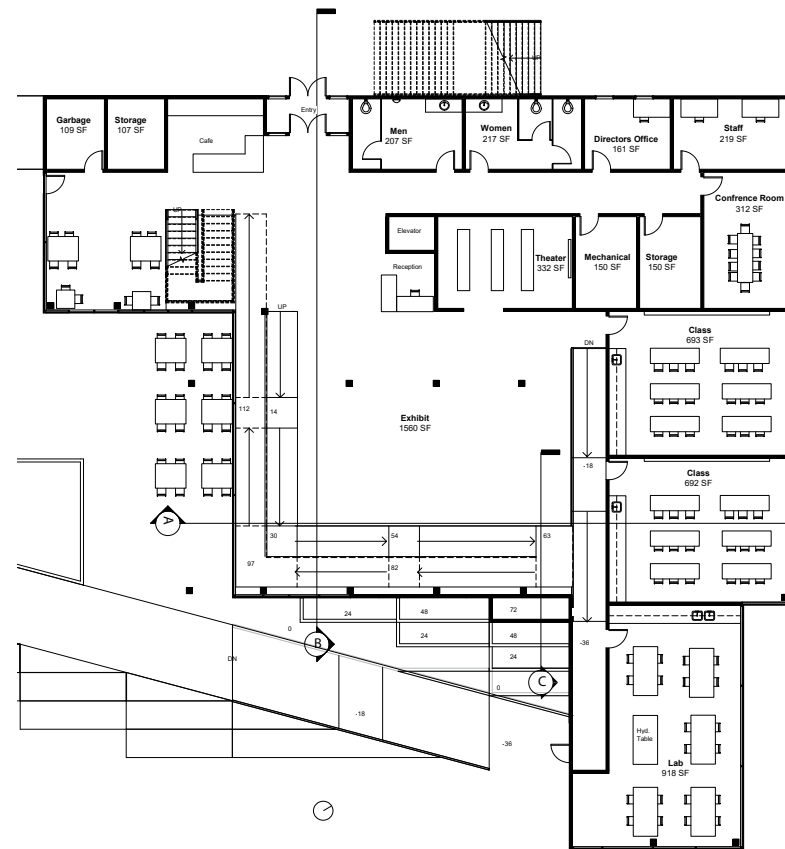

First Floor

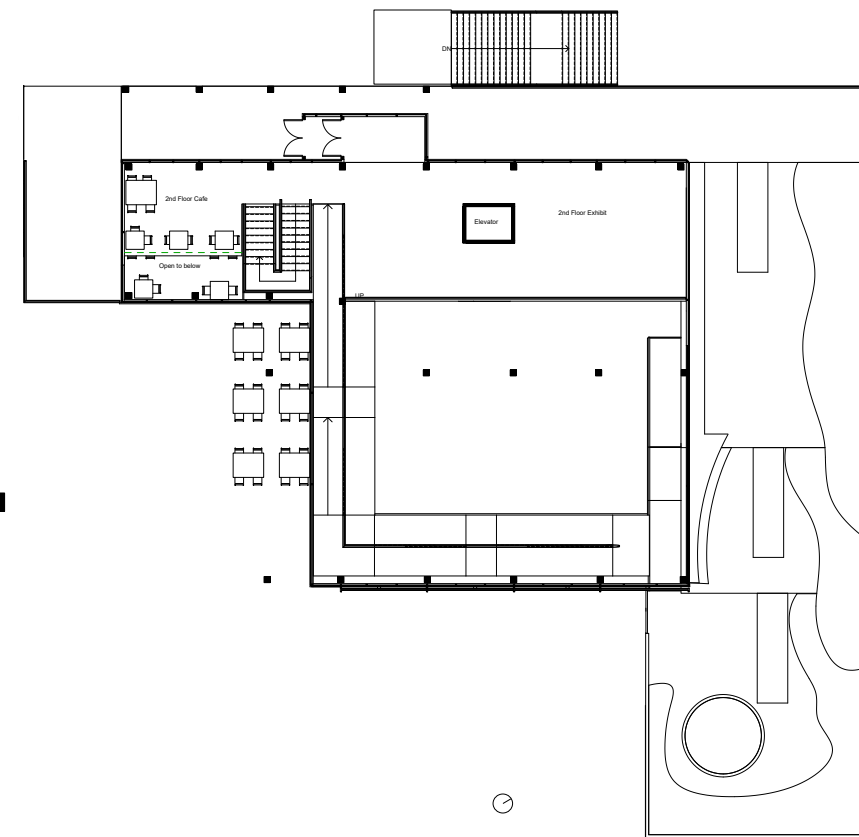

Second Floor

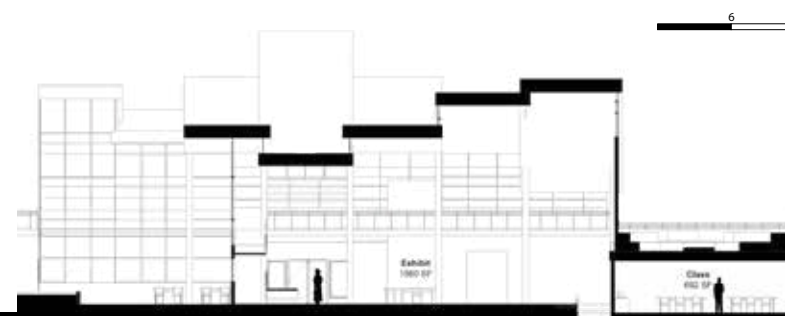

Section A

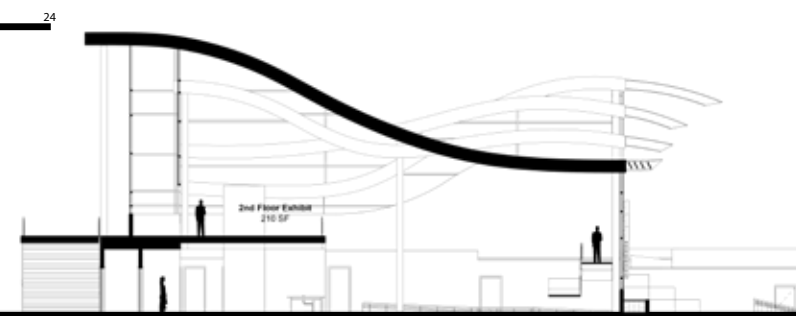

Section B

Light Wall

Course Architectural Design II
Duration 2 weeks Semester Spring 2019
Professor Mark Pearson Course # ARCH 2202
Group William Manzanilla, Joseph Hazel, Alberto Ayalla, Jon Guttello

Project Description: Create a light modulating wall that creates a mood, or atmosphere, within the room that changes depending on season or time of day utilizing only the sun. The wall is to be located within the Chicagoland region and the wall must be facing south.

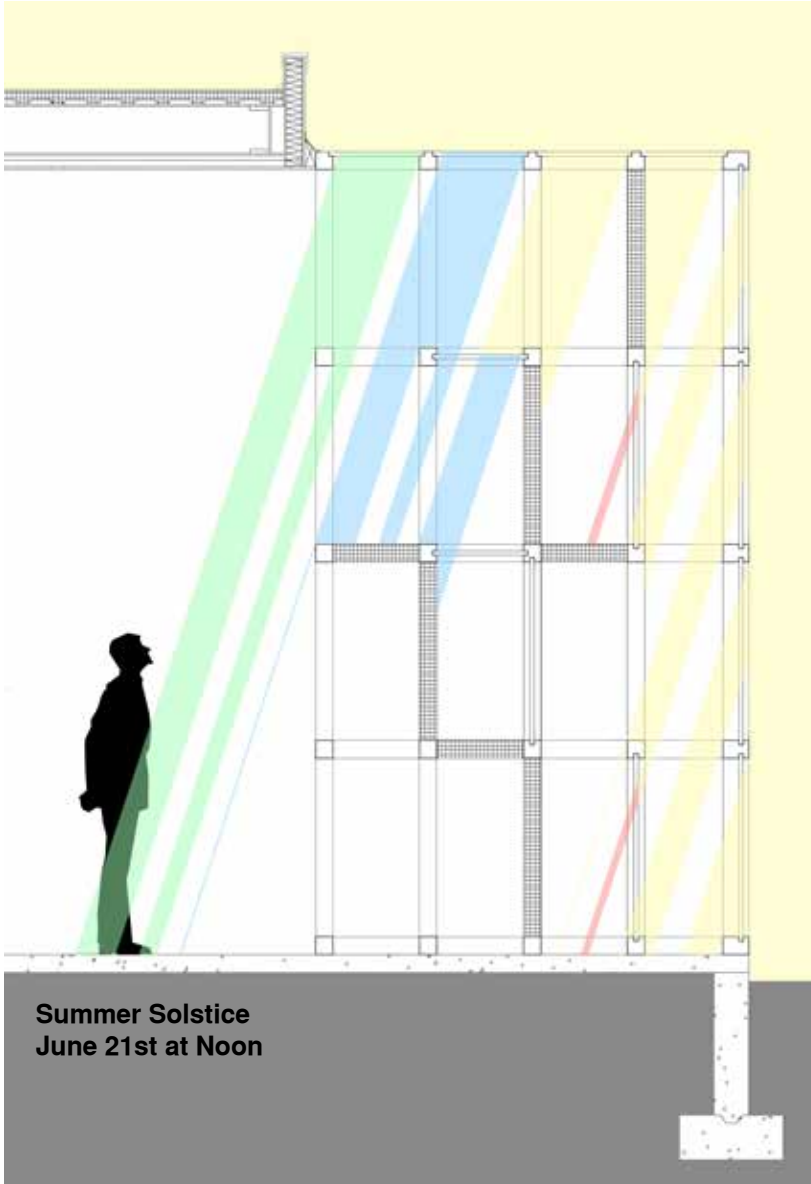
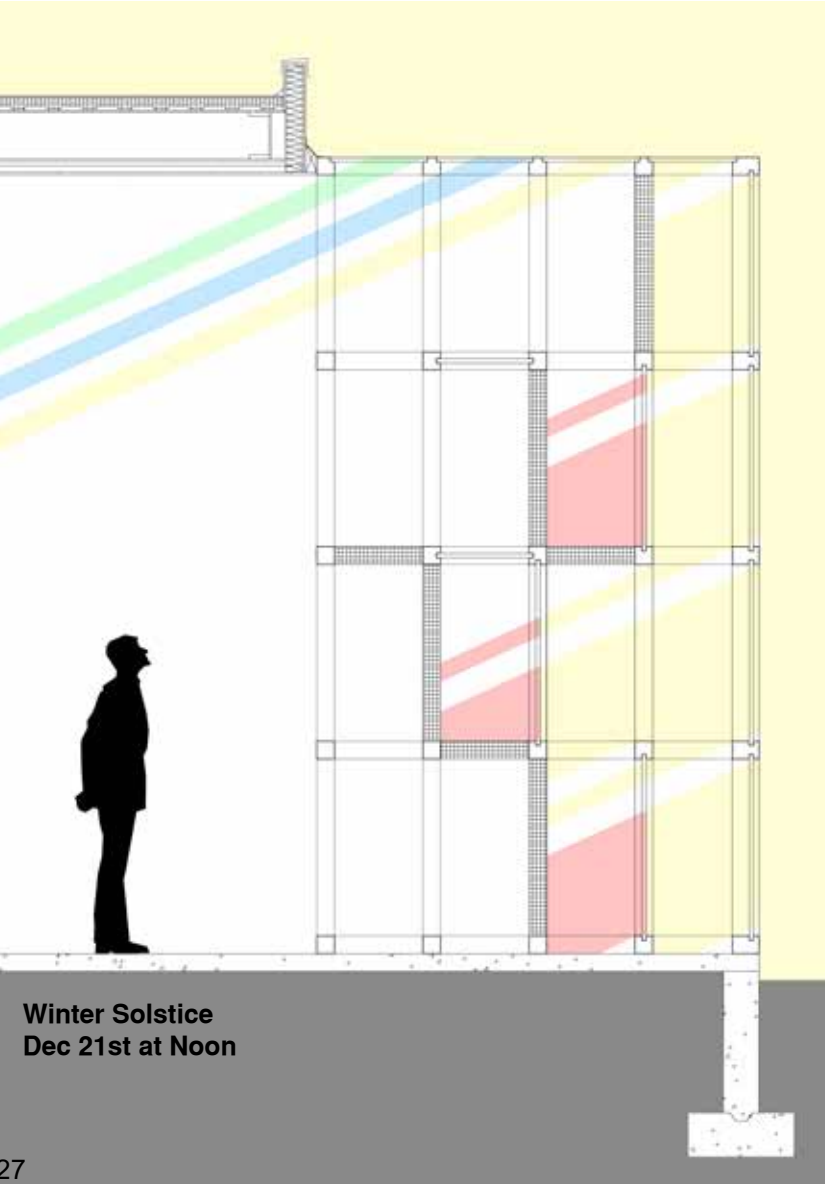

Concept: A light modulating wall that changes atmospheres to accomodate the viewer to feel more comfortable according to the season. During summer, the wall fills the room with cool colors such as green and blue to counter the heat. During winter, the wall is filled with warmer colors such as orange and red to counter the cold. These different scenerios are most effective on the winter and summer solstice at noon. The wall also utilizes a neutral color of yellow to help display the time of day to the viewer, which slowly disappears at noon and grows as the sun sets.

Rendered Winter Solar Study:

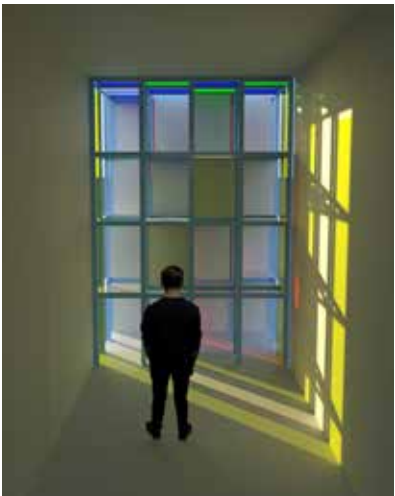

8 AM



10 AM



NOON



4 PM

Rendered Summer Solar Study:



6 AM



11 AM



1 PM



5 PM

Light Wall Process

Course Architectural Design I
Duration 2 weeks Semester Spring 2018
Professor Mark Pearson Course # ARCH 2202

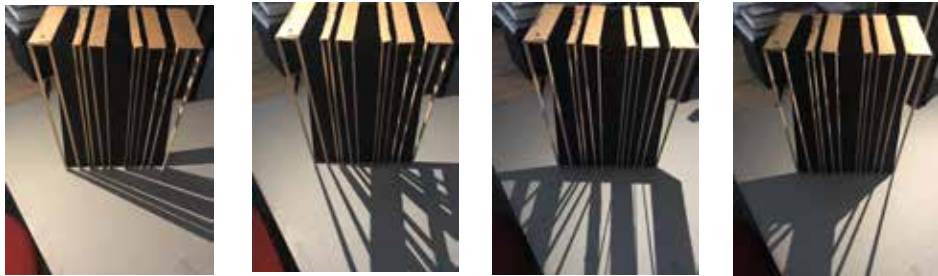

Shadow: Shadows changed depending on what objects were placed where, and this changed drastically depending on the time of day



Color: Different moods were realized when combining different colors. Red and orange created a warmer environment, and blue and green created cooler environments

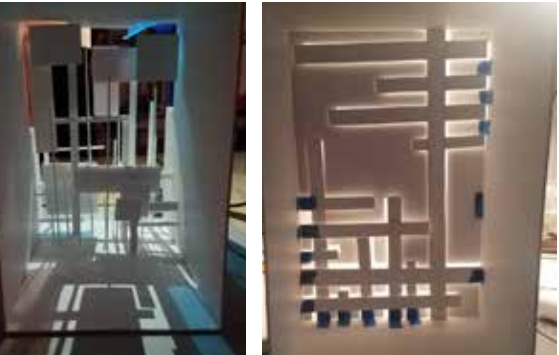

Summer

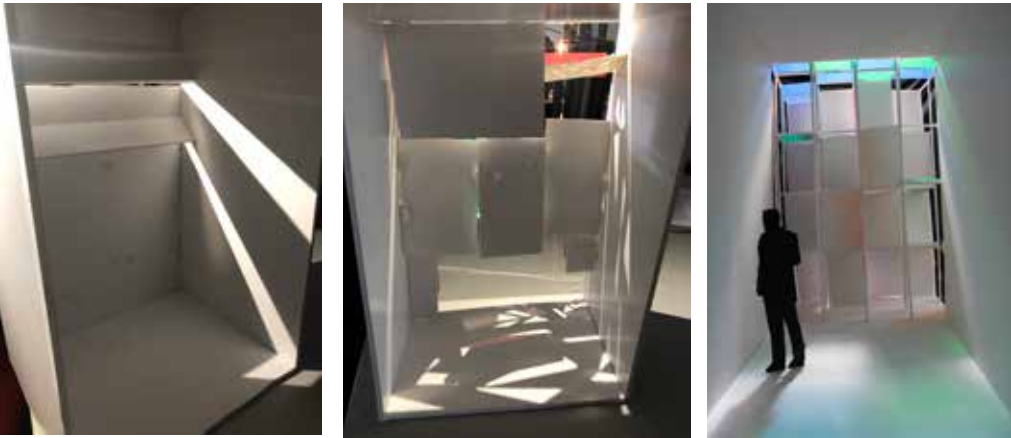

Winter



Study 1

Study 2

Study 3

Form: Overlapping linear elements to create shadows and a sense of depth of space

Season: Light can be manipulated into different effects depending on the season. During the summer the sun could display a pattern that could not be seen on the walls. The winter sun provided a glowing effect to the room



Winter Solstice
Dec 21st at Noon



Summer Solstice
June 21st at Noon

Gridlock: Introduction

Course Architectural Design II
Duration 12 weeks Semester Spring 2019
Professor Mark Pearson Course # ARCH 2201

Project Description: Design an urban infill space in Near North Chicago, at the intersection of Franklin and Chicago. The urban infill space combines a residential unit as well as gallery space for specific art choices. The art choices consist of a sculpture, painting, and an artifact.

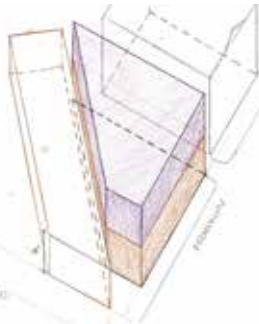

Aerial Photograph

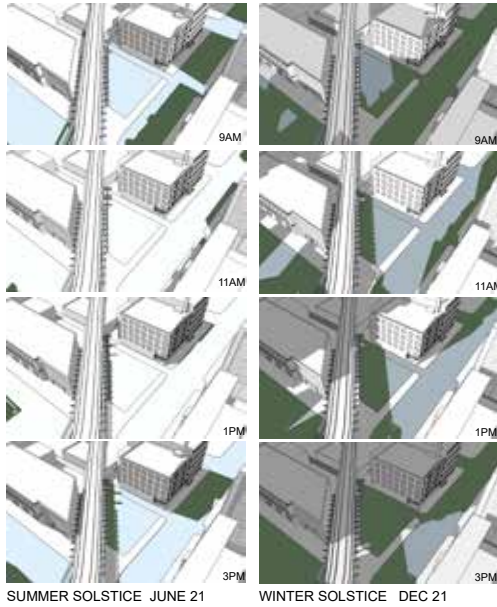

Initial Site Sketch



Gridlock: Process

Course Architectural Design II
Duration 12 weeks Semester Spring 2019
Professor Mark Pearson Course # ARCH 2201



City Landscape
By: Joan Mitchell
Abstraction of the city

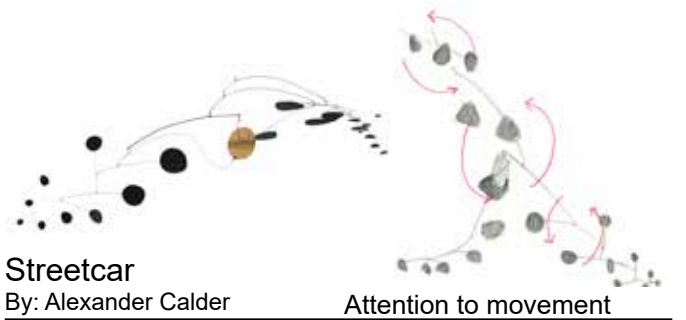

Streetcar
By: Alexander Calder
Attention to movement



Burden Basket
By: Puomo Native American Tribe
Art, simultaneous with use

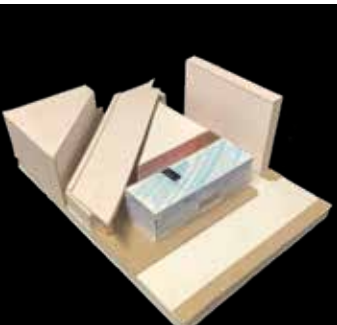

Public vs. Private



Abstraction of the City



Movement



Transitional Space



City Landscape: An abstraction of the city
The site is rotated so the blocks that make up the building are viewed as an abstract city. The City Landscape painting is placed to view many different aspects of the city, which is the concept of the painting.



Streetcar: a slow moving sculpture.
The sculpture is placed to be viewed from various parts of the building, as well as the viewers of the streetcar can witness the movement of the city around them, through the traffic, the EL as well as the circulation in the building.

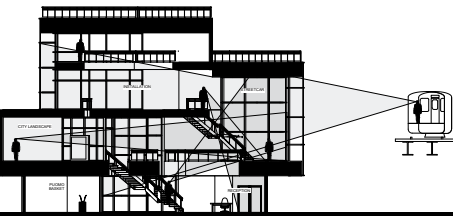

Burden Basket: decorative art used everyday.
Every aspect of the facade serves a function to the building. The green wall is used to lower pollution rates and minimize the carbon footprint, the double skin facade is used for insulation. Sun shaders are used to block the sun.



Gridlock: Renderings

Course Architectural Design II
Duration 12 weeks Semester Spring 2019
Professor Mark Pearson Course # ARCH 2201



Rendering 1
35



Rendering 4

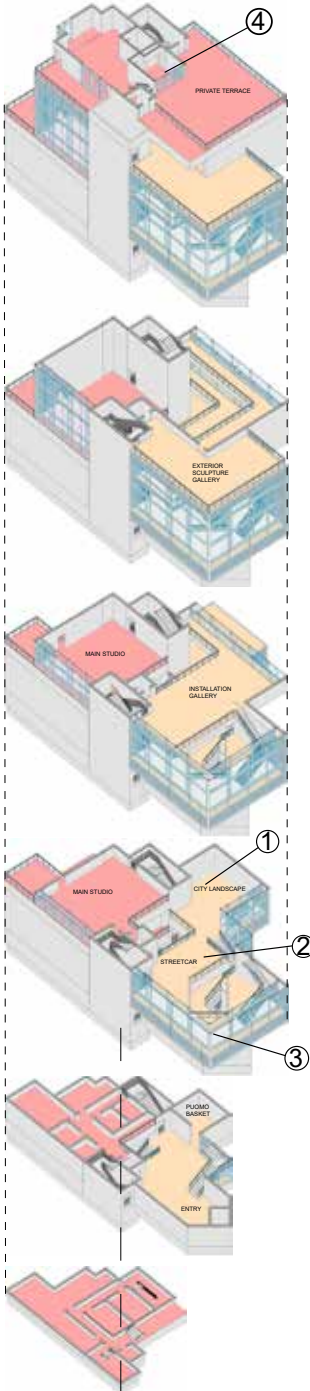

Organization

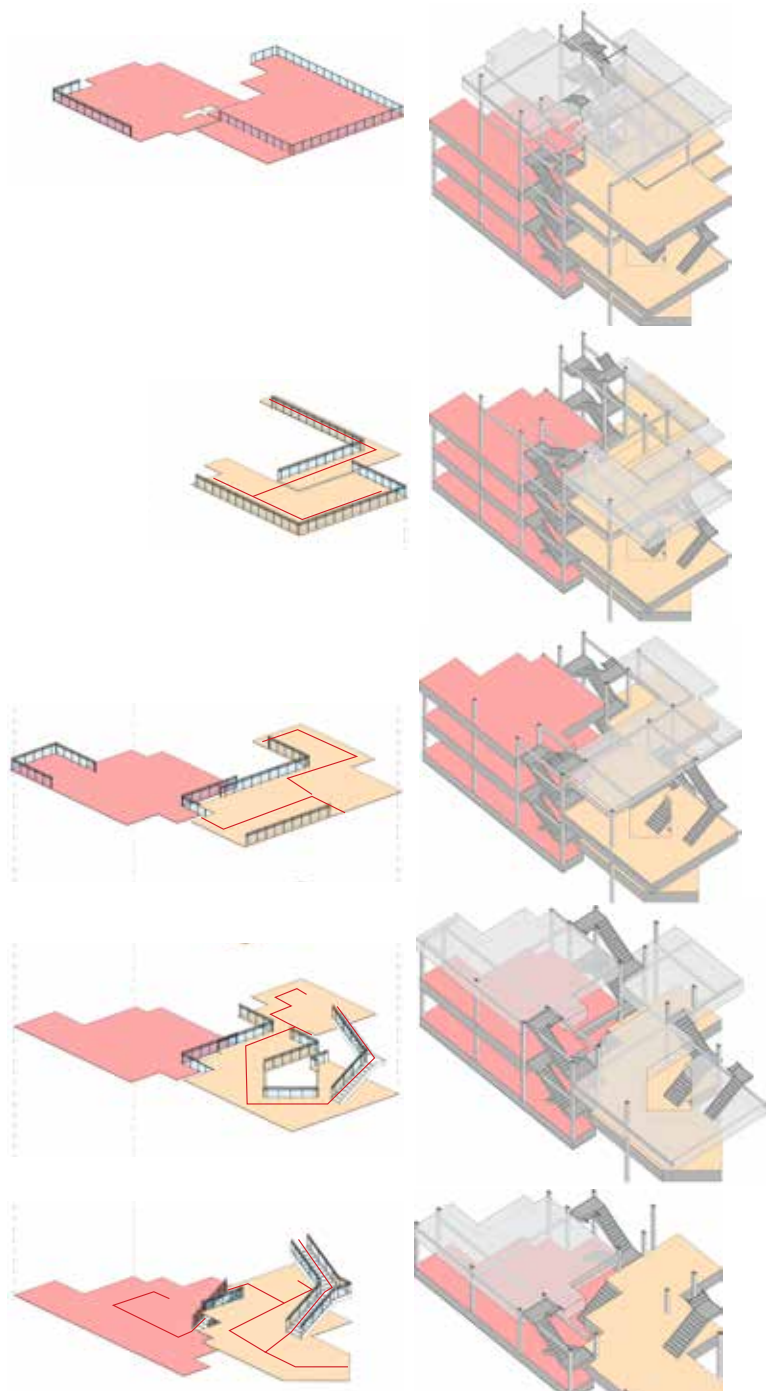

Circulation

Structure



Rendering 2



Rendering 3

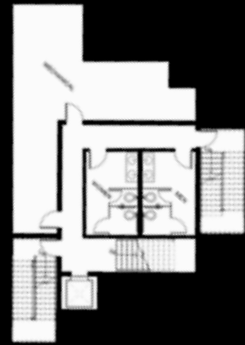

L0



North Arrow



6' 12' 24' 48'

Graphic Scale

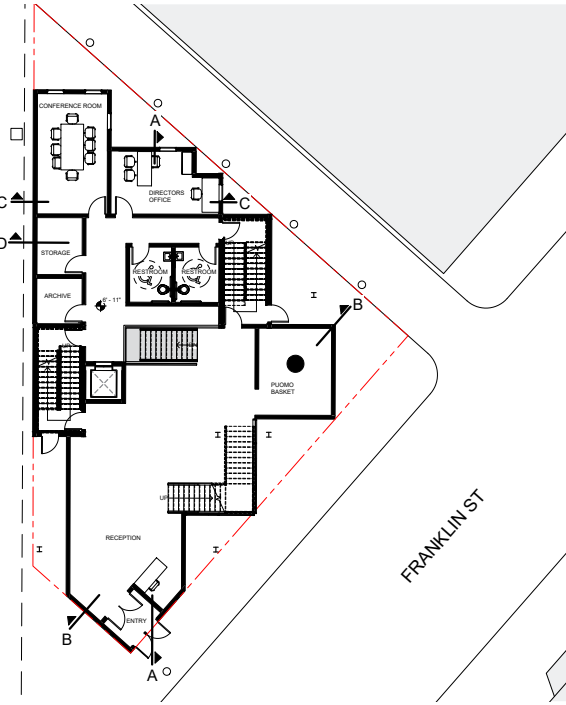

L1

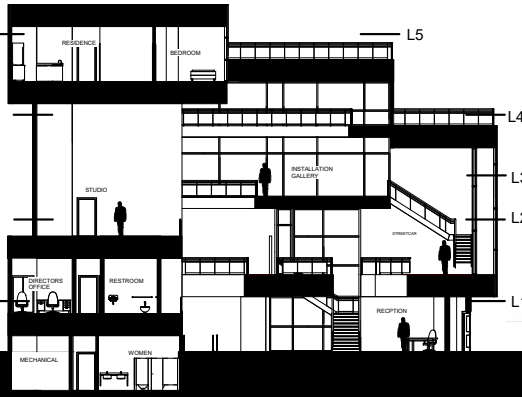

Section A



Section D
NOT TO SCALE



L2

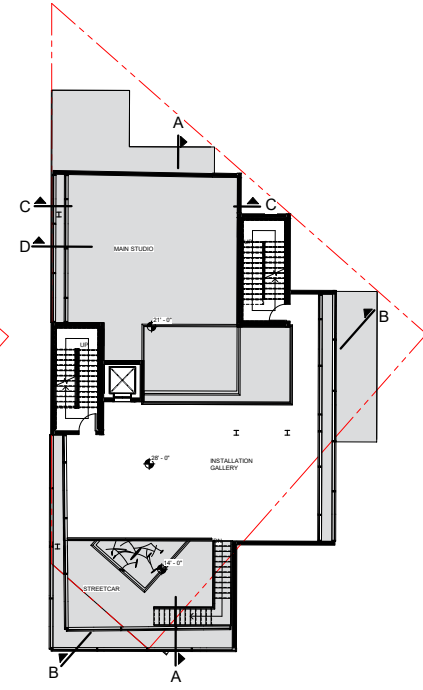

L3



L4



L5



Section B



Section C

Structural Stability

Course Structural Systems
Duration 3 weeks Semester Fall 2018
Professor Jane Ostergaard Course # ARCH 2230
Group William Manzanilla, Santiago Espinosa,
Vassiliki Demakis, Jon Guttello

Project Description: Design a structure to support three group members and can contain the armspan and reach of the shortest group member. No nuts, bolts, or nails are allowed unless a cable is used; in which case turnbuckles are allowed. The structure must have four or less points of contact with the ground.

